



## Mount View Road, N4

### £350,000

A well-presented one bedroom flat in Granville Court, Mount View Road. A purpose-built early 20th-century residential block. The property features a bright living area, wooden flooring throughout, and great city views.

Mount View Road borders Crouch End with easy access to an array of shops and Ofsted 'outstanding' St. Aiden's primary school. The popular Stroud Green Road and Crouch Hill Station are also within easy walking distance.

### Features

- One Bedroom Flat
- Wooden Flooring
- Fantastic Views
- Separate Kitchen
- Share of Freehold
- Purpose Built Block

# Mount View Road, London, N4

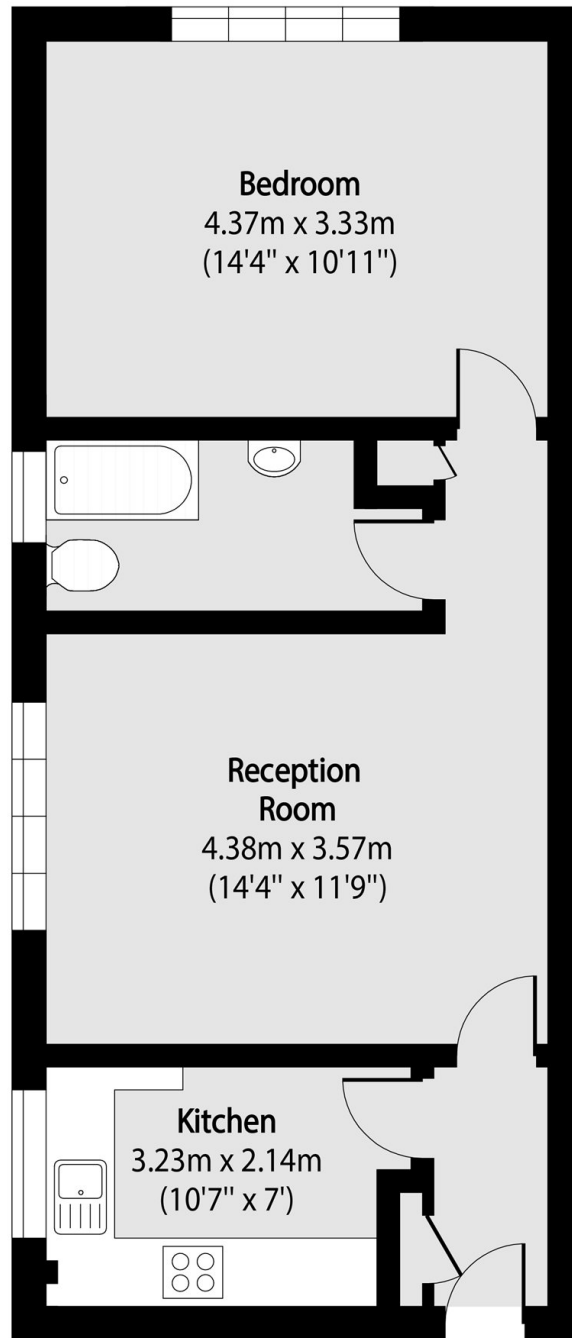

Total area (approx): 48.84 sq m (526 sq. ft)