

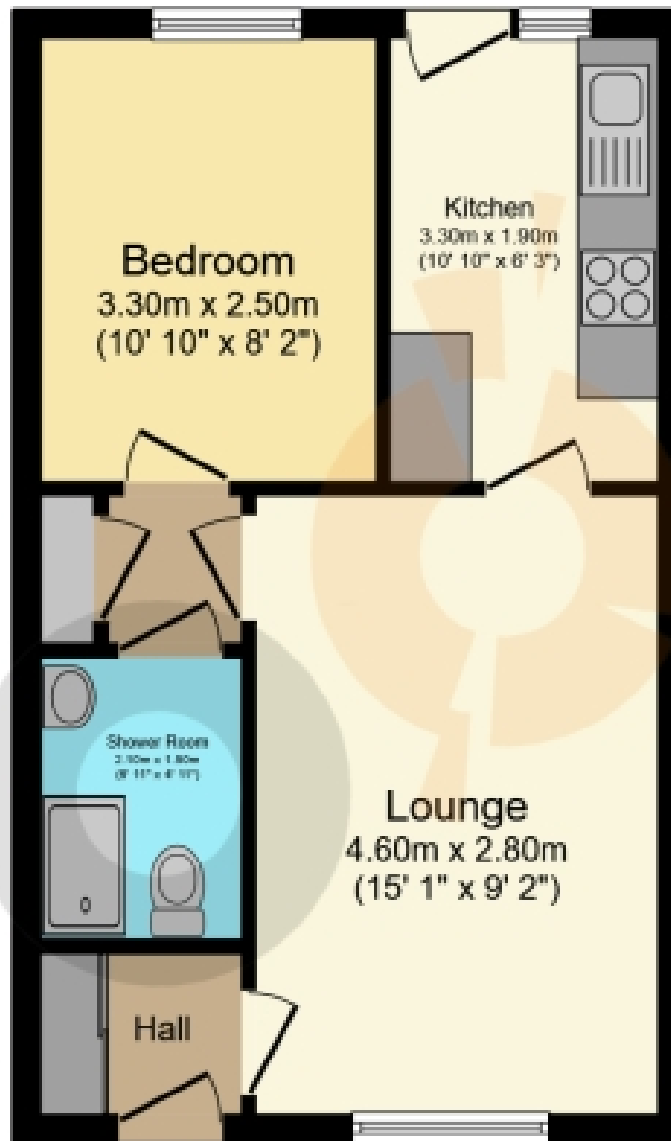

**Bullwood Court, Glasgow**

**Offers Over £110,000**





Floor Plan

Total floor area: 36.8 sq.m. (396 sq.ft.)

This floor plan is for illustrative purposes only. It is not drawn to scale. Any measurements, floor areas (including any total floor area), openings and orientations are approximate. No details are guaranteed, they cannot be relied upon for any purpose and do not form any part of any agreement. No liability is taken for any error, omission or misstatement. A party must rely upon its own inspection(s). Powered by [www.Propertybox.io](http://www.Propertybox.io)

## THE PROPERTY

Upon entering the property, you are welcomed into a bright entrance hallway which leads directly into the spacious lounge. Recently refurbished to a high standard, this inviting reception room is finished in a contemporary neutral colour palette and features stylish grey oak-effect flooring running throughout.

Leading on from the lounge is the newly fitted kitchen, thoughtfully designed to maximise both style and functionality. The kitchen boasts an attractive range of high-gloss white wall and base units, complemented by elegant grey marble-effect work surfaces. Offering ample storage, generous preparation space and designated areas for white goods, this well-appointed kitchen caters perfectly to modern-day living.

The accommodation is completed by a generously proportioned double bedroom and a contemporary shower room. The bedroom offers ample space for a double bed and additional furnishings, whilst benefiting from useful built-in storage solutions. The immaculate shower room is fitted with a modern white suite comprising a wash hand basin, low-level W.C., and a walk-in shower enclosure.

Externally, residents can enjoy access to the attractive communal gardens, which are predominantly laid to lawn and enhanced by a variety of mature shrubs and greenery. The outdoor space provides a peaceful setting to relax and socialise during the warmer months, further enhancing the appeal of this delightful home.

AI has been used to enhance this listing.

Located within the popular Crookston district on Glasgow's sought-after Southside, 3 Bullwood Court enjoys the perfect balance of peaceful residential living and excellent local convenience. Glasgow is renowned for its vibrant cultural scene, world-class shopping, diverse dining options and extensive green spaces, making it one of Scotland's most desirable cities in which to live.

The property benefits from excellent transport links, with nearby rail services and regular bus routes providing easy access to Glasgow City Centre and beyond, while the M8 and M77 motorway networks are readily accessible for commuters. Residents are well served by a variety of local amenities, including supermarkets, healthcare facilities and leisure opportunities, whilst the nearby Silverburn shopping centre offers an impressive selection of retail, dining and entertainment options. Outdoor enthusiasts can also enjoy the vast open spaces of Pollok Country Park, one of Glasgow's most celebrated parks. Positioned within a quiet cul-de-sac setting, Bullwood Court is particularly appealing to those seeking a relaxed lifestyle, with attractive communal surroundings, excellent amenities close at hand and convenient access to everything Glasgow has to offer.

Viewing by appointment - please contact The Property Boom to arrange a viewing or for any further information and a copy of the Home Report. Any areas, measurements or distances quoted are approximate, and floor plans are only for illustration purposes and are not to scale.

WOULD YOU LIKE A FREE DETAILED VALUATION OF YOUR OWN PROPERTY? TAKE ADVANTAGE OF OUR DECADES OF EXPERIENCE AND GET YOUR FREE PROPERTY VALUATION FROM OUR FRIENDLY AND APPROACHABLE TEAM. WE CUT THROUGH THE JARGON AND GIVE YOU SOLID ADVICE ON HOW AND WHEN TO SELL YOUR PROPERTY.

THESE PARTICULARS ARE ISSUED IN GOOD FAITH BUT DO NOT CONSTITUTE REPRESENTATIONS OF FACT OR FORM PART OF ANY OFFER OR CONTRACT.

[www.thepropertyboom.com](http://www.thepropertyboom.com)  
Head Office : 31 Braehead, Beith, KA15 1EG  
Tel: 0333 900 9089 / Email: [smile@thepropertyboom.com](mailto:smile@thepropertyboom.com)