



## 35 Crowhurst Crescent

Storrington | West Sussex | RH20 4QU

A two bedroom semi-detached house set in this quiet cul-de-sac location adjoining Riverside woodland walks close to the village centre. Internal accommodation comprises: ground floor cloakroom, kitchen with integrated oven and hob, open plan sitting room/dining room with French doors leading to garden, two double bedrooms with en-suite bathroom and shower room. Outside, there is a southerly walled rear garden offering a good degree to privacy. There is an allocated parking space. No forward chain.

**Entrance** uPVC double glazed front door to:

**Entrance Hall** Built-in cloaks and storage cupboard.

**Cloakroom** Low level flush w.c., inset wash hand basin with toiletries cupboards under, radiator, extractor fan.

**Sitting Room/Dining Room** 18' 0 maximum" x 12' 6 maximum" (5.49m x 3.81m) Fitted electric coal effect fireplace with surround, TV point, two radiators, understairs recessed area, double glazed French doors leading to garden.

**Kitchen** 9' 5" x 5' 9" (2.87m x 1.75m) Beech style wall and base units with laminate working surfaces, integrated stainless steel fan assisted oven and grill with four ring gas hob and extractor over, washing machine, dishwasher, one and half bowl single drainer sink unit, cupboard housing 'Potterton' boiler, part tiled walls, space for free-standing fridge/freezer.

**Stairs to:**

**First Floor Landing** Access to loft space.

**Bedroom One** 12' 7 maximum" x 11' 0 maximum" (3.84m x 3.35m) uPVC double glazed windows, radiator, telephone point, shelved linen cupboard housing pressurised cylinder, door to:

**En-Suite Shower Room** Walk-in shower with folding screen with fitted independent shower unit, w.c., inset wash hand basin with toiletries cupboards under, radiator, shaver point, extractor.

**Bedroom Two** 10' 8" x 8' 1" (3.25m x 2.46m) Radiator, double glazed windows, door to:

**En-Suite Bathroom** Shower attachment, inset wash hand basin, low level flush w.c., part tiled walls, double glazed window.

**Outside**

**Front Garden** Mainly laid to lawn, outside water tap.

**Walled Rear Garden** Paved patio, lawned area, enclosed by fence panelling and brick walling, side gate.

**Allocated Parking** There is an allocated parking space to the rear.

**EPC Rating:** Band C.



Fowlers Greenfield House, The Square, Storrington, West Sussex, RH20 4DJ

[www.fowleronline.co.uk](http://www.fowleronline.co.uk)

[storrington@fowleronline.co.uk](mailto:storrington@fowleronline.co.uk)

01903 745844

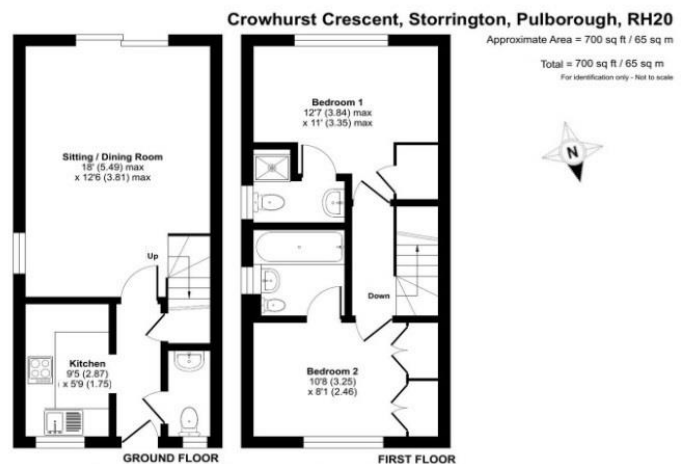

### Important Notice

1. Fowlers wish to inform all prospective purchasers that these sales particulars do not form part of any contract and have been prepared in good faith to give a fair overall viewing of the property.
2. We have not undertaken a structural survey, nor tested that the services, appliances, equipment or facilities are in good working order.
3. Fowlers cannot verify that any necessary consents have been obtained for conversions, extensions and other alterations such as underpinning,

garaging and conservatories etc. Any reference to such alterations is not intended as a statement that any necessary planning or building consents have been obtained and if such details are fundamental to a purchase, then prospective buyers should contact this office for further information or make further enquiries on their own behalf.

4. Any area, boundary, distances or measurements referred to are given as a guide only and should not be relied upon. If such details are fundamental to a purchase, please contact this office for further information.

5. The photographs shown in these details show only certain aspects of the property at the time they were taken. Certain aspects therefore may have changed and it should not be assumed that the property remains precisely as displayed in the photographs.
6. Fowlers cannot verify whether the property and its grounds are subject to any restrictive covenants, rights of way, easements etc, and purchasers are advised to make further enquiries to satisfy themselves on these points.