



FREEHOLD



House - Link Detached (EPC Rating: D)

THORNHILL, 36 COMMONHEAD STREET, AIRDRIE, ML6 6NS

Offers over

£414,995

FEATURES

- Attached sandstone house
- 3 Bathrooms
- Double garage included
- Near schools and shops
- 4 spacious bedrooms
- Enclosed garden with patio
- Close to Airdrie Station
- Master bedroom en-suite



**SWEET
HOME**



4 Bedroom House - Link Detached located in Airdrie

Caroline Morrison of Sweet Home Scotland is proud to bring to the market this stunning, Attached Traditional sandstone Villa, Offering a perfect blend of traditional charm and modern living. Thornhill, Commonhead Street in Airdrie, with four spacious bedrooms, this property is ideal for families seeking comfort and style.

As you enter, Thornhill, you are greeted by a welcoming vestibule featuring a bright hall with stairs ascending to the upper floor. The master bedroom boasts an en-suite bathroom, while the family bathroom is designed with a four-piece suite, ensuring convenience for all. One of the bedrooms is currently being utilised as a stylish bar, showcasing the versatility of the space.

The ground floor is designed for both relaxation and entertainment, featuring two generous reception rooms that provide ample space for family gatherings or quiet evenings. The large kitchen is a modern delight, complemented by a utility room and a convenient WC, making daily living a breeze.

Externally, the property is equally impressive. The enclosed garden offers a private retreat with well-maintained lawn areas and patio spaces, perfect for outdoor dining or enjoying the sunshine. A double garage provides secure parking and additional storage, while the surrounding privet hedges enhance the sense of seclusion.

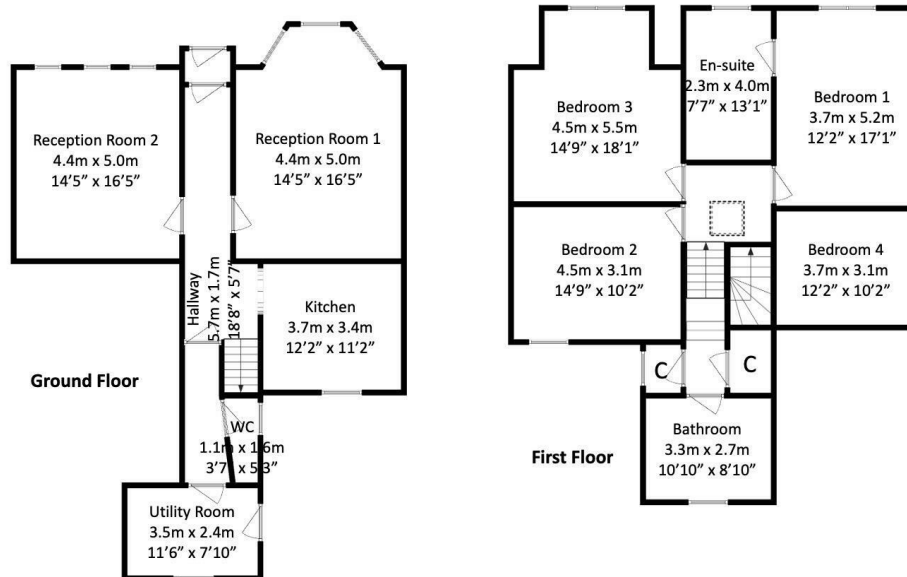

Call us on

01236 677500

sales@sweet-home.co.uk

<https://sweet-home.co.uk/>

Council Tax Band

D

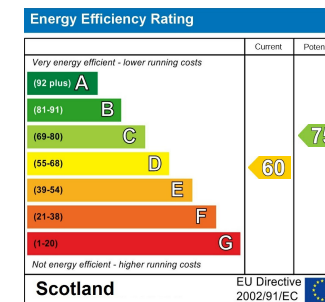

Agents Note: Whilst every care has been taken to prepare these particulars, they are for guidance purposes only. All measurements are approximate and are for general guidance purposes only and whilst every care has been taken to ensure their accuracy, they should not be relied upon and potential buyers are advised to recheck the measurements.

SWEET HOME

