



## Church Crescent, N10

### £395,000

Situated in a sought-after location in the heart of Muswell Hill is this red- brick Edwardian garden flat offering a spacious double bedroom and period features such as high ceilings, sash windows and direct access out onto a mature half decked private rear garden. Ideal for buyers looking for a chain free purchase.

Within walking distance to Muswell Hill Broadway; offering a plethora of trendy cafes, organic groceries shops and restaurants. Plus great locality for some stunning walks within both Highgate Woods, Cherry Tree Wood and the Parkland Walk.

### Features

- Private Garden
- Chain Free
- Period Conversion
- Great Location
- Red Brick Edwardian
- Double Bedroom

# Church Crescent, London, N10

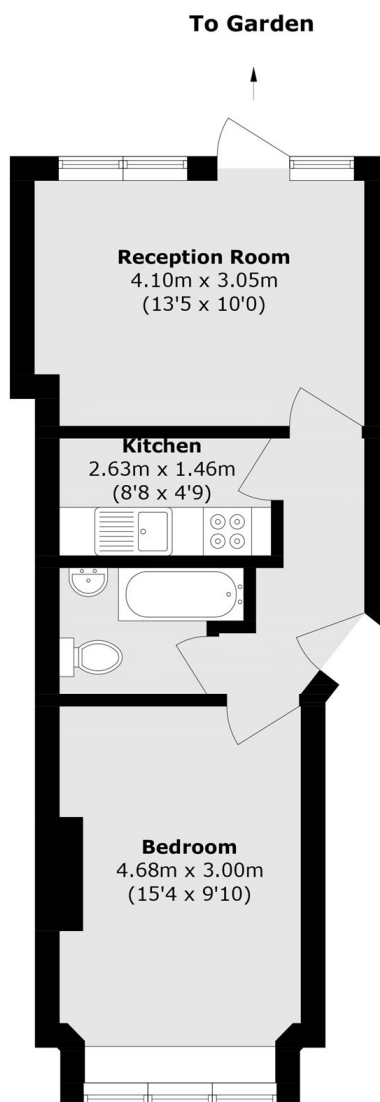

Total area (approx.): 38.5 sq. m (414.4 sq. ft)