



SYMONDS + GREENHAM

Estate and Letting Agents



16 Chandlers Court, Hull, HU9 1FB

£110,000

Symonds & Greenham are delighted to present this well presented two bedroom ground floor apartment, situated within the popular Chandlers Court development at Victoria Dock. Offering spacious and light filled accommodation throughout, this move in ready home enjoys a peaceful residential position while remaining conveniently close to local amenities, Hull city centre and excellent transport links.

Appealing to a variety of buyers including first time purchasers, downsizers and investors alike, the property offers a fantastic balance of comfort and practicality within one of the area's most popular residential developments.

The accommodation briefly comprises an entrance hall with multiple useful storage cupboards, providing practicality and storage space. There are two lovely bedrooms, a fantastic en suite to the primary bedroom, a good sized and well maintained bathroom and a bright, welcoming open plan living area featuring a beautiful bay window that allows plenty of natural light to flow through the space. The adjoining fitted kitchen is well laid out and perfectly suited to modern day living.

Externally, the property further benefits from an allocated parking space.

This is a fantastic opportunity to acquire a spacious and well kept apartment in a sought after location and one that is not to be missed.

BOOK YOUR VIEWING NOW!

CENTRAL HEATING

The property has the benefit of gas central heating (not tested).

COUNCIL TAX BAND

Symonds + Greenham have been informed that this property is in Council Tax Band B.

DISCLAIMER

Symonds + Greenham do their utmost to ensure all the details advertised are correct however any viewer or potential buyer are advised to conduct their own survey prior to making an offer.

DOUBLE GLAZING

The property has the benefit of double glazing.

FLOOR PLAN DISCLAIMER

The measurements detailed on the floor plan are the maximum possible measurement for the length and width of the respective room, which can potentially be a measurement into an alcove, wardrobe or cupboard.

TENURE

Symonds + Greenham have been informed that this property is Leasehold.

If you require more information on the tenure of this property please contact the office on 01482 444200.

VIEWINGS

Please contact Symonds + Greenham on 01482 444200 to arrange a viewing on this property.

GROUND FLOOR

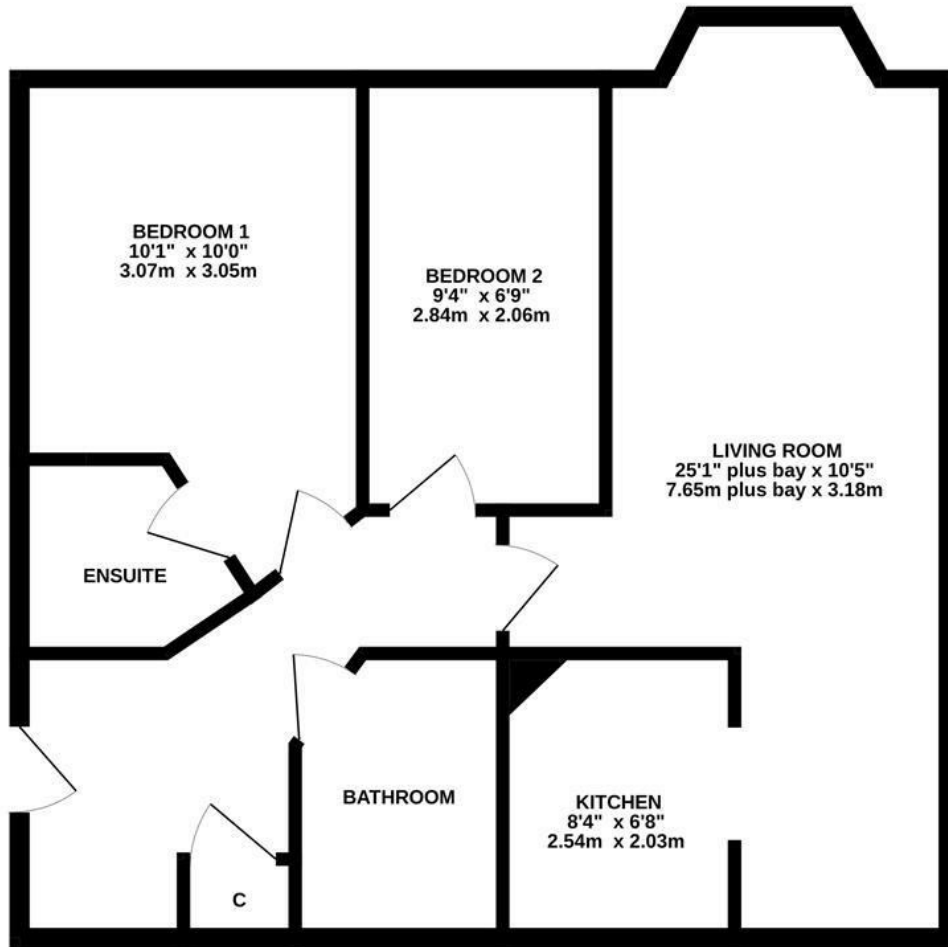

Whilst every attempt has been made to ensure the accuracy of the floorplan contained here, measurements of doors, windows, rooms and any other items are approximate and no responsibility is taken for any error, omission or mis-statement. This plan is for illustrative purposes only and should be used as such by any prospective purchaser. The services, systems and appliances shown have not been tested and no guarantee as to their operability or efficiency can be given.
Made with Metropix ©2026

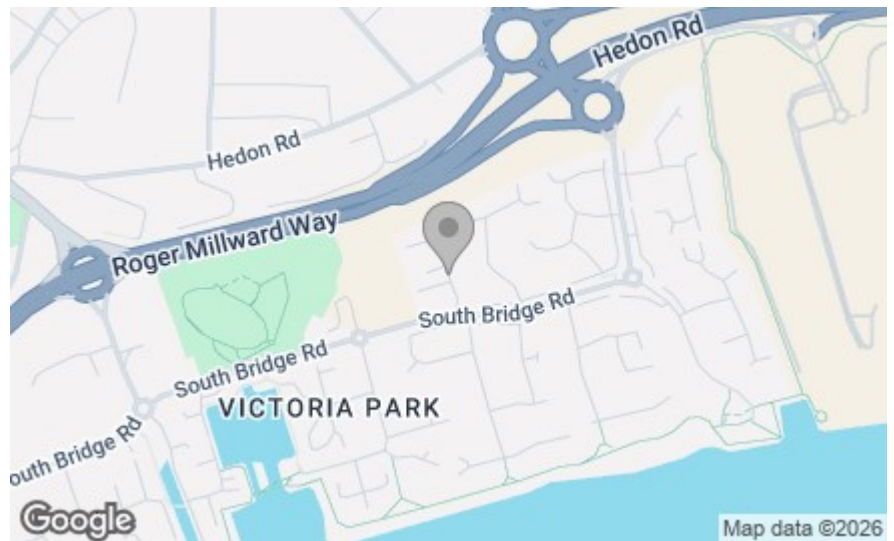

Energy Efficiency Rating	
Current	Potential
70	76

Environmental Impact (CO ₂) Rating	
Current	Potential