



**Montpelier Terrace, Brighton, BN1 3DS**

**£375,000**



**Property Type:** Flat

**Bedrooms:** 2

**Bathrooms:** 1

**Receptions:** 1

**Tenure:** Share of Freehold

**Council Tax Band:** C

- Top (Third) Floor Apartment
- Two Double Bedrooms
- Allocated Parking Space
- Modern Kitchen and Bathroom
- Open Plan Living
- Share of Freehold
- Passenger Lift
- Very Central Location
- Close To Seafront, Cafes and shops
- Walking Distance to Brighton Station

Very well presented top (third) floor apartment located very centrally in Brighton. Two double bedrooms, modern kitchen and bathroom, share of freehold and allocated parking space. Close to shops, cafes, restaurants, seafront and station.





An exceptionally well presented top (third) floor apartment, centrally located on Montpelier Terrace in Brighton, offering a desirable urban lifestyle.

This spacious apartment boasts an efficient and modern layout, including an inviting open plan living area that seamlessly integrates with a contemporary kitchen. The kitchen itself is a highlight, designed with modern fittings and ample workspace, perfect for both everyday cooking and entertaining.

The property features two comfortable double bedrooms, providing versatile accommodation options. The modern bathroom is tastefully appointed, reflecting the property's overall contemporary finish.

One of the significant advantages of this apartment is the inclusion of an allocated parking space, a rare and highly sought after convenience in such a central location. Further enhancing the appeal is a passenger lift, ensuring easy access to this top floor abode. The property is offered with a share of freehold, adding to its long term desirability.

Situated in a very central location, residents will appreciate the proximity to Brighton's vibrant amenities. The seafront, an array of cafes, diverse shops, and excellent restaurants are all within easy reach, as is Brighton Station, making this an ideal home for those seeking convenience and connectivity.



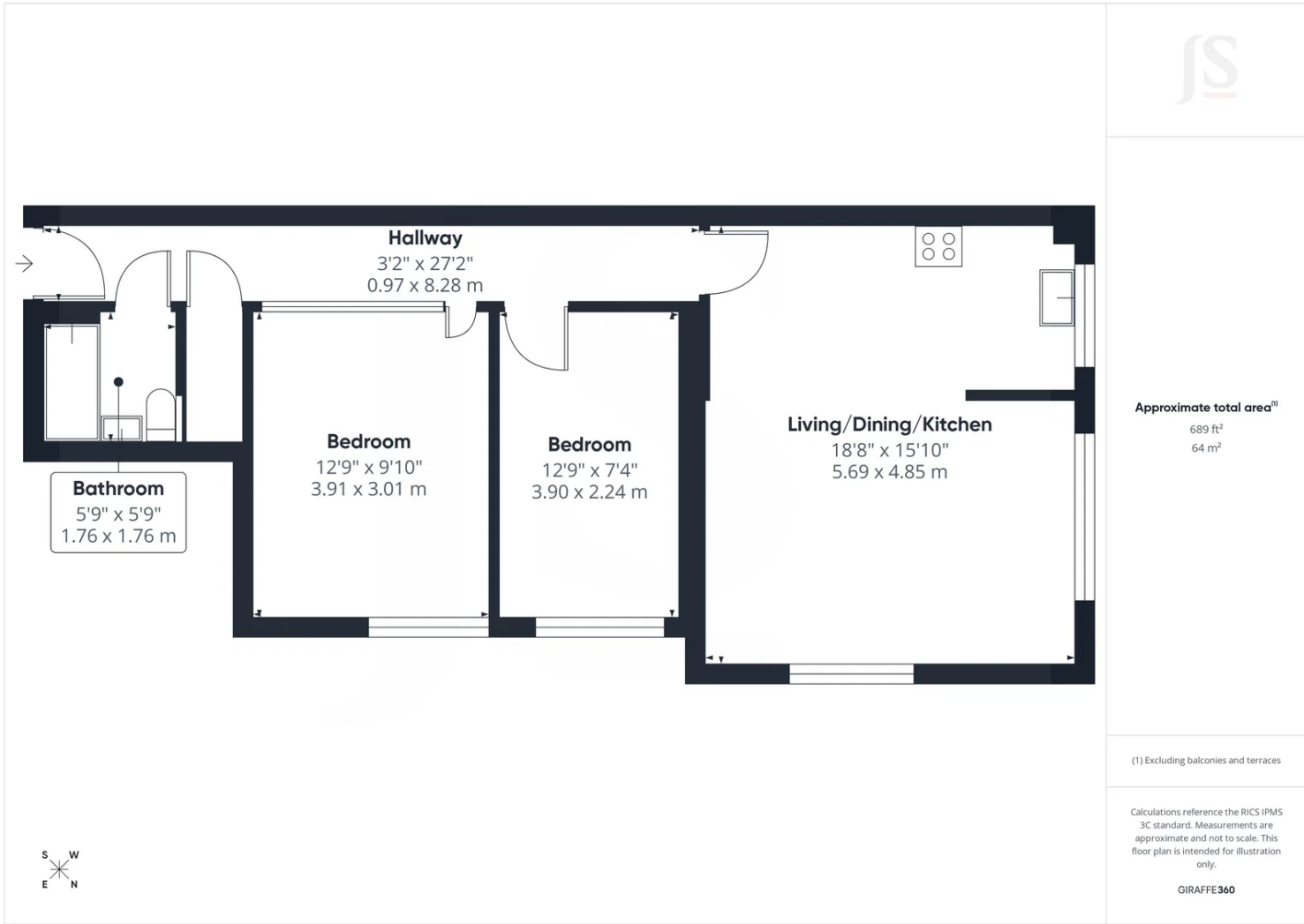

Whilst we endeavour to make our properties particulars accurate and reliable, we have not carried out a detailed survey. If there is any point which is of particular importance to you, please contact the office and we will be pleased to check the information for you, particularly if you are contemplating travelling some distance. Whilst every effort has been made to ensure that any floorplans are correct and drawn as accurately as possible, they are to be used for layout and identification purposes only and are not drawn to scale. The services, where applicable, including electrical equipment and other appliances have not been tested and no warranty can be given that they are in working order, even where described in these particulars. Carpets, curtains, furnishing, gas fires, electrical goods/ fittings or other fixtures, unless expressly mentioned, are not necessarily included with the property.