



Flat 15, Church View, Church Walk

Offers Over £60,000

 **NEWTON FALLOWELL**

Flat 15

Church View, Bourne

Council Tax band: A

Tenure: Leasehold

EPC Energy Efficiency Rating: D

EPC Environmental Impact Rating: D

- Ground Floor Apartment
- Ideal Central Location
- Studio Living Area
- Private Residence Parking Area
- Ideal First Home or BTL Investment
- No Onward Chain
- Well Presented Throughout
- Viewing Highly Recommended





Entrance Hall

Studio

14' 2" x 9' 4" (4.33m x 2.85m)

Kitchen

8' 6" x 5' 3" (2.59m x 1.59m)

Bathroom

6' 3" x 5' 4" (1.91m x 1.63m)



GROUND FLOOR
273 sq.ft. (25.4 sq.m.) approx.

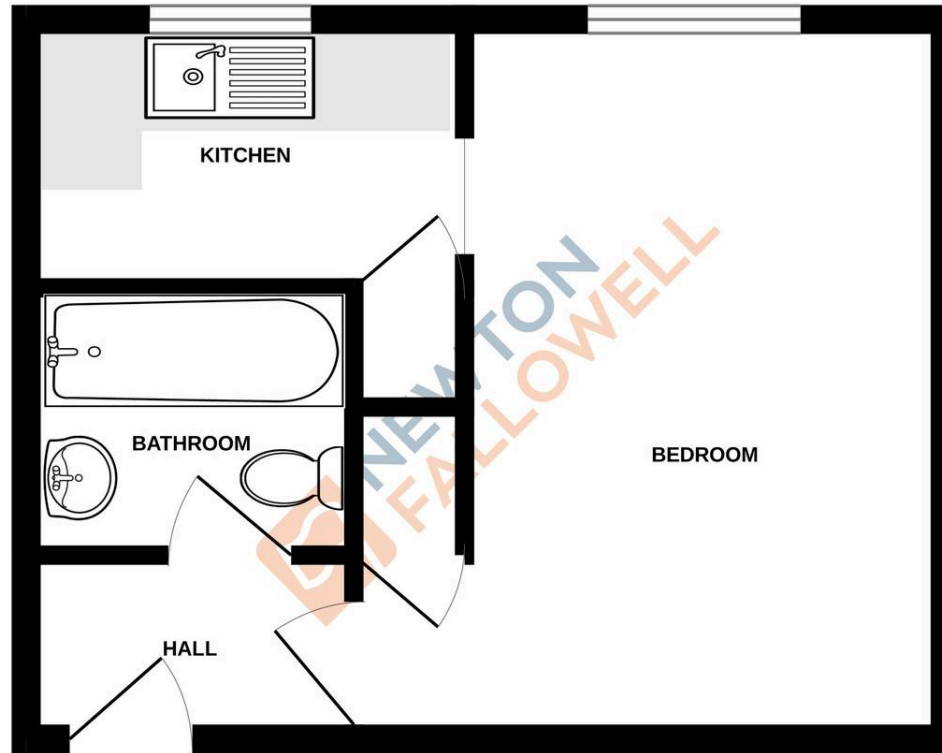

TOTAL FLOOR AREA : 273 sq.ft. (25.4 sq.m.) approx.

Whilst every attempt has been made to ensure the accuracy of the floorplan contained here, measurements of doors, windows, rooms and any other items are approximate and no responsibility is taken for any error, omission or mis-statement. This plan is for illustrative purposes only and should be used as such by any prospective purchaser. The services, systems and appliances shown have not been tested and no guarantee as to their operability or efficiency can be given.
Made with Metropix ©2025

Newton Fallowell - Bourne

Newton Fallowell, 2 North Street - PE10 9EA

01778 422567 · bourne@newtonfallowell.co.uk · newtonfallowell.co.uk/bourne