



Sherwood Gardens, E14

£519 Per week

An spacious two bedroom apartment on the first floor of this modern development. This contemporary apartment has an large corner living room, separate kitchen/ diner, wooden flooring and secured allocated parking.

Sherwood Gardens is located 0.3 Miles from from Mudchute DLR, offering good commuter links into the City and the wealth of amenities in Central Canary Wharf.

Features

- First Floor
- Two Bedrooms
- Spacious Lounge
- Separate Kitchen/Diner
- Furnished
- Secured Gated Development



Sherwood Gardens, E14



Sherwood Gardens, London, E14

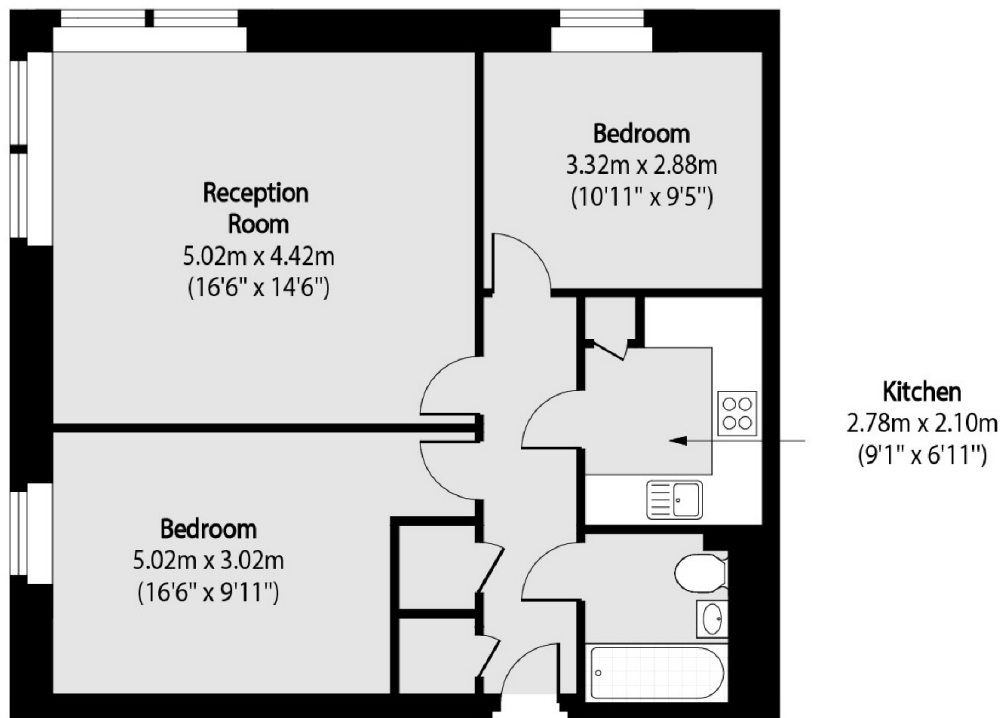

Total area (approx): 63.21 sq m (680 sq. ft)