



Otter Street, Rothwell Kettering **Freehold** £215,000

**Pattison
Lane**

Key Features

 2  2  B  B

- Beautifully Presented Mid-Terrace Home
- Two Double Sized Bedrooms
- Spacious Living Room
- Downstairs WC
- Driveway for Two Vehicles

Welcomed to the market this beautifully presented two-bedroom mid-terraced home is an exceptional opportunity for a wide range of buyers, from first-time homeowners to small families and investors.

Nestled in a highly sought-after new residential development of Woodland Valley Rothwell, the property combines modern living with a prime location.



As you step inside, you are greeted by a welcoming entrance hall that leads to a spacious living room, providing a perfect space for relaxation or entertaining. The open-plan kitchen and diner, offers a bright and functional area for cooking and dining with French Doors leading to the rear garden. A convenient downstairs WC completes the ground floor layout.

Upstairs, you will find two generously sized double bedrooms. The master bedroom offers a tranquil retreat, while the second bedroom is perfect for guests, a child's room, or a home office. A spacious and modern family bathroom features contemporary fixtures and includes additional built-in storage.

The property's exterior is just as impressive. The rear garden is a well-maintained oasis, perfect for outdoor dining or gardening, and includes a handy storage shed. The front of the house provides off-street parking for two vehicles, and an installed electric charging point adds modern convenience for electric vehicle owners.

Viewings are highly advised to appreciate all this property has to offer!



GROUND FLOOR

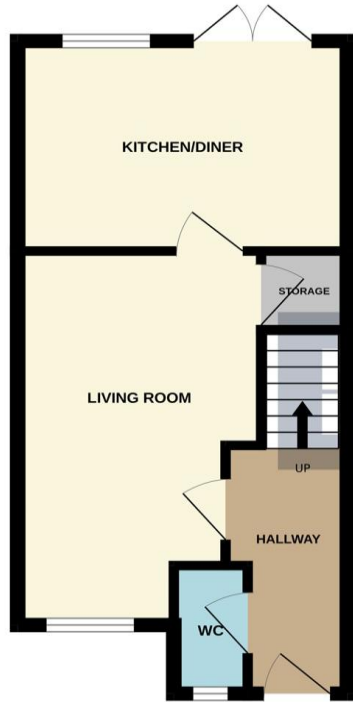

1ST FLOOR

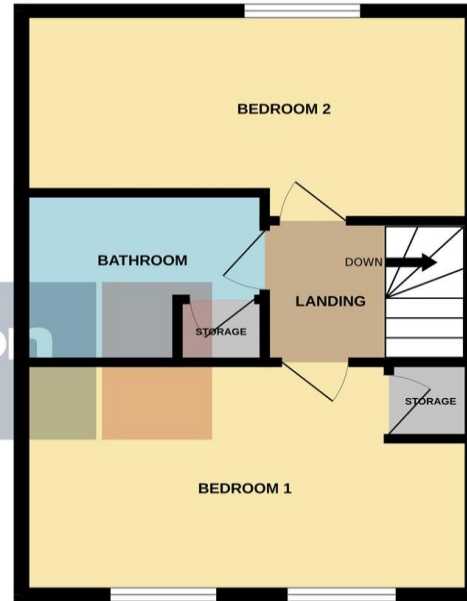

Whilst every attempt has been made to ensure the accuracy of the floorplan contained here, measurements of doors, windows, rooms and any other items are approximate and no responsibility is taken for any error, omission or mis-statement. This plan is for illustrative purposes only and should be used as such by any prospective purchaser. The services, systems and appliances shown have not been tested and no guarantee as to their operability or efficiency can be given.
Made with Metropix ©2025

The accommodation comprises:

ENTRANCE HALL

CLOAKROOM

LOUNGE 9'5 x 15'1 max (2.87m x 4.59m)

KITCHEN / DINING ROOM 12'8 x 7'9 (3.86m x 2.36m)

FIRST FLOOR LANDING

BEDROOM ONE 9'4 x 17' max (2.84m x 5.18m)

BEDROOM TWO 17' x 6'8 (5.18m x 2.03m)

BATHROOM 6'9 x 10'1 (2.05m x 3.07m)

OUTSIDE

FRONT GARDEN / DRIVEWAY

REAR GARDEN

To view this property call Pattison Lane on:
01536 430527

Selling your property?



SCAN ME

Contact us to arrange a **FREE** home valuation.

 01536 430527

 42 Station Road, Desborough, KETTERING, Northamptonshire, NN14 2RL

 desborough@pattisonlane.co.uk

 www.pattisonlane.co.uk



SCAN ME



Sharman Quinney Holdings Limited is registered in England and Wales under company number 4174227, Registered Office is Cumbria House, 16-20 Hockliffe Street, Leighton Buzzard, Bedfordshire, LU7 1GN. VAT Registration Number is 500 2481 05.

1: These particulars do not constitute part or all of an offer or contract. 2: The measurements indicated are supplied for guidance only and as such must be considered incorrect. 3: Potential buyers are advised to recheck the measurements before committing to any expense. 4: Sharman Quinney has not tested any apparatus, equipment, fixtures, fittings or services and it is the buyers interests to check the working condition of any appliances. 5: Sharman Quinney has not sought to verify the legal title of the property and buyers must obtain verification from their legal representative. 6: Intending purchasers will be asked to produce identification documentation at a later stage and we would ask your co-operation in order that there will be no delay in agreeing the sale. Ref: DPL101637 - 0001

