

Floor plan produced in accordance with RICS Property Measurement 2nd Edition, incorporating International Property Measurement Standards (IPMS2 Residential). © ncbcom 2025. Produced for James Estate Agents. REF: 1314010

GROUND FLOOR

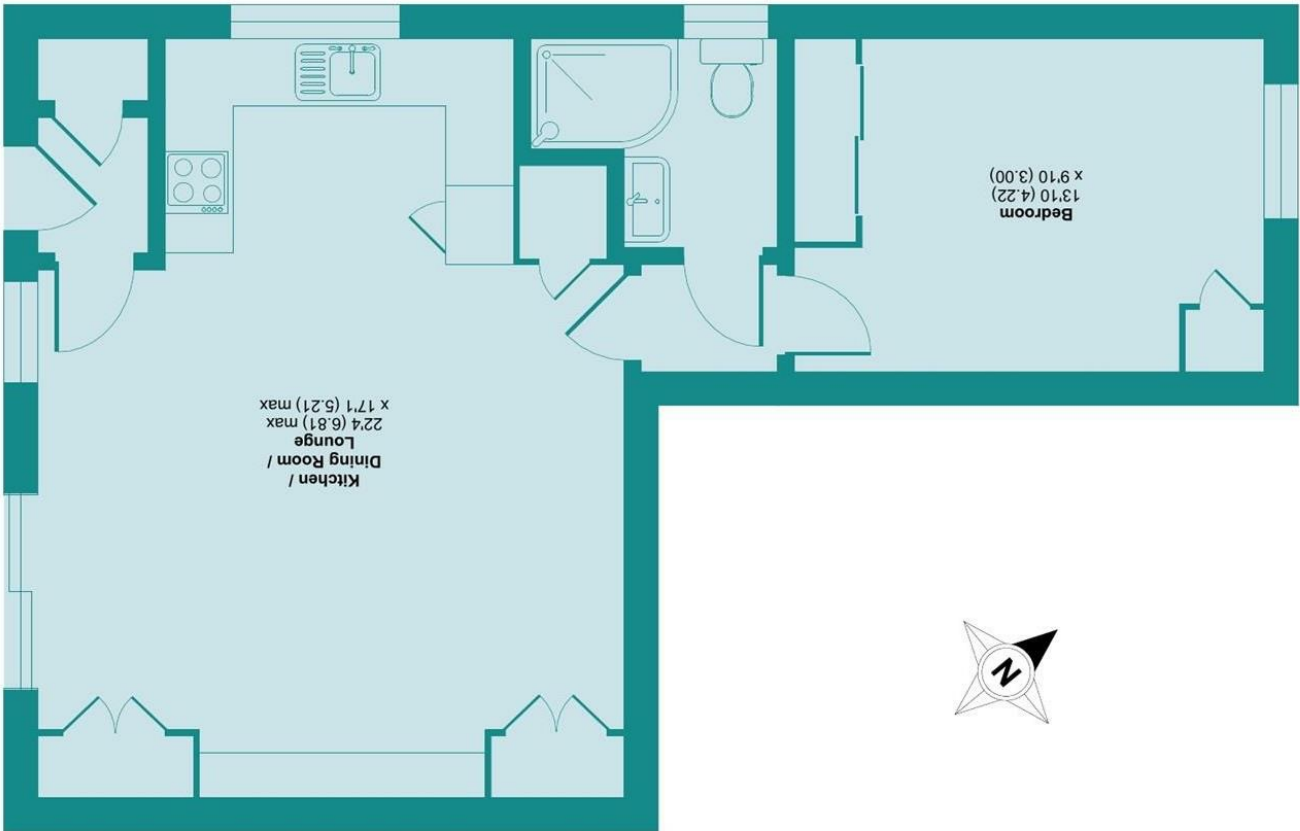

Approximate Area = 570 sq ft / 52.9 sq m
For identification only - Not to scale

Southam Mews, Croxley Green, Rickmansworth, WD3 3FG

LOCAL AUTHORITY
Three Rivers District Council

TENURE
Share of Freehold

COUNCIL TAX BAND
C

VIEWS
By prior appointment only

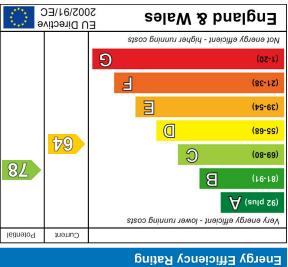

Agents Note: Whilst every care has been taken to prepare these particulars, they are for guidance purposes only. All measurements are approximate and are for general guidance purposes only and whilst every care has been taken to ensure their accuracy, they should not be relied upon and potential buyers/tenants are advised to recheck the measurements

PROPERTY SUMMARY

NO UPPER CHAIN AND SHARE OF FREEHOLD

Unique, exclusive and well presented one bed ground floor luxury flat situated in one of the most exclusive residential developments right in the heart of Croxley Green. Enjoying many benefits including it's own private entrance, under floor heating, a private sunny patio, lovely lounge/diner, appliance fitted kitchen, double bedroom with fitted wardrobes. One allocated parking space and communal gardens. This luxury apartment is tailor made for a buyer looking to downsize to a quality home in a secure residential location within an exclusive gated community, or a first time buyer. A must view, so call us today to book an appointment. Service Charge: £1,440 pa (service and maintenance, includes ground rent).

1



1



1

