



Apartment 3 Wellington House Waterloo Road, Ramsey, Isle Of  
Man, IM8 1EG  
£199,950

- Apartment 3, Wellington House, Waterloo Road, Ramsey – A purpose-built ground floor apartment offering low-maintenance living in a convenient central location.
- Light & Recently Refreshed Interior – Well-designed, airy accommodation that has been recently re-decorated throughout, creating a bright and welcoming feel.
- Modern Open-Plan Living – Spacious living room flowing into a contemporary dining kitchen, ideal for both everyday living and entertaining.
- Secure Parking & No Onward Chain – Benefitting from an allocated underground parking space and being offered with no onward chain for a smooth purchase.



Apartment 3, Wellington House, Waterloo Road, Ramsey

Located within a modern and well-maintained development, this spacious ground floor apartment offers convenient and low-maintenance living within easy reach of Ramsey town centre, local amenities and schools. Benefiting from a level walk into town and positioned on the main bus route to Douglas, the property is ideally suited to a wide range of purchasers.

The accommodation is bright, spacious and thoughtfully designed, comprising an impressive open-plan lounge, kitchen and dining area, creating the perfect space for both everyday living and entertaining. The well-appointed kitchen offers ample storage and workspace, seamlessly complementing the living area.

There are two generous double bedrooms, including a spacious principal bedroom with the added benefit of a modern en-suite shower room. A contemporary family bathroom serves the remainder of the accommodation.

Further features include lift access to all floors, secure underground allocated parking and the reassurance of an active management company. The property is held on a 999-year lease, providing long-term peace of mind.

Whether you are a first-time buyer looking to step onto the property ladder, an investor seeking a strong addition to your portfolio, or someone searching for a convenient lock-up-and-leave home, Apartment 3 Wellington House presents an excellent opportunity in a sought-after Ramsey location.





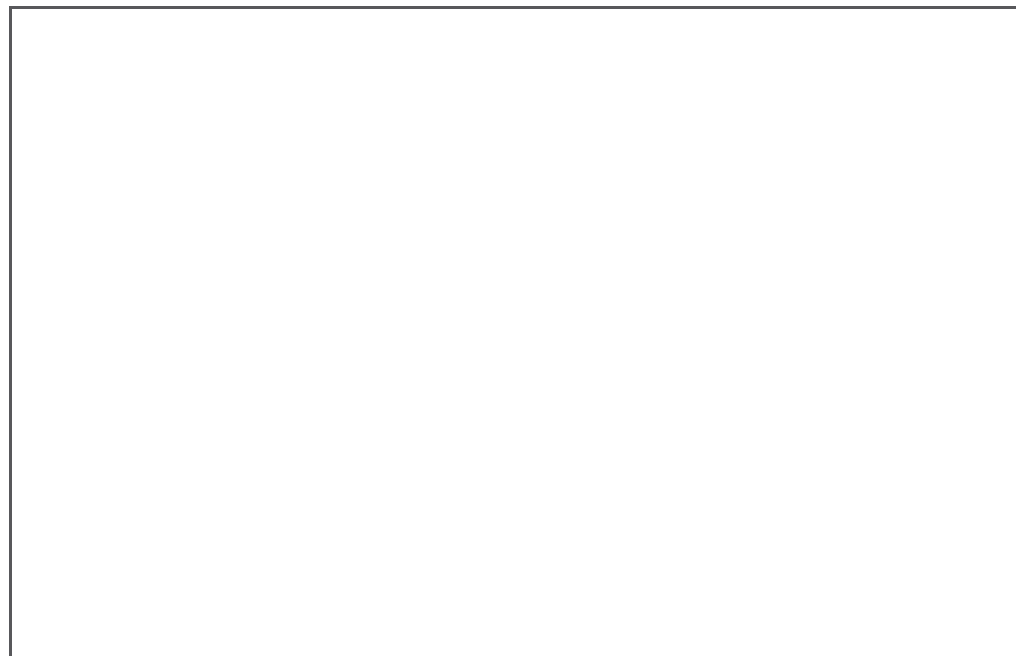
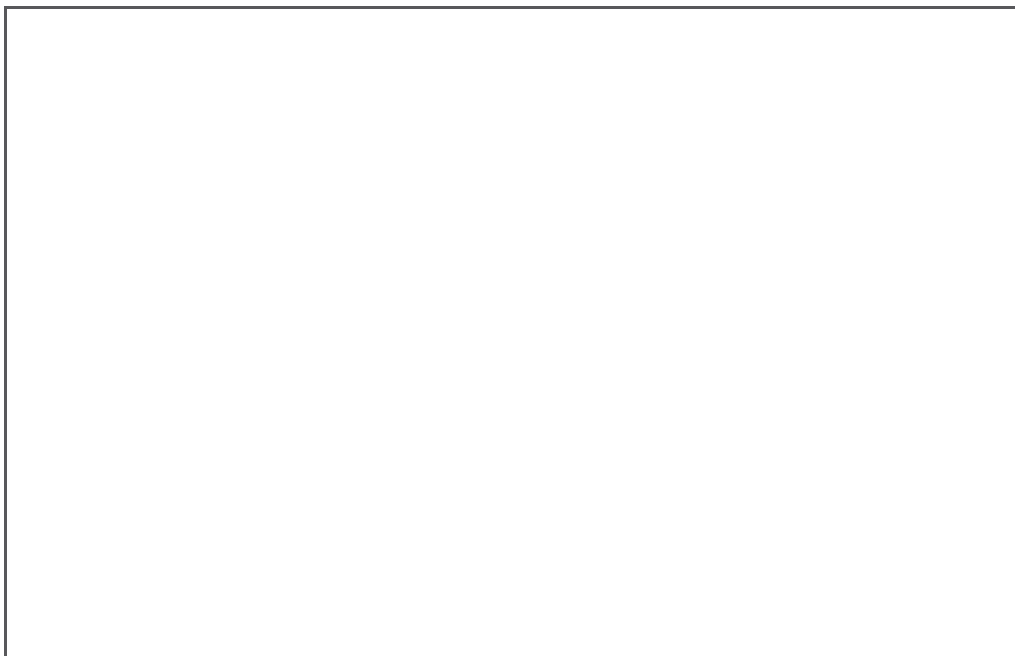
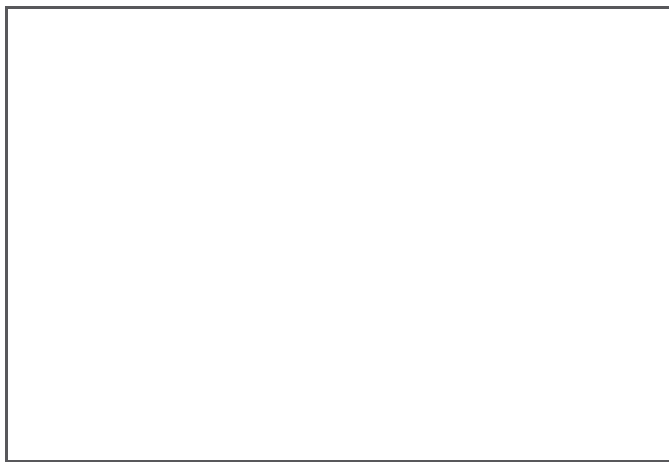

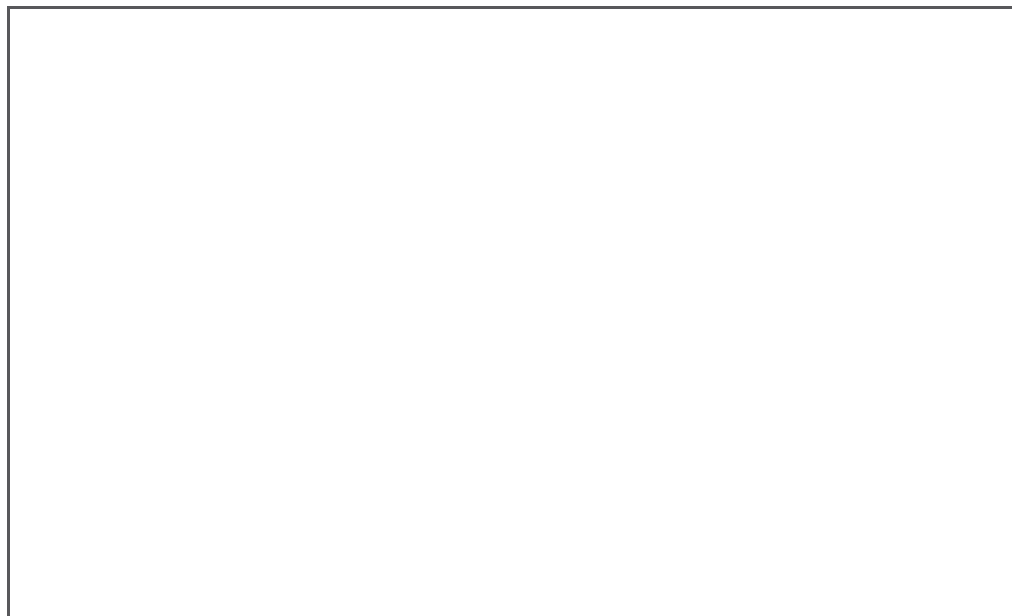
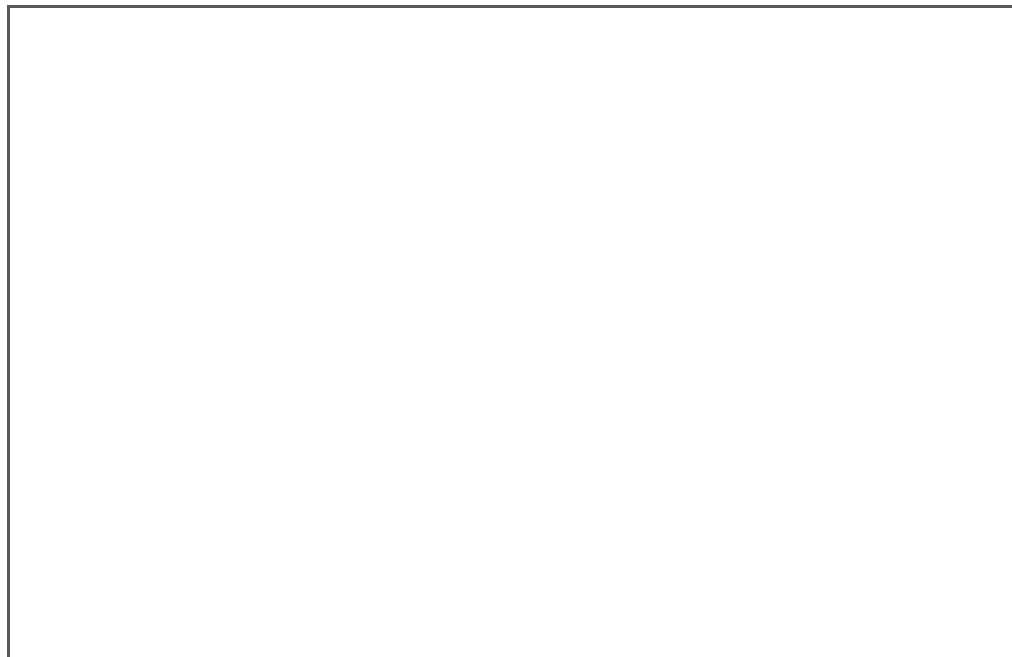
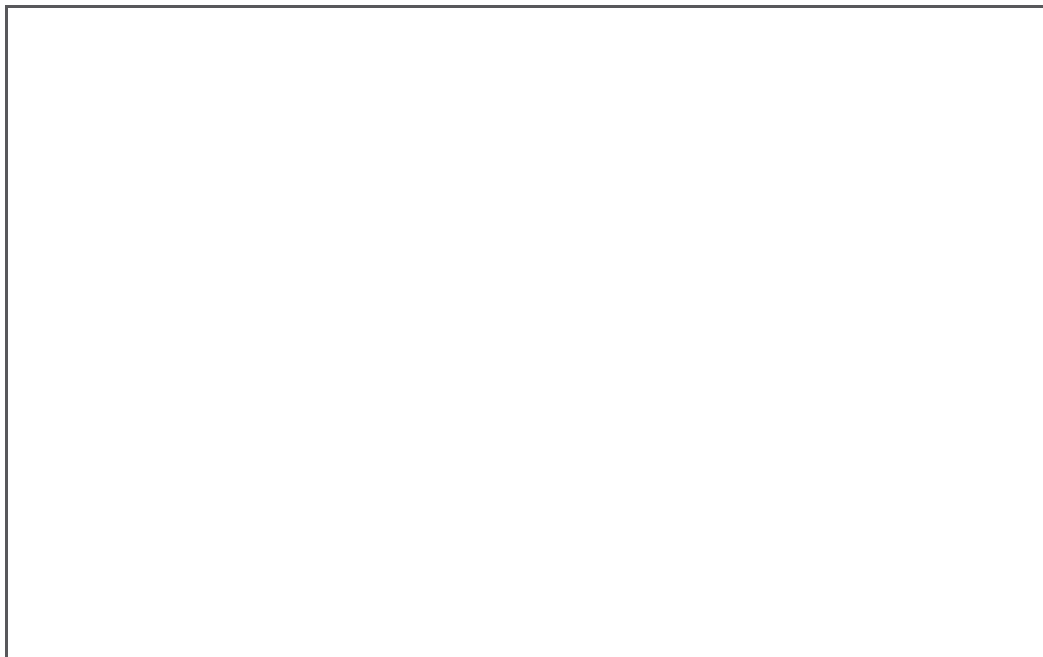

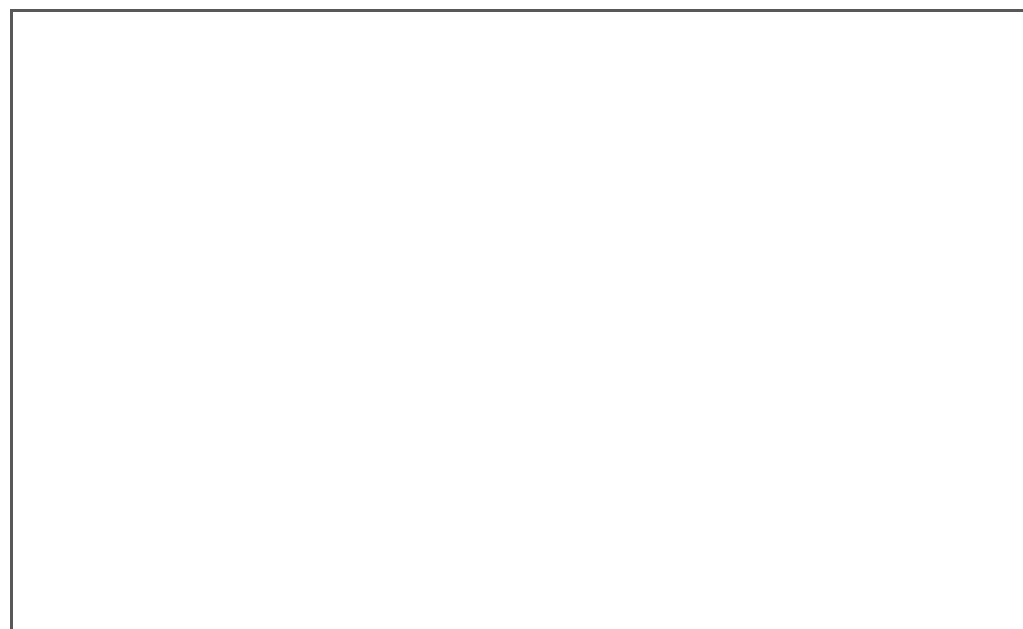

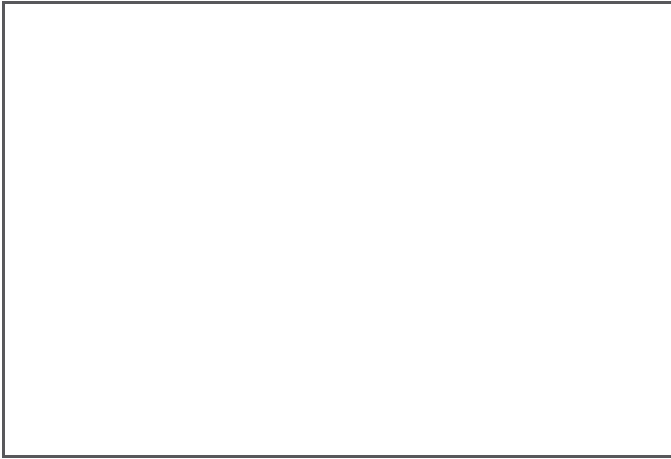

Apartment 3 Wellington House Waterloo Road, Ramsey, Isle Of Man, IM8 1EG

---



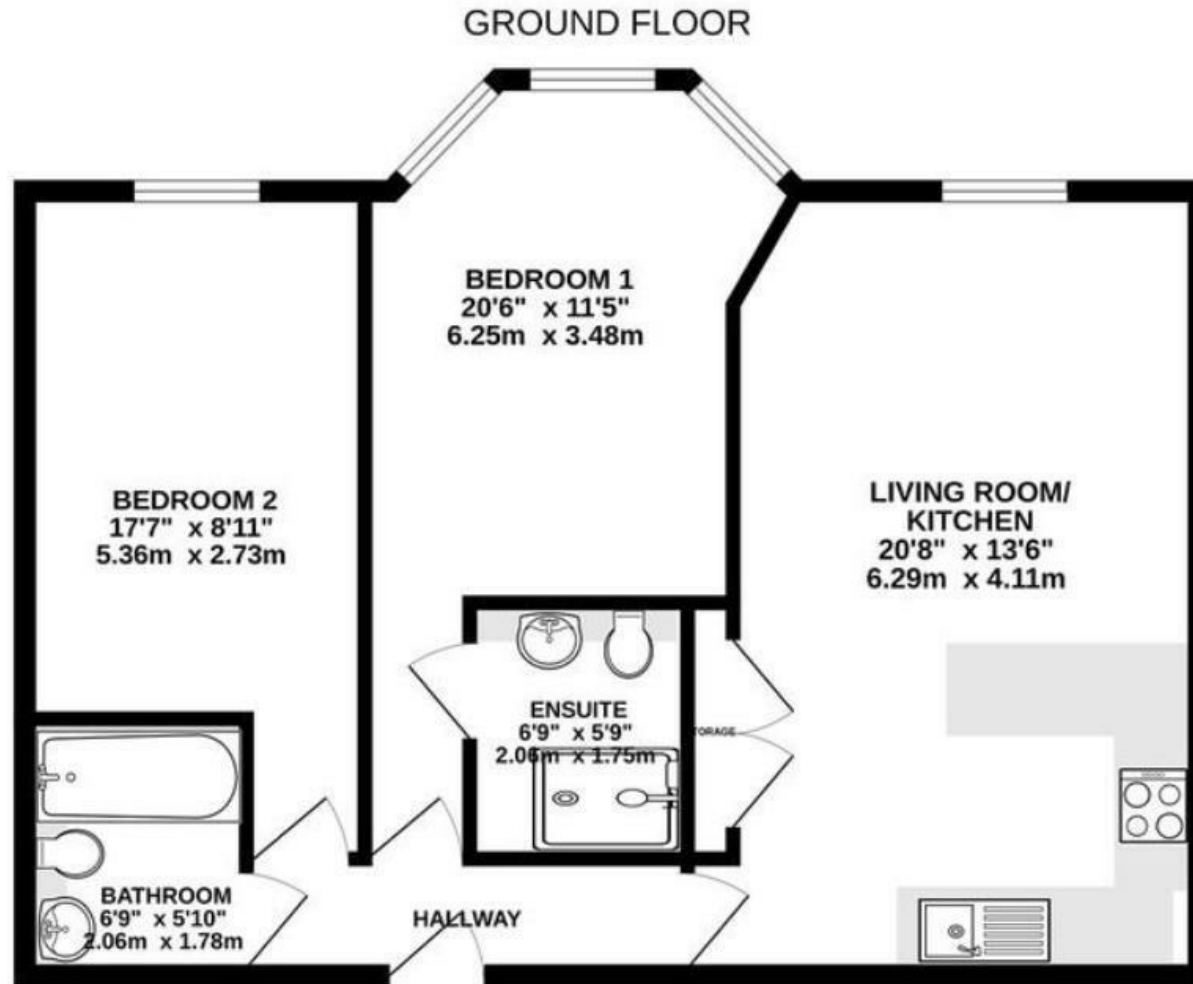

**DOUGLAS**

37 VICTORIA STREET  
DOUGLAS  
ISLE OF MAN IM1 2LF

**T** 01624 620606

**F** 01624 677363

**E** info@deanwood.co.im

**CASTLETOWN**

COMPTON HOUSE  
9 CASTLE STREET CASTLETOWN  
ISLE OF MAN IM9 1LF

**T** 01624 825995

**F** 01624 825996

**E** castletown@deanwood.co.im

**RAMSEY**

LEZAYRE HOUSE  
87 PARLIAMENT STREET  
RAMSEY ISLE OF MAN IM8 1AQ

**T** 01624 816111

**F** 01624 816588

**E** ramsey@deanwood.co.im

These particulars are for information purposes only. They do not constitute or form any contract nor should any statement contained herein be relied upon as a representation of fact. Neither the vendor nor DeanWood Agencies Limited ('the firm'), nor any officer or employee of the firm accept liability or responsibility for any statement contained herein. The vendor does not by these particulars, nor does the firm, nor does any officer or any employee of the firm have any authority to make or give any representation or warranty whatsoever as regards the property or otherwise. It is the sole responsibility of any person interested in the property described in these particulars to make all proper enquiries and searches to verify the description of the property and all other particulars herein.

FOR MORE PROPERTIES VISIT OUR WEBSITE @ [deanwood.im](http://deanwood.im)