



OFFICE HOURS:

Monday to Friday	9 am	to	5 pm
Saturday	9 am	to	2 pm
Sunday and Bank Holidays	12 noon	to	2 pm

10 good reasons to choose DMA

- * Open 7 days a week.
- * Filey's longest established family run independent estate agency.
- * Prompt efficient friendly service.
- * 360° virtual tours and floor plans.
- * Free advertising: no sale - no charge.
- * Free no obligation market valuation.
- * Free accompanied viewing.
- * Dedicated sales progression.
- * Prominent town centre location.
- * Modern walk-round self selection display.

RESIDENTIAL
SALES

DMA ESTATE
AGENTS

COMMERCIAL
SALES

Proprietors: David Mansfield ATTON FNAEA.
Samantha ADDISON
www.dmaestateagents.co.uk
ESTABLISHED 1992



These particulars are intended only to give a fair description of the property, as a guide to prospective buyers. Accordingly a) their accuracy is not guaranteed and neither DMA Estate Agents nor the vendor(s) accept any liability in respect of their contents; b) they do not constitute an offer or contract of sale, and c) any prospective purchaser should satisfy themselves by inspection or otherwise as to the correctness of any statement or information in these particulars.

DMA

ESTATE
AGENTS



5 BYRE WAY, BURTON FLEMING YO25 3QA



Freehold £225,000

FEATURES

- * Extended three bedroom detached house.
- * Located on a quiet cul-de-sac in this small rural village on the edge of the Yorkshire Wolds.
- * Oil fired central heating.
- * Upvc double glazing.
- * Extended modern kitchen.
- * Large sunroom with bi-folding doors to garden.
- * Modern bathroom and ensuite to master bedroom.
- * Garage and parking for 3 vehicles.
- * Enclosed rear garden.
- * **Sold with no onward chain.**
- * **EPC Rating: C.**
- * Viewing is highly recommended.

ACCOMMODATION IN BRIEF

GROUND FLOOR: Front Door to Entrance Hall. WC. Lounge. Kitchen. Sunroom
FIRST FLOOR: Three Bedrooms (one with Ensuite). Bathroom.
OUTSIDE: Gardens to front and rear. Drive to Garage.

26 Belle Vue Street, FILEY, North Yorks. YO14 9HY. Telephone: 01723 515527
www.dmaestateagents.co.uk / www.rightmove.co.uk

5 BYRE WAY, BURTON FLEMING

Front Door to:

ENTRANCE HALL

Understairs cupboard. Radiator.



CLOAKROOM

Handbasin and wc. Radiator. Upvc double glazed window.

LOUNGE

4.72m x 3.28m (15'6" x 10'9")

Wall mounted electric fire. Remote control LED light incorporating fan. Radiator. Upvc double glazed window.



/ continued over

KITCHEN

5.64m x 2.64m (18'6" x 8'8")

Black inset sink with vegetable sink and drainer. Base cupboards with worktops over. Matching wall cupboards. Electric hob with modern extractor hood above. Built-in eye-level double oven. Integrated tall 'fridge freezer, dishwasher and washing machine. Provision for tall 'American' style 'fridge/freezer. Wall mounted combination boiler. Inset spotlights. Radiator.



SUN ROOM

2.90m x 5.23m (9'6" x 17'2")

Radiator. Bi-folding doors. Tiled floor.



Floor plan:

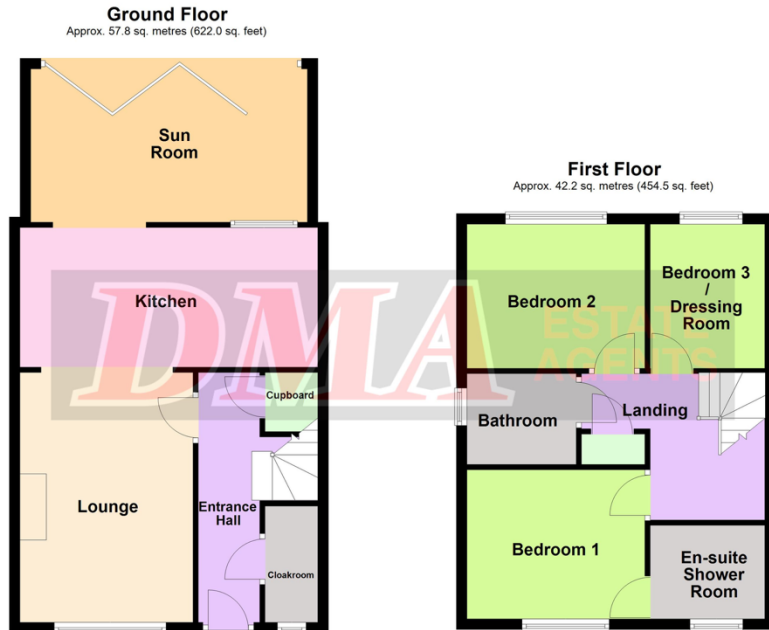

Total area: approx. 100.0 sq. metres (1076.5 sq. feet)
5 Brye Way, Burton Fleming

FIRST FLOOR:

LANDING

Tall cupboard. **Loft access.**

BEDROOM ONE

3.38m x 2.82m (11'1" x 9'3")

Radiator. Upvc double glazed window.



ENSUITE SHOWER ROOM

1.80m x 2.13m (5'11" x 7'0")

Quadrant shower. Handbasin and wc. Radiator. Upvc double glazed window.



BEDROOM TWO

2.64m x 3.50m (8'8" x 11'6")

Radiator. Upvc double glazed window.

BEDROOM THREE
2.20m x 2.64m (7'3" x 8'8")

Wood panelling. Radiator. Upvc double glazing.



LOCATION:

Burton Fleming is a picturesque village in the East Riding of Yorkshire. Sitting very close to the North Yorkshire Border, the village is situated approximately 7 miles (11 km) north-west of the Coastal resorts of Bridlington and 6 miles (10 km) south of Filey, both famed for their beautiful beaches. The village has a lovely community with events often taking place at the village hall. The historic 12th Century St Cuthbert church, is a must see, situated in the heart of the village on the village green. There is a play park, two ponds and beautiful walks, with breath taking views over the wolds. Wold Newton Primary school is situated in the neighbouring village, and there is also a school and amenities just 7 miles away in the lovely village of Hunmanby.



BATHROOM
2.13m x 1.73m (7'0" x 5'8")

Jacuzzi spa bath, handbasin and wc. Fully tiled walls. Chrome towel radiator. Extractor fan. Upvc double glazed window.

Council Tax Band C.

OUTSIDE:

Front garden. Drive to Good sized **GARAGE** with upstairs storage, light and power. **CARPORT**. Parking for up to 3 cars. Rear garden.



DIRECTIONS:

Follow the signposts into Hunmanby village onto Bridlington Street turning left towards Reighton and Bridlington. Turn right at the mini-roundabout just before the railway crossing onto New Road. Take the second turning on the left to Burton Fleming. Continue to the junction by the public house in the middle of the village and turn right. Take the first right onto West Lane. Take the first right onto The Crescent. Take the next left onto Byre Way and the property is located on the left hand side.

Viewing strictly by appointment only through DMA Estate Agents