



Honeycross Road,HEMEL HEMPSTEAD HP1 2JA

welcome to

Honeycross Road, HEMEL HEMPSTEAD

Located in a sought after residential area and being very well presented throughout is this three bedroom mid terraced family home. 0.3 miles from Long Chaulden Shops. 0.4 miles of two primary schools. 1.2 miles of Hemel Hempstead mainline train station. Give us a call today !!





Ground Floor

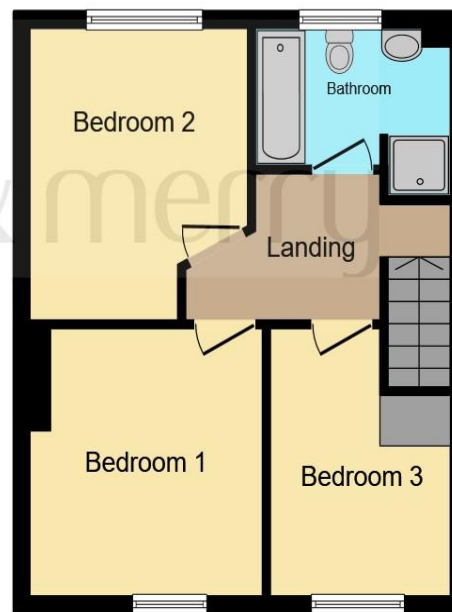

First Floor

Entrance Hall

Cloakroom

Lounge

14' 1" Plus Recess x 11' 3" To Max (4.29m Plus Recess x 3.43m To Max)

Kitchen

22' 11" To Max x 17' 7" To Max (6.99m To Max x 5.36m To Max)

Landing

Bedroom One

12' 3" To Max x 9' 1" To Max (3.73m To Max x 2.77m To Max)

Bedroom Two

10' 5" x 9' 9" To Max (3.17m x 2.97m To Max)

Bedroom Three

10' 4" To Max x 7' 7" To Max (3.15m To Max x 2.31m To Max)

Bathroom

Outside

Rear Garden

Parking

welcome to

Honeycross Road, HEMEL HEMPSTEAD

- Sought After Residential Area
- Three Bedroom Mid Terraced Family Home
- Very Well Presented Throughout
- Spacious Living Accommodation
- Large Modern Kitchen & Family Bathroom

Tenure: Freehold EPC Rating: C
Council Tax Band: D

offers in excess of

£450,000



Please note the marker reflects the
postcode not the actual property

view this property online [brownandmerry.co.uk/Property/HHD110218](https://www.brownandmerry.co.uk/Property/HHD110218)



Property Ref:
HHD110218 - 0003

1. MONEY LAUNDERING REGULATIONS Intending purchasers will be asked to produce identification documentation at a later stage and we would ask for your co-operation in order that there is no delay in agreeing the sale. 2. These particulars do not constitute part or all of an offer or contract. 3. The measurements indicated are supplied for guidance only and as such must be considered incorrect. Potential buyers are advised to recheck measurements before committing to any expense. 4. We have not tested any apparatus, equipment, fixtures or services and it is in the buyers interest to check the working condition of any appliances. 5. Where an EPC, or a Home Report (Scotland only) is held for this property, it is available for inspection at the branch by appointment. If you require a printed version of a Home Report, you will need to pay a reasonable production charge reflecting printing and other costs. 6. We are not able to offer an opinion either written or verbal on the content of these reports and this must be obtained from your legal representative. 7. Whilst we take care in preparing these reports, a buyer should ensure that his/her legal representative confirms as soon as possible all matters relating to title including the extent and boundaries of the property and other important matters before exchange of contracts.

Brown & Merry is a trading name of Sequence (UK) Limited which is registered in England and Wales under company number 4268443, Registered Office is Cumbria House, 16-20 Hockliffe Street, Leighton Buzzard, Bedfordshire, LU7 1GN. VAT Registration Number is 500 2481 05.



brown & merry



01442 232400



HemelHempstead@brownandmerry.co.uk



57 Marlowes, HEMEL HEMPSTEAD,
Hertfordshire, HP1 1LE



[brownandmerry.co.uk](https://www.brownandmerry.co.uk)