

BRENNAN

BESPOKE

OFFERS IN EXCESS OF

£400,000

Donnington Road

Kettering, NN15 5WN

PROPERTY SUMMARY

An impressive four bedroom detached home in Burton Latimer, offering generous and flexible living space, ideal for modern family life. The ground floor features three reception rooms, providing plenty of options for a separate lounge, playroom, home office or formal dining space. The kitchen diner is the heart of the home, perfect for everyday living and entertaining, and is supported by a useful utility room for added practicality.

Upstairs, there are four well proportioned bedrooms, with the main bedroom benefiting from its own ensuite, alongside a family bathroom. Outside, the property continues to impress with a beautifully landscaped rear garden, thoughtfully planted with colourful flowers and featuring a pond, along with a choice of seating areas to enjoy the sun throughout the day. Completing the package is a garage and parking, making this a fantastic all round family home in a popular location.

4



2



3





BRENNAN
BESPOKE

OFFICE ADDRESS
BRENNAN BESPOKE
2 The Tithe Barn Glendon Lodge Farm
Glendon
Kettering
Northamptonshire
NN14 1QF

OFFICE DETAILS
01536 904400
info@brennanbespoke.co.uk
<https://www.brennanbespoke.co.uk>

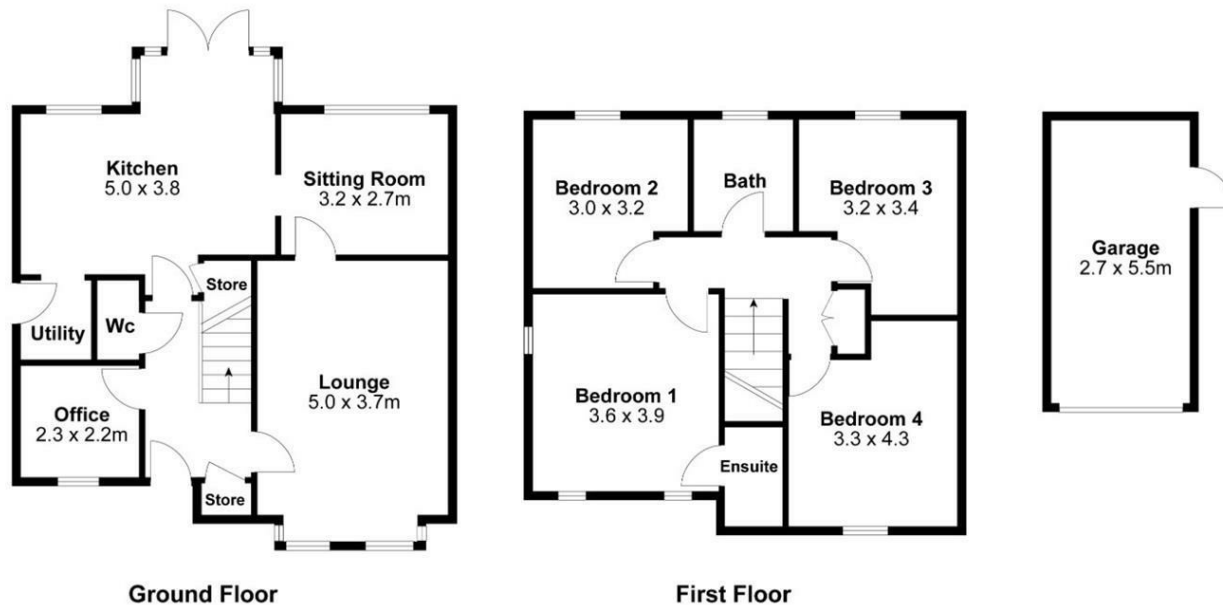

For identification only not to scale

Internal Area Approx. : 141m²

BRENNAN
BESPOKE

LOCAL AUTHORITY
North Northamptonshire

TENURE
Freehold

COUNCIL TAX BAND
E

VIEWINGS
By prior appointment only

Energy Efficiency Rating		
	Current	Potential
<i>Very energy efficient - lower running costs</i>		
(92 plus) A		
(81-91) B		
(69-80) C	80	83
(55-68) D		
(39-54) E		
(21-38) F		
(1-20) G		
<i>Not energy efficient - higher running costs</i>		
England & Wales	EU Directive 2002/91/EC	

Agents Note: Whilst every care has been taken to prepare these particulars, they are for guidance purposes only. All measurements are approximate and are for general guidance purposes only and whilst every care has been taken to ensure their accuracy, they should not be relied upon and potential buyers/tenants are advised to recheck the measurements