



Litchfield Close, Yaxley Peterborough
Offers in Excess of £220,000 Freehold

**Sharman
Quinney**

Key Features



- Flexible chalet style layout
- Bright and spacious lounge
- Situated in a quiet cul-de-sac
- Well maintained rear garden
- Driveway parking

Yaxley is a highly popular village located south of Peterborough, offering an excellent range of amenities including shops, schools, cafés, and public transport links. With easy access to Peterborough City Centre, the A1, and surrounding countryside, the village continues to be a favourite for families and commuters alike.

Entrance Hall

Lounge/ Dining Room

Kitchen

Bathroom

Bedroom 1



Bedroom 2

Bedroom 3



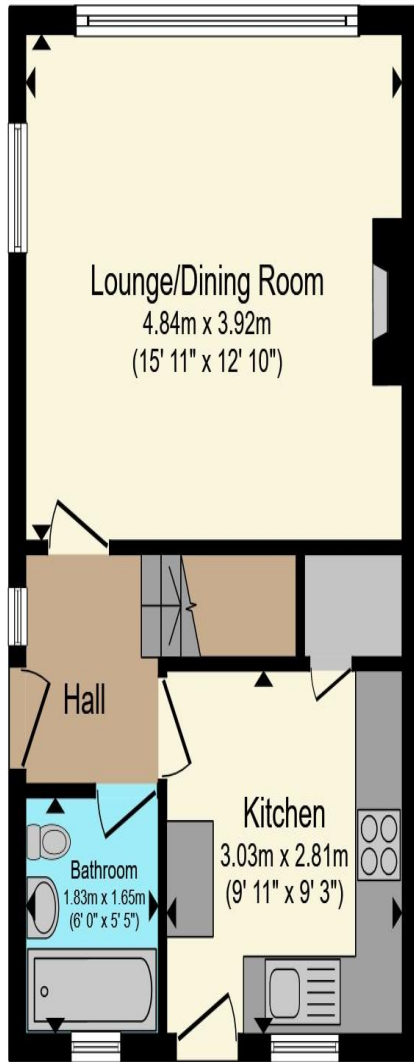

Ground Floor



First Floor

Total floor area 74.8 m² (805 sq.ft.) approx

This floor plan is for illustrative purposes only. It is not drawn to scale. Any measurements, floor areas (including any total floor area), openings and orientation are approximate. No details are guaranteed, they cannot be relied upon for any purpose and they do not form part of any agreement. No liability is taken for any error, omission or misstatement. A party must rely upon its own inspection(s). Powered by www.propertybox.io

**Sharman
Quinney**

To view this property call Sharman Quinney on:
01733 245400

Selling your property?

Contact us to arrange a **FREE** home valuation.

 01733 245400

 Unit 19 Maltings Square, Broadway Shopping Centre, Yaxley, Cambridgeshire, PE7 3EW

 yaxley@sharmanquinney.co.uk

 www.sharmanquinney.co.uk



 SCAN ME



Sharman Quinney Holdings Limited is registered in England and Wales under company number 4174227, Registered Office is Cumbria House, 16-20 Hockliffe Street, Leighton Buzzard, Bedfordshire, LU7 1GN. VAT Registration Number is 500 2481 05.

1: These particulars do not constitute part or all of an offer or contract. 2: The measurements indicated are supplied for guidance only and as such must be considered incorrect. 3: Potential buyers are advised to recheck the measurements before committing to any expense. 4: Sharman Quinney has not tested any apparatus, equipment, fixtures, fittings or services and it is the buyers interests to check the working condition of any appliances. 5: Sharman Quinney has not sought to verify the legal title of the property and buyers must obtain verification from their legal representative. 6: Intending purchasers will be asked to produce identification documentation at a later stage and we would ask your co-operation in order that there will be no delay in agreeing the sale. Ref: YAX203928 - 0001

