



OVER 60?

Secure this property
for up to **59% less!**

Price

£296,000

Leasehold

3x  1x  1x 

**Woodlands Road, Ilford,
Essex, IG1**

 **DOUGLAS
ALLEN**
Helping you move forwards



Main features

- Spacious first floor converted flat with off street parking
- Walking distance to Ilford Station/Elizabeth Line
- Ideal starter home for any first time buyers
- Close to Exchange Shopping Centre
- Chain Free

Accommodation

FIRST FLOOR

Entrance Hall

Lounge: 12'0 x 10'4 (3.66m x 3.15m)

Kitchen: 11'4 x 5'4 (3.46m x 1.63m)

Bedroom 1: 11'4 x 10'8 (3.46m x 3.25m)

Bedroom 2: 11'0 x 5'7 (3.36m x 1.70m)

Bedroom 3: 15'0 x 9'2 (4.58m x 2.80m)

Shower room

OUTSIDE

Off Street Parking

First Floor

Approx. 55.3 sq. metres (594.8 sq. feet)

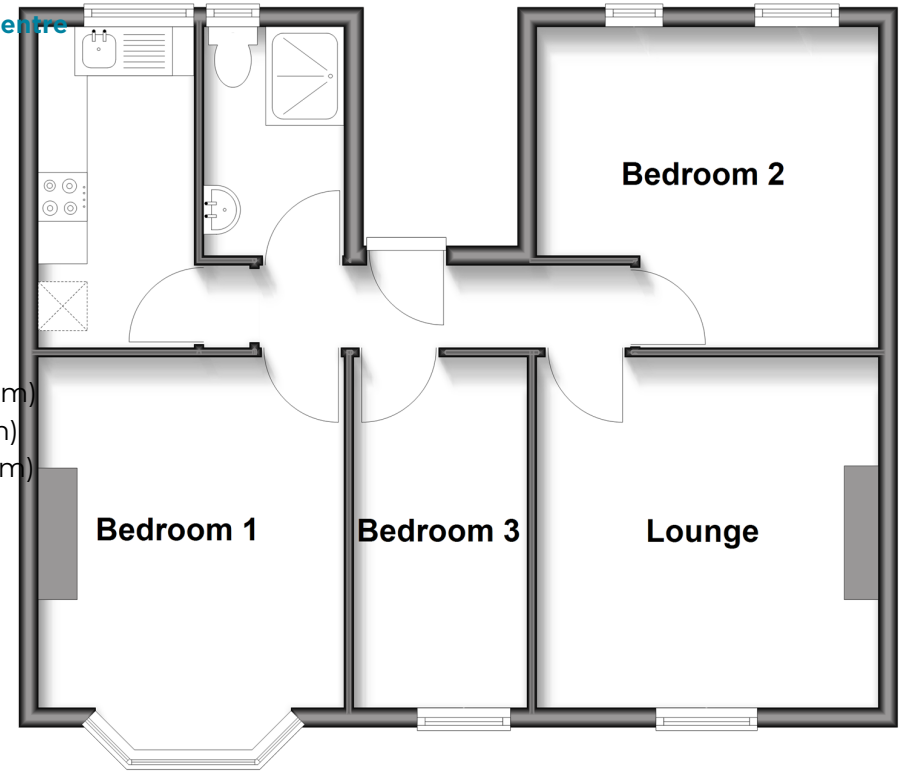

Call Ilford - 020 8518 0044 ■ douglasallen.co.uk

- Legal advice should be taken to verify fixtures/fittings, planning, alterations and/or lease details
- Appliances & services are untested, dimensions are approximate and floor plans are not to scale
- Through a Homewise Home For Life Plan people aged 60+ can secure this property for up to 59% less, by purchasing a Lifetime Lease



52003170/20260117/CN/NK