



SIBLEY PARES

CHARTERED SURVEYORS & ESTATE AGENTS

Douglas Road

Maidstone, Kent, ME16 8ER

NO ONWARD CHAIN
£280,000

Douglas Road

Maidstone, Kent, ME16 8ER

Key Features

- Two Bedroom Family Home
- No Onward Chain
- Double Glazing
- Gas Heating Via Radiators
- Upstairs bathroom
- Useful Cellar

Description

A spacious two double bedroom family home being sold with no onward chain.

The property comprises:

- 13'4 lounge with bay window
- Seperate 11'11 dining room
- Kitchen with doors to both garden and cellar
- 12'10 untanked cellar
- 13'2 master bedroom with built in cupboard
- 11'11 second bedroom
- Upstairs white bathroom suite
- Private rear garden, mainly laid to lawn
- Outdoor w.c.
- Parking is on road

- Heating: Mains gas
- Parking: on street



Douglas Road

Maidstone, Kent, ME16 8ER

Location

The property is situated opposite St Michaels Schools on Douglas Road. It is just a half mile walk to the shops and amenities within Lockmeadow Entertainment Centre, and is also just one mile walk to Maidstone Town Centre. Maidstone West Station is located within half a mile walk, offering high speed links to London.

■ EPC Rating D

■ Council Tax Band C

■ Maidstone Borough Council

■ For Broadband Speed Refer to Ofcom Website

For all Viewings and Enquiries contact:



Mark Yelverton

mark.yelverton@sibleypares.co.uk



Marcus Monger

marcus.monger@sibleypares.co.uk



SIBLEY PARES

CHARTERED SURVEYORS & ESTATE AGENTS

01622 673086

sibleypares.co.uk





Score	Energy rating	Current	Potential
92+	A		
81-91	B		
69-80	C		79 C
55-68	D	56 D	
39-54	E		
21-38	F		
1-20	G		

Floorplan and Dimensions

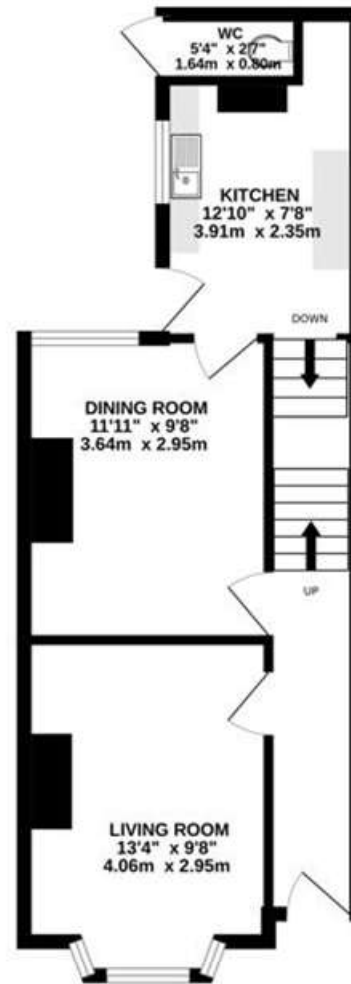
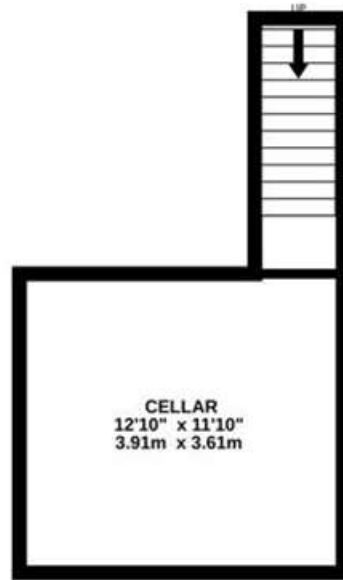

TOTAL FLOOR AREA : 991 sq.ft. (92.0 sq.m.) approx.

Whilst every attempt has been made to ensure the accuracy of the floorplan contained here, measurements of doors, windows, rooms and any other items are approximate and no responsibility is taken for any error, omission or mis-statement. This plan is for illustrative purposes only and should be used as such by any prospective purchaser. The services, systems and appliances shown have not been tested and no guarantee as to their operability or efficiency can be given.
Made with Metropix ©2026

NOTE: Rental, prices or any other charges are inclusive of VAT unless otherwise stated.
MISREPRESENTATION ACT 1967. These particulars are believed to be correct, their accuracy cannot be guaranteed and are expressly excluded from any other contract. Any intending purchaser must satisfy himself by inspection or otherwise as to the correctness of each of the statements contained in these particulars. No fittings, appliances or services mentioned have been tested by Sibley Pares. Please note that in accordance with Money Laundering Regulations, we are now required to obtain proof of identity for purchasers.



1 Ashford Road, Maidstone, Kent ME14 5BJ
sibleypares.co.uk | Maidstone (01622) 673086 | Ashford (01233) 629281

Partners: Sarah Raggett, BSc (Hons) MRICS | Phillip Hubbard, BA (Hons) MRICS
Sibley Pares Chartered Surveyors is a trading name of Sibley Pares LLP

Registered in England and Wales No: OC400776. | Registered as above. | VAT Reg No: 218 5130 30.