



## GREYHOUND ROAD, W6

£650,000

Two bedrooms  
Long lease  
Upper maisonette  
Over 1200 sq ft  
Own front door  
High ceilings

@marshandparsons  
marshandparsons.co.uk

MARSH &  
PARSONS



# ABOUT THE PROPERTY

A charming two-bedroom period apartment offering bright, well-proportioned living space in a highly desirable West London location. Blending classic character with modern convenience.

Situated in a vibrant residential neighbourhood, Greyhound Road benefits from some great amenities.

A comfortable walk to both Hammersmith Station (District, Piccadilly, Hammersmith & City lines) and Barons Court Station (Piccadilly and District lines)

Moments from everyday conveniences including Waitrose, Sainsbury's, and local cafes.



# STEP INSIDE GREYHOUND ROAD

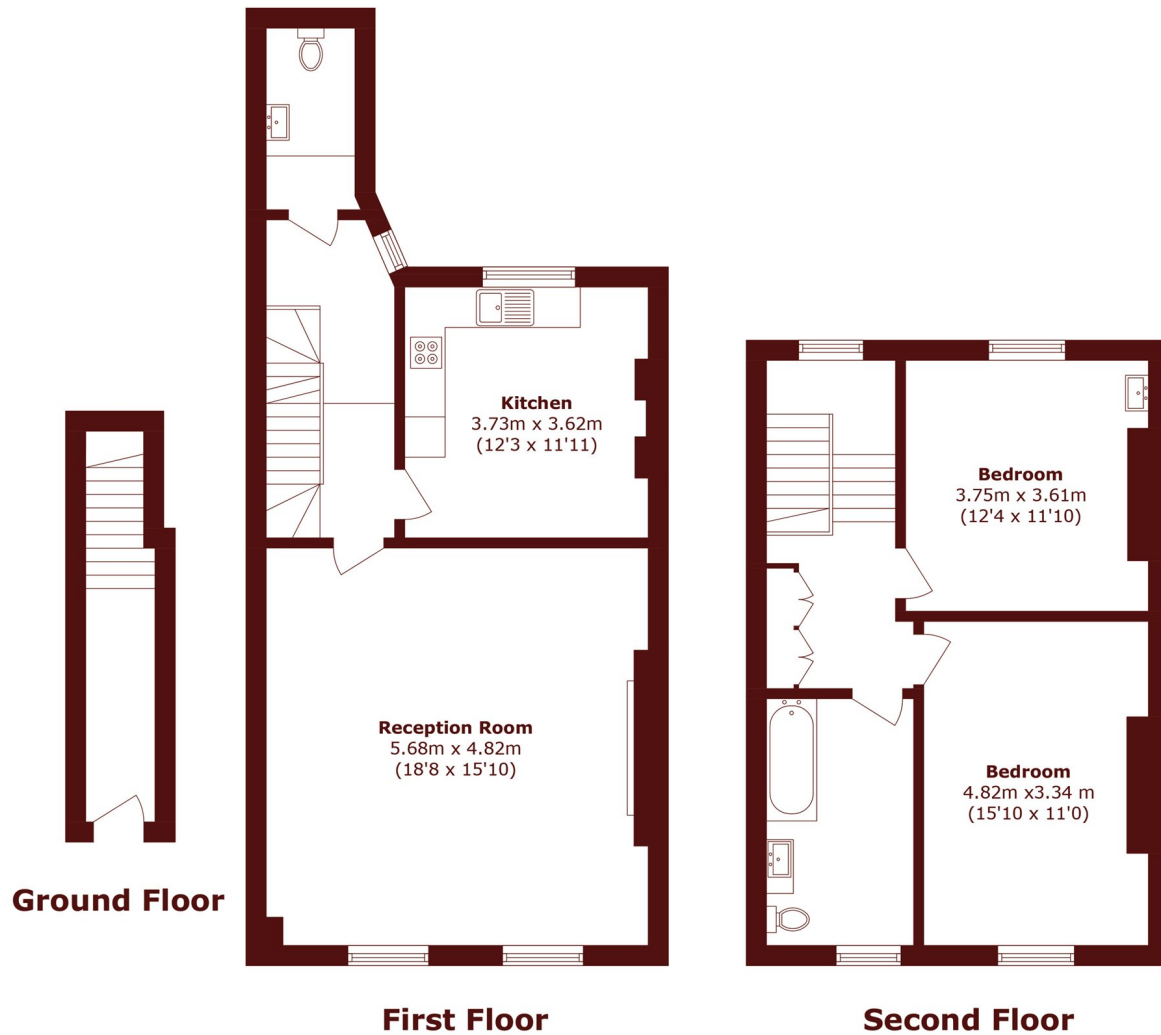

Total area (approx.): 116.7 sq. m (1256.5 sq. ft)

**Bishops Park**  
020 7993 9888

Energy Rating: We aim to make our particulars both accurate and reliable. However, they are not guaranteed; nor do they form part of an offer or contract. If you require clarification on any points then please contact us, especially if you're traveling some distance to view. Please note that appliances and heating systems have not been tested and therefore no warranties can be given as to their good working order

**MARSH &  
PARSONS**