

**MANOR**

354 BETHNAL GREEN ROAD  
LONDON | E2 0AH



Nestled in the vibrant area of Bethnal Green Road, London, this delightful one-bedroom flat offers a perfect blend of comfort and style. This penthouse apartment boasts bright interiors, creating an airy and spacious atmosphere.

The property comes with a share of freehold and easy access to local amenities and great transport links.

This flat is perfect for first-time buyers or those seeking a stylish city pad in a lively neighbourhood. With its bright and spacious design, it presents an excellent opportunity to enjoy the best of London living.





Approximate Gross Internal Area 466 sq ft - 43 sq m

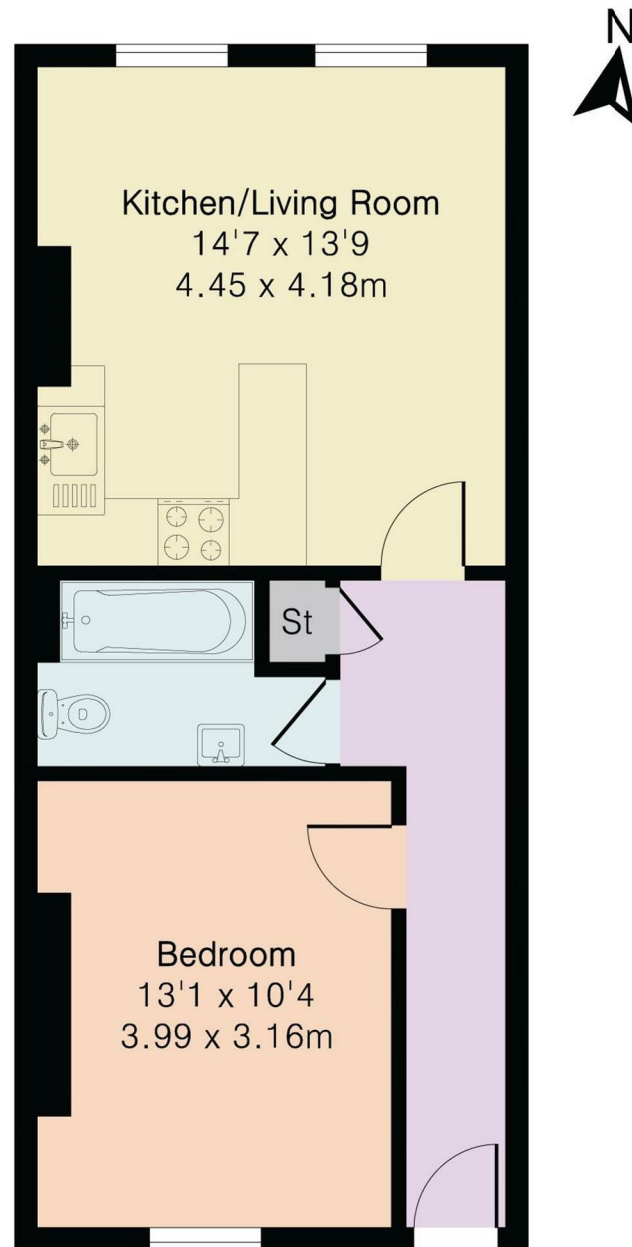

Third Floor





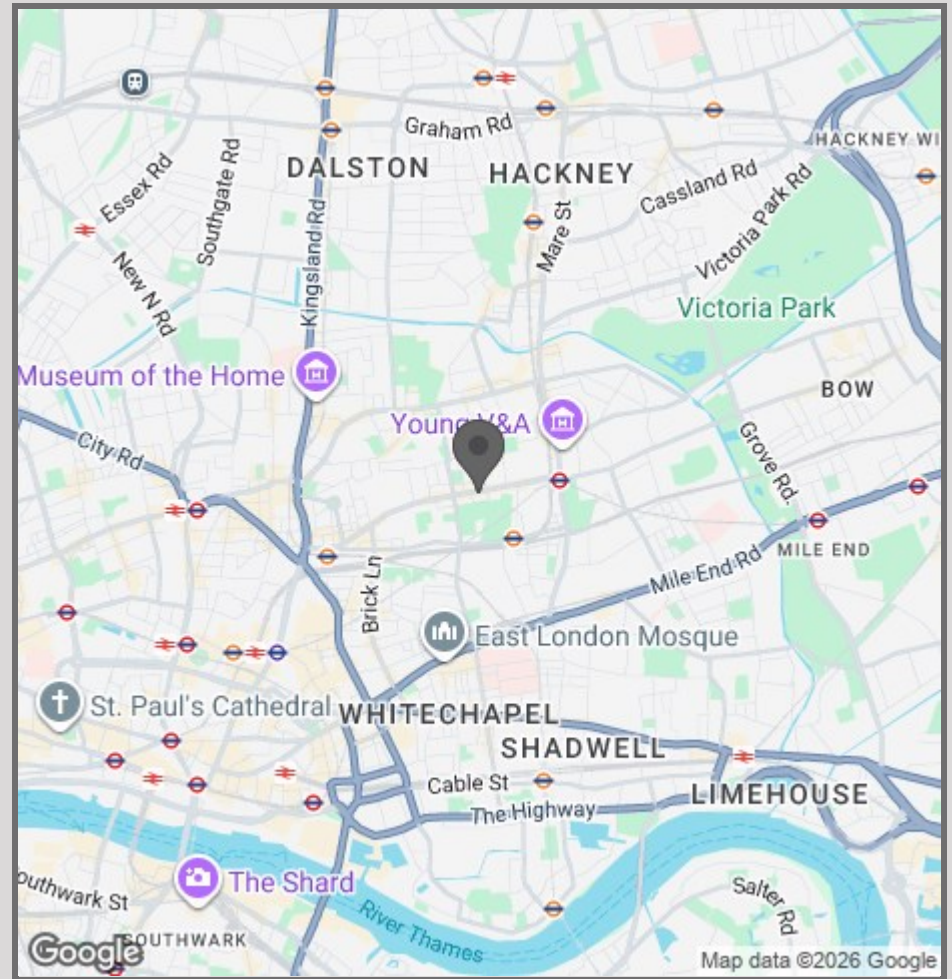

42 High Street  
Woodstock  
OX20 1TG

01865 955500

hello@manoroxford.com

www.manoroxford.com

MANOR

Approximate Gross Internal Area 466 sq ft - 43 sq m

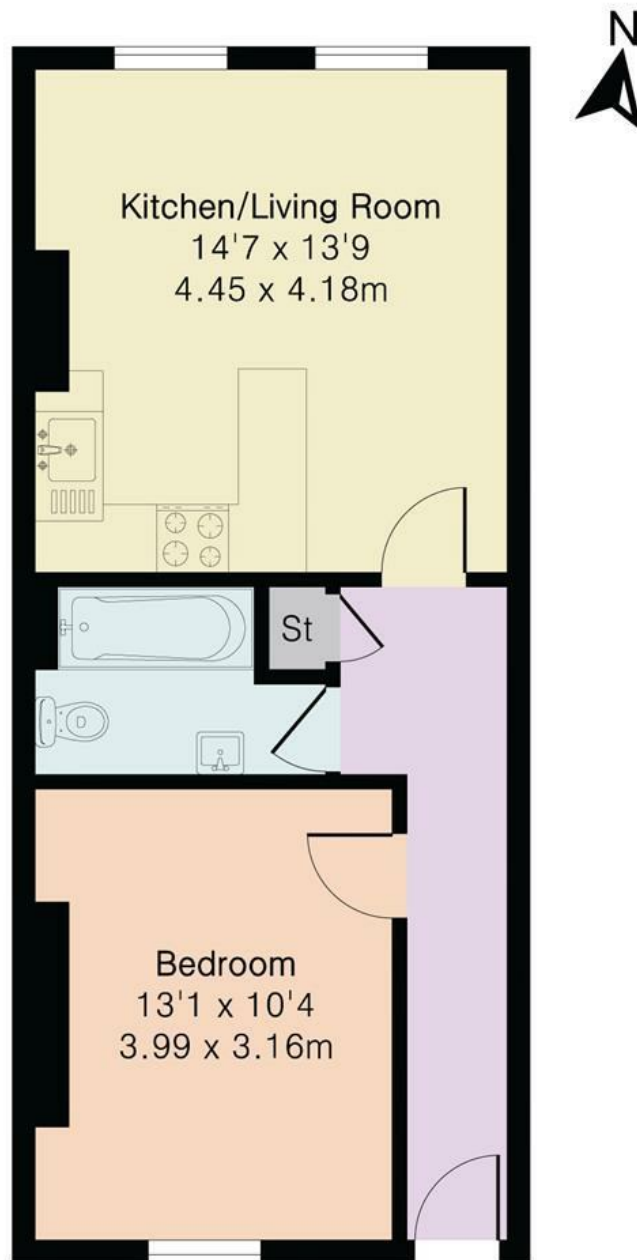

Third Floor



**MANOR**