



MARCO HARRIS  
THE PROPERTY PROFESSIONALS

# Southampton Road, Eastleigh, SO50 5QJ

Guide Price £220,000

🛏 2 🚿 2 🚗 1



- Ideal purchase for first-time buyers, downsizers, or investors alike
- Spacious open-plan lounge/dining area filled with natural light
- Principal bedroom with stylish three-piece en-suite shower room
- Covered allocated parking space with electric vehicle charging point
- Close to Lakeside Country Park
- Two-bedroom, two-bathroom ground floor apartment with private entrance
- Contemporary fitted kitchen with ample storage and workspace
- Well-proportioned second bedroom; perfect as a guest room or home office
- Excellent location in Eastleigh with superb transport links
- EPC Rating: C



Ideally situated along Southampton Road, this modern two-bedroom, two-bathroom apartment offers stylish, low-maintenance living, perfectly suited to first-time buyers, downsizers, or investors alike. With the added benefit of allocated parking and a private electric vehicle charging point, this home combines convenience with forward-thinking features.

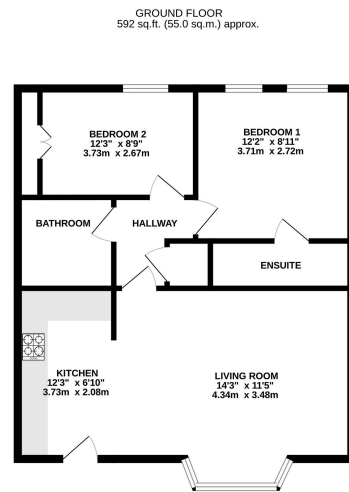

TOTAL FLOOR AREA: 592 sq.ft. (55.0 sq.m.) approx.  
While every effort has been made to ensure the accuracy of the floor plan, measurements are approximate and should not be relied upon for any legal or financial purposes. The floor plan is provided for information only and does not constitute an offer of any property. All dimensions are given in feet and inches. The floor plan is provided for information only and does not constitute an offer of any property. All dimensions are given in feet and inches.

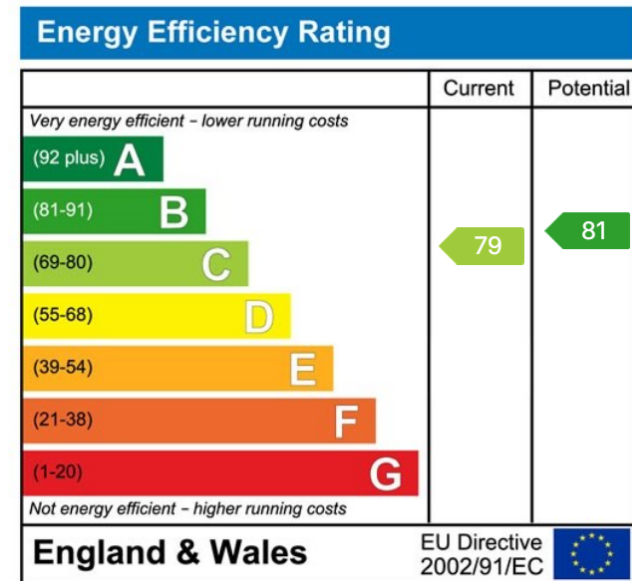

Website: [marcoharris.co.uk](http://marcoharris.co.uk)

Email: [lettings@marcoharris.co.uk](mailto:lettings@marcoharris.co.uk) // [sales@marcoharris.co.uk](mailto:sales@marcoharris.co.uk)

Phone: 02381 733330