



## COLLARD PLACE, NW1

£1,350,000

Renovated three bedroom home  
Gated development  
No onward chain  
South facing rear garden  
Fitted with air conditioning  
Garage

@marshandparsons  
marshandparsons.co.uk

MARSH &  
PARSONS



# ABOUT THE PROPERTY

A tastefully renovated three-bedroom home set within a gated development near Camden Town. This stylish townhouse features a spacious living and dining area, a separate kitchen, two bathrooms, a private rear garden, utility room and a garage. The property also benefits from planning approval for a loft conversion and is already equipped with electrics and plumbing, making it ideal for future expansion.

Collard Place is a private gated development just off Harmood Street in Camden. It's ideally located moments from Camden Lock and Camden station, while the beautiful open spaces of Hampstead Heath are just over a mile away.



# STEP INSIDE COLLARD PLACE

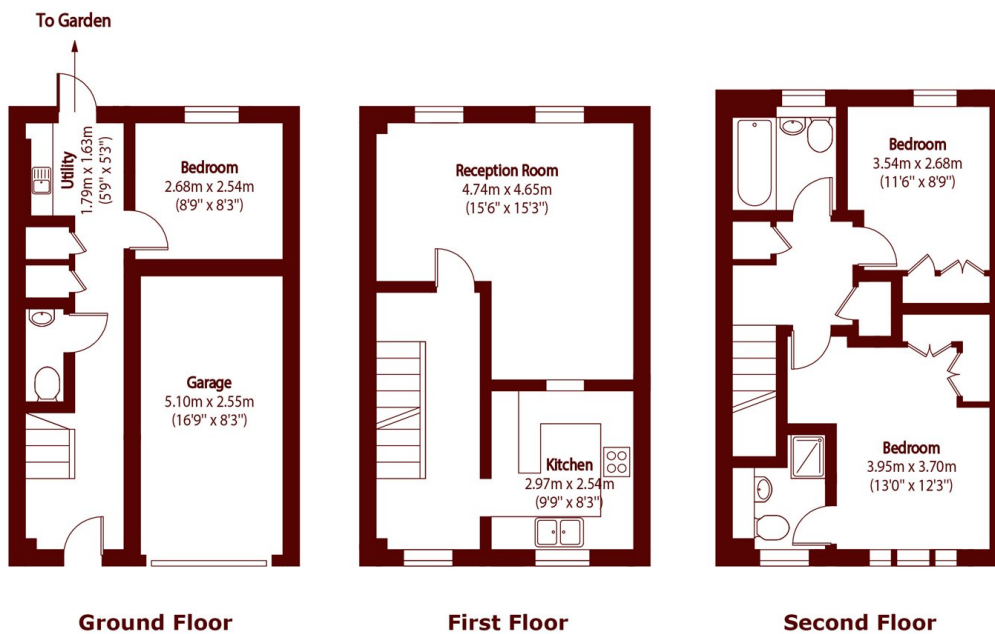

Total area (approx): 111.61 sq m (1201 sq. ft)

Garage total area (approx): 13.26 sq m (143 sq. ft)

**Camden**  
020 7244 2200

Energy Rating: C We aim to make our particulars both accurate and reliable. However, they are not guaranteed; nor do they form part of an offer or contract. If you require clarification on any points then please contact us, especially if you're traveling some distance to view. Please note that appliances and heating systems have not been tested and therefore no warranties can be given as to their good working order

**MARSH &  
PARSONS**