



Guide Price
£190,000

**Share of
Freehold**

1x 🏠 1x ↻ 1x 🚗

**Canterbury Road,
Croydon, Surrey, CR0**

OVER 60?

Secure this property
for up to **59% less!**

cubitt & west
Helping you move forwards



Main features

- Beautifully presented ground floor period conversion
- Chain Free - Ideal for first-time buyers, downsizing, or investors
- Joint Freehold arrangement with other flat owners
- Close to local Amenities
- Excellent transport options

Accommodation

GROUND FLOOR

Lounge / Kitchen Diner: 22'3 x 8'8
(6.79m x 2.64m)

Bedroom: 11'11 x 11'6 (3.63m x 3.51m)

Bathroom: 6'1 x 5'4 (1.86m x 1.63m)

OUTSIDE

Communal Gardens

Ground Floor

Approx. 40.5 sq. metres (436.0 sq. feet)

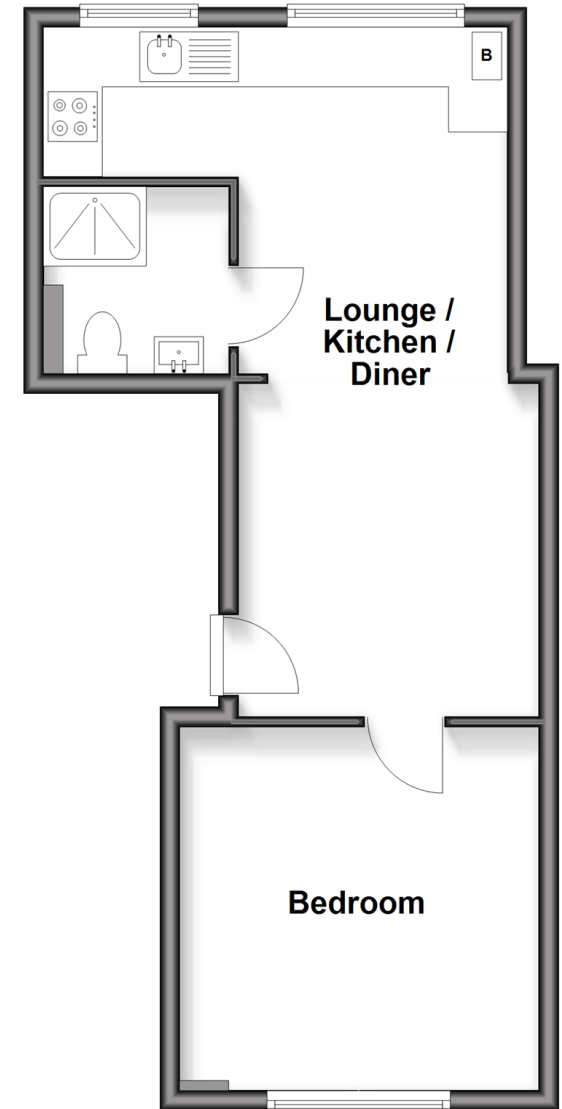

Call Shirley - 020 8654 3037 ■ cubittandwest.co.uk

- Legal advice should be taken to verify fixtures/fittings, planning, alterations and/or lease details
- Appliances & services are untested, dimensions are approximate and floor plans are not to scale
- Through a Homewise Home For Life Plan people aged 60+ can secure this property for up to 50% less, by purchasing a Lifetime Lease.



21712108/20251106/SR/PH