



Whiteheads Grove, SW3

£995,000

A bright and well-arranged one bedroom apartment moments from Chelsea Green. Located on the third floor (with lift) and benefitting from a share of the freehold, this property would be a fantastic pied-à-terre.

Cranmer Court is a portered, purpose-built block on Whiteheads Grove. Pavilion Road, Sloane Square and South Kensington are all a short distance away,

Features

- Share of Freehold
- Porters
- Lift
- Bay Windows
- One Bedroom
- Separate Kitchen

Whiteheads Grove, London, SW3

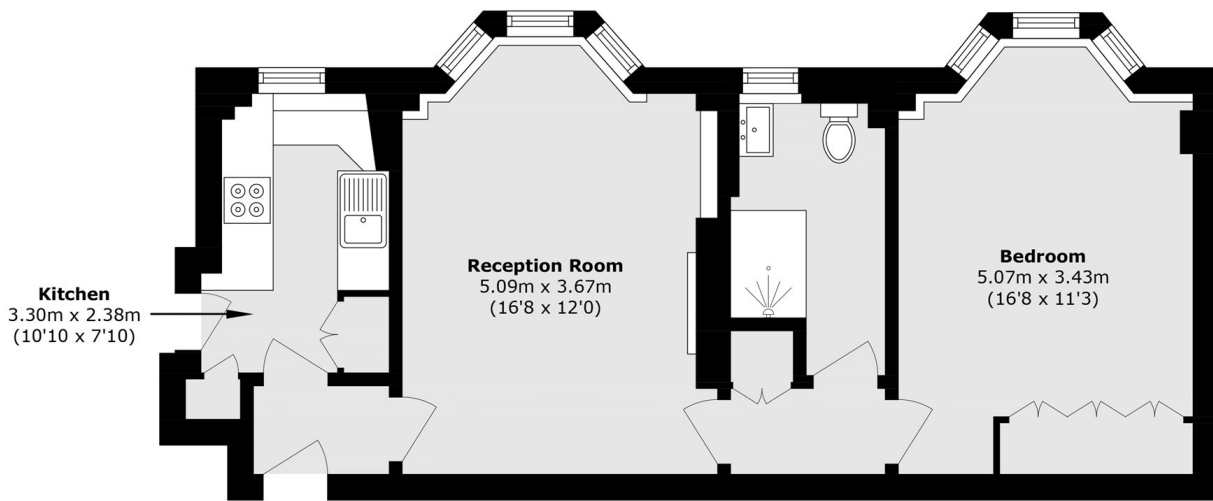

Third Floor

Total area (approx.): 52.3 sq. m (562.9 sq. ft)