

BRUNTON

RESIDENTIAL

APARTMENT No's
26,27,28,29,30,31,32,33

CITADEL EAST, KILLINGWORTH, NEWCASTLE UPON TYNE

Offers Over £95,000

BRUNTON

RESIDENTIAL





BRUNTON

RESIDENTIAL



BRUNTON

RESIDENTIAL



Brunton Residential are delighted to bring to market this fantastic two bedroom apartment, situated on the second floor of the popular Regency Apartments. This apartment offers ideal space for a professional or first time buyer and is situated within a short walk away from Killingworth Shopping Centre where you will find a central bus station, shops, bars and restaurants.

BRUNTON

RESIDENTIAL



BRUNTON

RESIDENTIAL

Brunton Residential are delighted to offer this second-floor apartment located on Regency apartments in Killingworth. This two bedroom property offers excellent value for money and would be suitable for a professional couple or individual.

Accommodation briefly comprises; entrance hallway with access to all rooms including; lounge, separate kitchen, bedroom one, bedroom two, and a bathroom WC. Externally there are a range of managed areas including planted & garden areas along with ample allocated parking facilities. For more info and for viewings, please call our team on 01912368347.

BRUNTON

RESIDENTIAL

TENURE : Leasehold

LOCAL AUTHORITY : North Tyneside

COUNCIL TAX BAND : A

EPC RATING : B

Second Floor

Approx. 55.4 sq. metres (596.2 sq. feet)

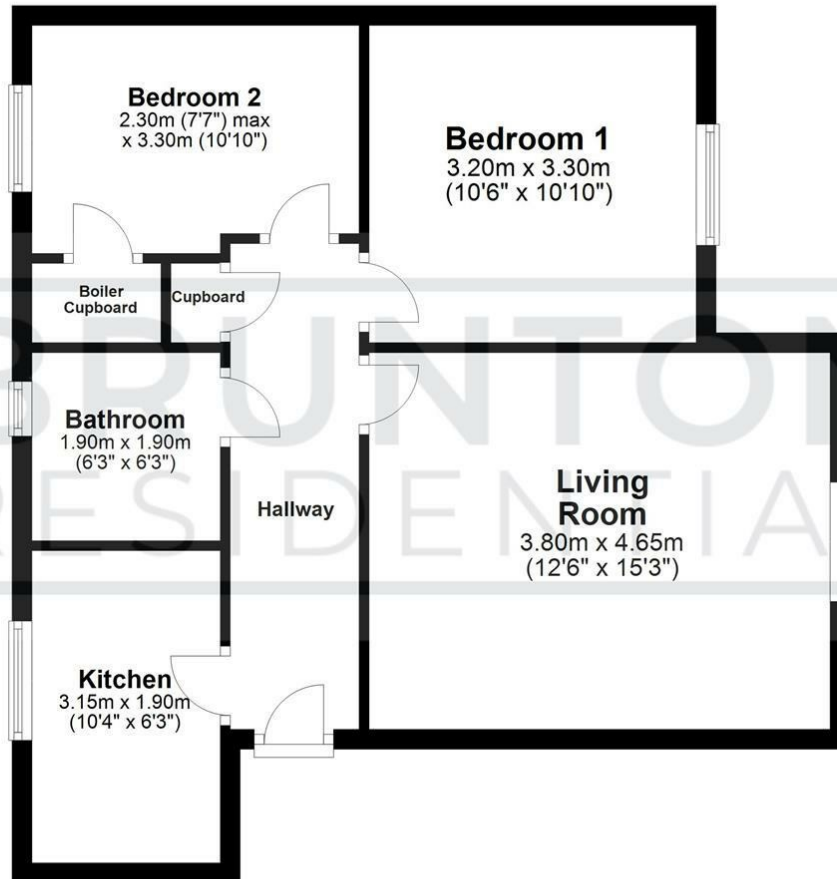

All measurements are approximate and are for illustration only.
Plan produced using PlanUp.

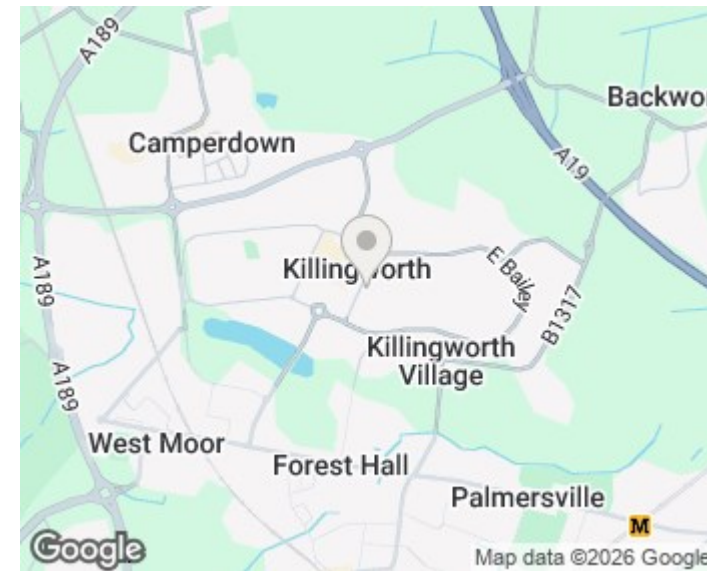

Energy Efficiency Rating		Current	Potential
Very energy efficient - lower running costs			
(92 plus) A			
(81-91) B			
(69-80) C			
(55-68) D			
(39-54) E			
(21-38) F			
(1-20) G			
Not energy efficient - higher running costs			
		81	85
England & Wales		EU Directive 2002/91/EC	

Environmental Impact (CO ₂) Rating		Current	Potential
Very environmentally friendly - lower CO ₂ emissions			
(92 plus) A			
(81-91) B			
(69-80) C			
(55-68) D			
(39-54) E			
(21-38) F			
(1-20) G			
Not environmentally friendly - higher CO ₂ emissions			
England & Wales		EU Directive 2002/91/EC	