



TO LET

2 Bed Apartment in Long Roses Way, Birstall, LE4 3NH
£900 pcm

First floor apartment to rent on this popular development in Birstall. The park and ride services are within walking distance the property is also very close to a selection of road networks. The accommodation comprises communal hall, entrance hall, lounge, kitchen, two bedrooms, bathroom and allocated parking space. Sorry, pets cannot be considered for this property.



GROUND FLOOR
533 sq.ft. (49.5 sq.m.) approx.

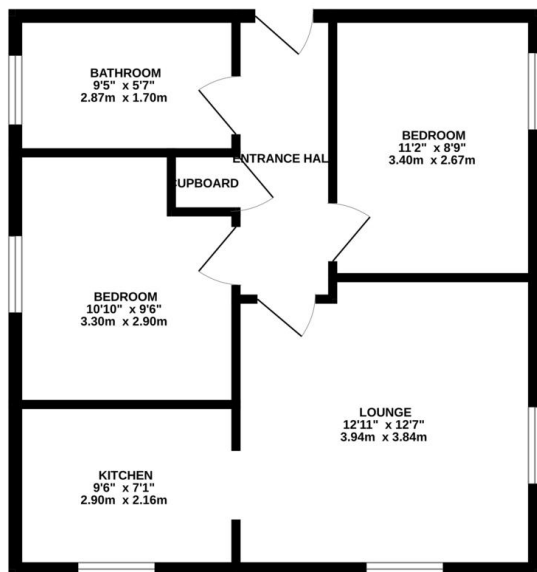

TOTAL FLOOR AREA: 533 sq.ft. (49.5 sq.m.) approx.
Whilst every effort has been made to ensure the accuracy of the figures contained here, measurements of floors, windows, rooms and any other items are approximate and no responsibility is taken for any error, omission or mis-statement. This plan is for illustrative purposes only and should be used as such by any prospective purchaser. The services, systems and appliances shown have not been tested and no guarantee as to their operability or efficiency can be given.
Made with floorplan 12/2020

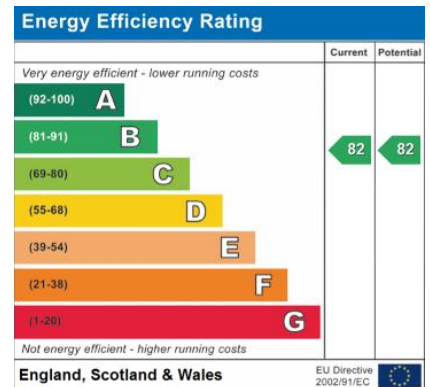

- Long Term Let
- First Floor
- Apartment
- Allocated Parking Space
- Two Bedrooms
- Gas Central Heating
- Convenient Location
- Professional Let

Agents Note: Whilst every care has been taken to prepare these sales particulars, they are for guidance purposes only. All measurements are approximate are for general guidance purposes only and whilst every care has been taken to ensure their accuracy, they should not be relied upon and potential buyers are advised to recheck the measurements.

