



£110,000

OFFERS IN EXCESS OF
MORRIS STREET
NETHERFIELD

- TWO BEDROOMS
- OPEN PLAN LIVING/KITCHEN
- BATHROOM
- SECURE PARKING
- NO CHAIN
- EPC C



Spacious Two-Bedroom Apartment with Secure Parking

LESLEY GREAVES ARE DELIGHTED TO PRESENT THIS WELL-PROPORTIONED TWO-BEDROOM APARTMENT, IDEALLY SITUATED IN THE HIGHLY SOUGHT-AFTER AREA OF NETHERFIELD. CONVENIENTLY LOCATED WITHIN WALKING DISTANCE OF NETHERFIELD RETAIL PARK, A VARIETY OF SHOPS, RESTAURANTS AND EXCELLENT TRANSPORT LINKS, THIS PROPERTY OFFERS BOTH COMFORT AND ACCESSIBILITY.

SITUATED ON THE SECOND FLOOR, THE APARTMENT BOASTS A SPACIOUS ENTRANCE HALLWAY WITH USEFUL STORAGE, LEADING INTO A BRIGHT AND AIRY OPEN-PLAN LIVING/KITCHEN AREA PERFECT FOR MODERN LIVING. THE KITCHEN IS WELL-EQUIPPED WITH A RANGE OF WALL AND BASE UNITS, COMPLEMENTED BY AN OVEN, HOB WITH EXTRACTOR, FRIDGE AND DISHWASHER, OFFERING BOTH STYLE AND PRACTICALITY.

THERE ARE TWO GENEROUSLY SIZED DOUBLE BEDROOMS AND A WELL-APPOINTED BATHROOM, MAKING THE PROPERTY IDEAL FOR PROFESSIONALS, COUPLES OR SMALL FAMILIES.

EXTERNALLY, THE PROPERTY BENEFITS FROM SECURE GATED PARKING TO THE REAR AND AN INTERCOM ENTRY SYSTEM, PROVIDING ADDED CONVENIENCE AND PEACE OF MIND.

OFFERED TO THE MARKET WITH NO ONWARD CHAIN, EARLY VIEWING IS HIGHLY RECOMMENDED TO FULLY APPRECIATE THE SPACE AND LOCATION.

LENGTH OF LEASE REMAINING: 104 YEARS

GROUND RENT £100,00 PER ANNUM

SERVICE CHARGE £1021.00 PER ANNUM

- LEASEHOLD
- COUNCIL TAX; BAND B
- LOCAL AUTHORITY; GEDLING BOROUGH COUNCIL
- MEASUREMENTS; 68 SQ METERS
-

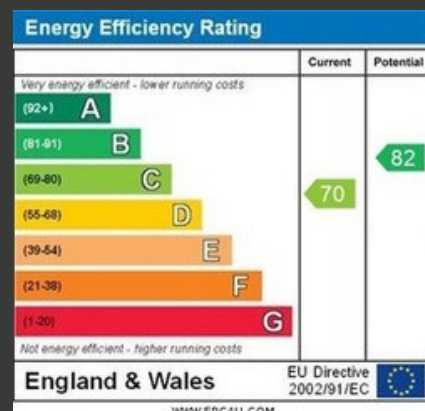



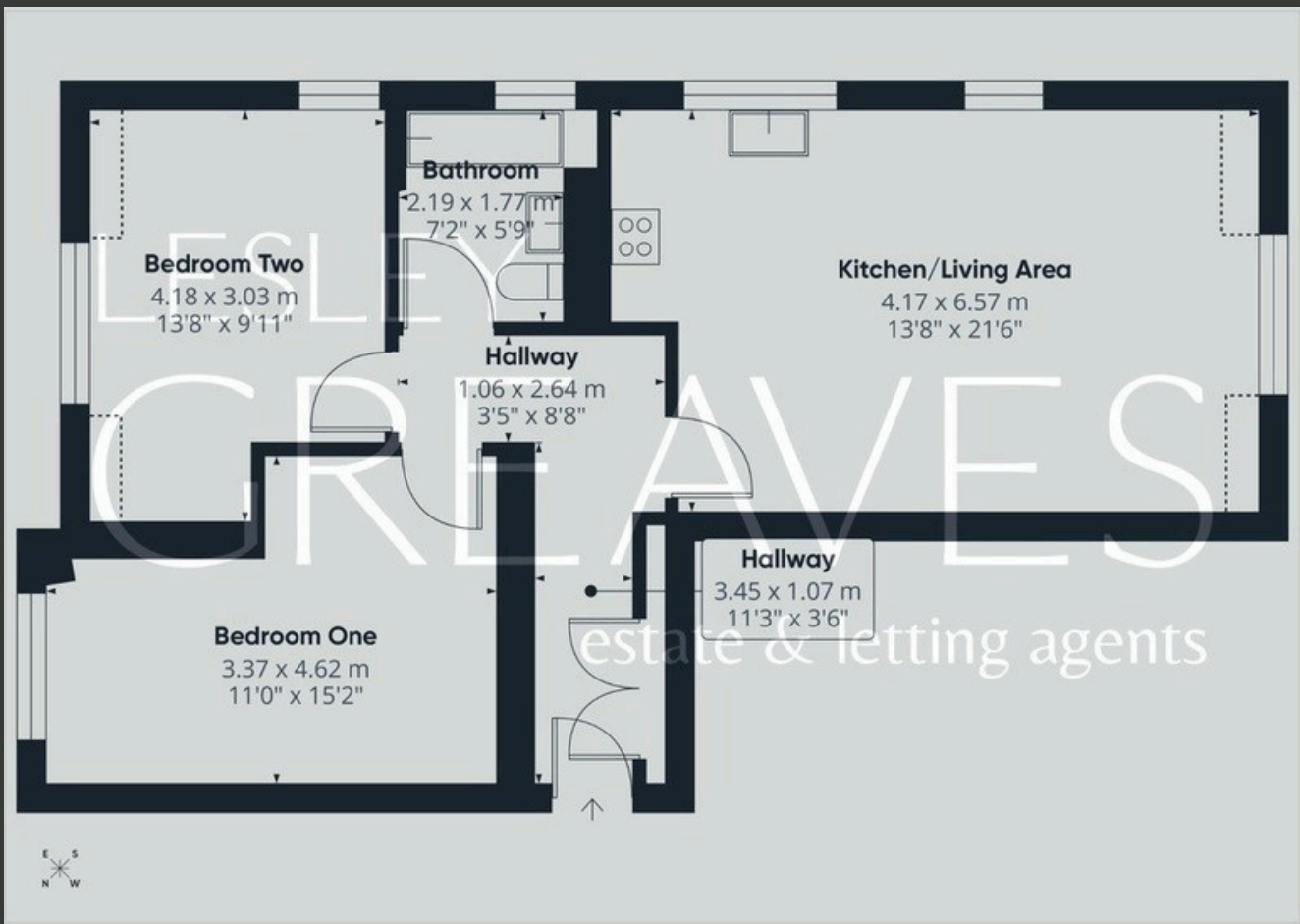

Agent's Note: These particulars have been prepared in good faith and are provided for guidance purposes only. While every effort has been made to ensure their accuracy, they should not be relied upon as exact. All measurements are approximate, and floor plans are for illustrative purposes only. Prospective buyers or tenants are advised to verify all details independently, conduct their own due diligence, and note that services, systems, and appliances have not been tested.

Lesley Greaves Estate & Lettings Agents

22 Main Road ,Gedling, Nottingham, NG4 3HP

0115 9877337

sales@lesleygreaves.co.uk