





MALLINSON
& CO

INNOVATIVE PROPERTY EXPERTS

Millstones, Oxspring, Sheffield, S36 8WZ

Offers Over £699,995

 5  3  3



- EXECUTIVE STONE BUILT DETACHED
- 3 RECEPTION ROOMS
- 2 EN SUITES TO BEDROOMS, 1 BATHROOM & DOWNSTAIRS W.C.
- LANDSCAPED GARDENS
- INTEGRAL DOUBLE GARAGE, DRIVEWAY & OFF STREET PARKING FOR SEVERAL VEHICLES
- 5 BEDROOMS
- BESPOKE OPEN PLAN KITCHEN & UTILITY
- HIGH QUALITY FIXTURES & FITTINGS
- SOUGHT AFTER LOCATION
- CLOSE TO AMENITIES, SCHOOLING & TRANSPORT LINKS



SIMPLY OUTSTANDING! LOCATED WITHIN THIS HIGHLY REGARDED AND SOUGHT-AFTER DEVELOPMENT IN OXSPRING, THIS BEAUTIFULLY APPOINTED FIVE BEDROOM EXECUTIVE STYLE DETACHED HOME OFFERS EXTENSIVE AND VERSATILE LIVING ACCOMMODATION. POSITIONED IN A SMALL AND QUIET CUL-DE-SAC OF JUST FOUR PROPERTIES, THE HOME ENJOYS A PLEASANT OUTLOOK, AMPLE OFF-STREET PARKING AND A DOUBLE INTEGRAL GARAGE. WITH BESPOKE KITCHEN, THREE RECEPTION ROOMS AND TWO EN SUITE FACILITIES, THE PROPERTY IS IDEALLY SUITED TO THE FAMILY PURCHASER. WELL SERVED BY LOCAL SCHOOLING AND AMENITIES, WITHIN EASY REACH OF THE VILLAGE PUBLIC HOUSE, OPEN COUNTRYSIDE AND EXCELLENT COMMUTER LINKS, THIS IS A MUST-SEE PROPERTY AND EARLY VIEWING IS STRONGLY ADVISED

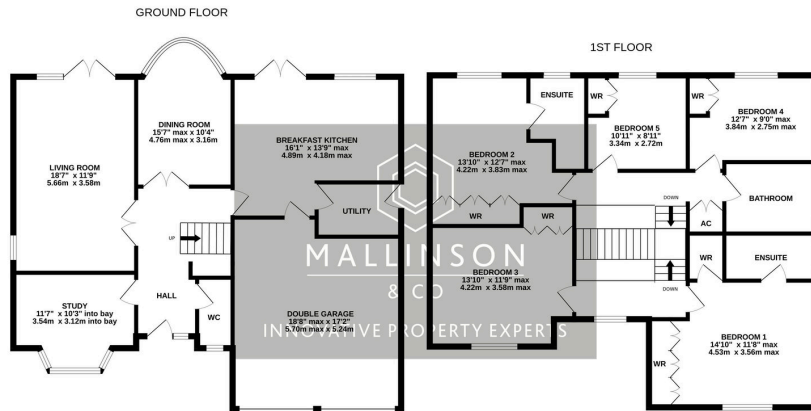

TOTAL FLOOR AREA : 2124 sq.ft. (197.3 sq.m.) approx.
 Whilst every attempt has been made to ensure the accuracy of the floorplan contained here, measurements of doors, windows, rooms and any other items are approximate and no responsibility is taken for any error, omission or mis-statement. This plan is for illustrative purposes only and should be used as such by any prospective purchaser. The services, systems and appliances shown have not been tested and no guarantee as to their operability or efficiency can be given.
 Made with Metropix ©2018

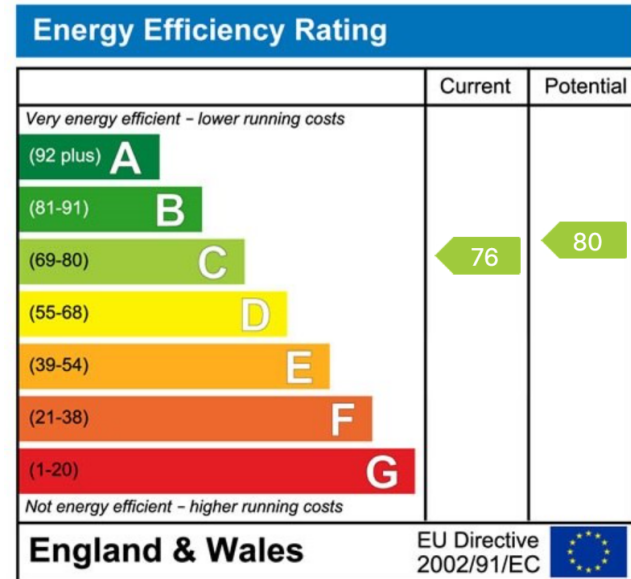

INNOVATIVE
PROPERTY
EXPERTS

Mallinson & Co

Office: 01226 414 150

Email: ben@mallinsonandco.co.uk

Web: www.mallinsonandco.co.uk

Suite 6, Penistone 1, St. Mary's Street, Penistone, S36 6DT