

29 Aylesby Court 487 Wilbraham Road, Chorlton, Manchester, M21 0US



**JP&Brimelow**  
ESTATE AGENTS



# Offers In The Region Of £175,000

 1  1  1  c

\*\*\*VIDEO TOUR AVAILABLE\*\*\* A bright and stylishly presented one double-bedroom, ground-floor apartment set within this popular purpose-built development on Wilbraham Road, Chorlton. Ideally positioned just a few minutes' walk from the St Werburgh's Road Metrolink station, offering convenient access to Manchester City Centre and MediaCity. The well-designed accommodation includes a communal entrance hallway, private entrance hall, spacious lounge/dining area, a white fitted kitchen, double bedroom, and a three-piece shower room. Additional benefits include electric heating, off-road parking, and attractive, well-maintained communal lawned gardens. An ideal home for a first-time buyer or professional couple. Early viewing is highly recommended.







## EPC Chart

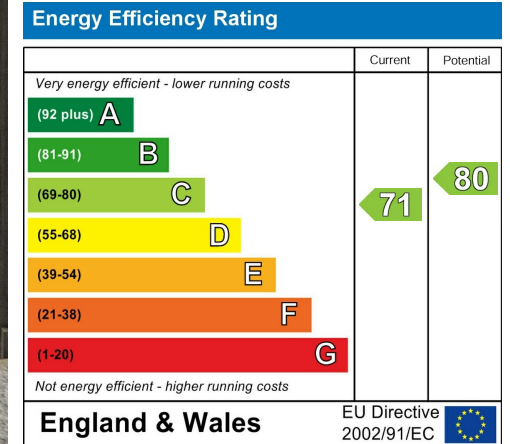

Tenure: **Leasehold** Council Tax Band: **A**

## Ground Floor

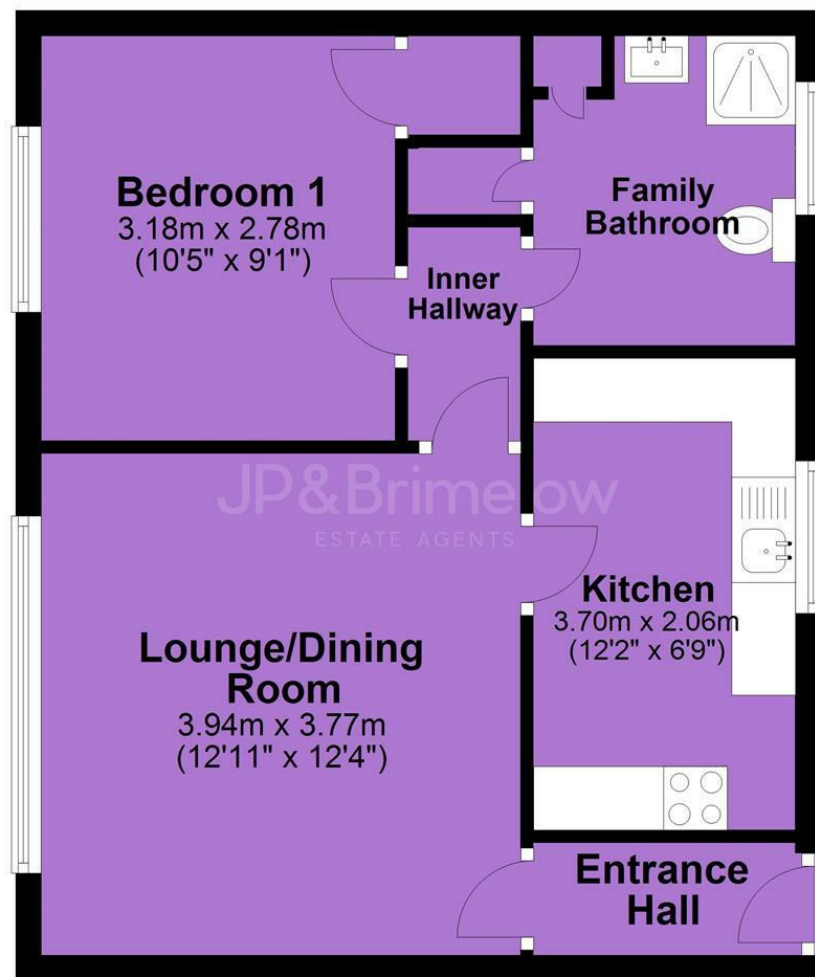

JP & Brimelow Estate Agents Ltd  
430 Barlow Moor Road, Manchester, M21 8AD  
Tel: 0161 8822233  
E: sales@jpbrimelow.co.uk www.jpandbrimelow.co.uk

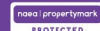

**JP & Brimelow**  
ESTATE AGENTS

NOTICE: JP & Brimelow Estate Agents Ltd for themselves and for the vendors or lessors of this property whose agents they are give notice that:

- (i) the particulars are set out as a general outline only for the guidance of intending purchasers or lessees, and do not constitute, nor constitute part of, an offer or contract;
- (ii) all descriptions, dimensions, references to the condition and necessary permissions for use and occupation, and other details are given in good faith and are believed to be correct but any intending purchasers or tenants should not rely on them as statements or representations of fact but must satisfy themselves by inspection or otherwise as to the correctness of each of them;
- (iii) no person in the employment of JP & Brimelow Estate Agents Ltd has any authority to make or give any representation or warranty whatever in relation to this property.

jpandbrimelowstateagents

@jpandbrimelow