



St. Johns Court | | Felixstowe | IP11 7SG

Guide Price £100,000

NICHOLAS
ESTATES

Key features

- No Onward Chain
- Second Floor Apartment
- Walking Distance To Town Centre & Sea Front
- Over 60's Development
- Communal Gardens

Description

A second floor one bedroom retirement flat in the over 60's development of St Johns Court, conveniently situated for access to the town centre and sea front.





Directions



A second floor one bedroom retirement flat in the over 60's development of St Johns Court, conveniently situated for access to the town centre and sea front. The accommodation comprises, entrance hall, bathroom, double bedroom with built in wardrobe, l

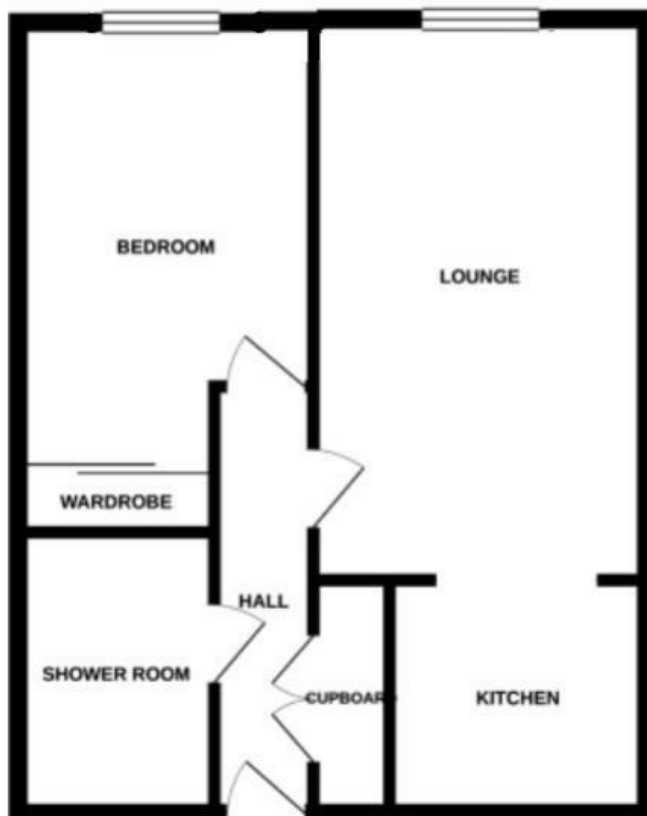



Energy Efficiency Rating		
	Current	Potential
<i>Very energy efficient - lower running costs</i>		
(92 plus) A		
(81-91) B		
(69-80) C	74	78
(55-68) D		
(39-54) E		
(21-38) F		
(1-20) G		
<i>Not energy efficient - higher running costs</i>		
England & Wales	EU Directive 2002/91/EC 	

Council Tax Band B EPC Rating C

NICHOLAS
 ——— ESTATES ———

173 Hamilton Road
 Felixstowe
 Suffolk
 IP11 7DR
 01394 282828
 felixstowe@yourhome.co.uk
 yourhome.co.uk