



Downland, Two Mile Ash Milton Keynes MK8 8HR

welcome to

Downland, Two Mile Ash Milton Keynes

Two Mile Ash is surrounded by green spaces and parkland, creating a wonderful balance between town and nature. Residents can enjoy leisurely walks around nearby Lodge Lake or make the most of the extensive pathways and cycle routes leading into the city centre and beyond.

Hall Entrance:

Living Room:

16' 5" x 9' 10" (5.00m x 3.00m)

Double glazed window and door to front aspect.

Kitchen:

9' 10" x 5' 11" (3.00m x 1.80m)

Fitted with a range of units to both base and eye level, sink with mixer taps, space for oven, fridge freezer, washing machine and double glazed window to front aspect.

Bathroom:

Suite comprising: Bath with shower and screen, WC and wash hand basin.

Bedroom One:

Built in wardrobe and double glazed window to rear aspect.

Outside:

Rear:

Patio area and gate to the rear.

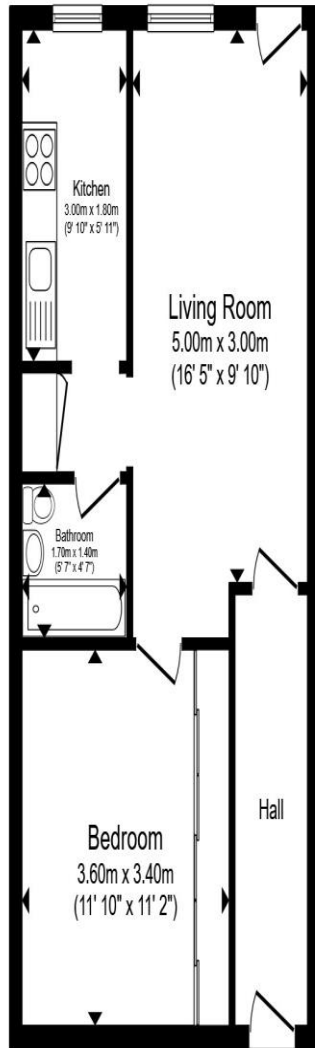

Total floor area 44.1 m² (475 sq.ft.) approx

This floor plan is for illustrative purposes only. It is not drawn to scale. Any measurements, floor areas (including any total floor area), openings and orientation are approximate. No details are guaranteed, they cannot be relied upon for any purpose and they do not form part of any agreement. No liability is taken for any error, omission or misstatement. A party must rely upon its own inspection(s). Powered by www.propertybox.io



welcome to
Downland,
Two Mile Ash Milton Keynes

- ONE BEDROOM BUNGALOW
- LIVING ROOM
- PRIVATE GARDEN
- CLOSE TO LOCAL AMENITIES
- PARKING TO REAR

Tenure: Freehold EPC Rating: E
Council Tax Band: B

offers in excess of
£200,000



view this property online [brownandmerry.co.uk/Property/STS108128](https://www.brownandmerry.co.uk/Property/STS108128)



Property Ref:
STS108128 - 0007

1. MONEY LAUNDERING REGULATIONS Intending purchasers will be asked to produce identification documentation at a later stage and we would ask for your co-operation in order that there is no delay in agreeing the sale. 2. These particulars do not constitute part or all of an offer or contract. 3. The measurements indicated are supplied for guidance only and as such must be considered incorrect. Potential buyers are advised to recheck measurements before committing to any expense. 4. We have not tested any apparatus, equipment, fixtures or services and it is in the buyers interest to check the working condition of any appliances. 5. Where an EPC, or a Home Report (Scotland only) is held for this property, it is available for inspection at the branch by appointment. If you require a printed version of a Home Report, you will need to pay a reasonable production charge reflecting printing and other costs. 6. We are not able to offer an opinion either written or verbal on the content of these reports and this must be obtained from your legal representative. 7. Whilst we take care in preparing these reports, a buyer should ensure that his/her legal representative confirms as soon as possible all matters relating to title including the extent and boundaries of the property and other important matters before exchange of contracts.

Brown & Merry is a trading name of Sequence (UK) Limited which is registered in England and Wales under company number 4268443, Registered Office is Cumbria House, 16-20 Hockliffe Street, Leighton Buzzard, Bedfordshire, LU7 1GN. VAT Registration Number is 500 2481 05.

brown & merry



01908 562011



stonystatford@brownandmerry.co.uk



65 High Street, MILTON KEYNES,
Buckinghamshire, MK11 1AY



[brownandmerry.co.uk](https://www.brownandmerry.co.uk)