



Musgrove Road, SE14

£1,425,000

We are delighted to present this exceptional four-bedroom period home, beautifully maintained and thoughtfully extended into the basement offering spacious and flexible living across three floors. This property is perfect for families, multi-generational living, or generating rental income.

Musgrove Road is a prestigious tree lined road in the sought after Telegraph Hill Conservation Area, perfectly positioned for the popular cafés, shops and restaurants in New Cross and Brockley. Frequent rail links can be found at nearby New Cross Gate station, with access to London Bridge in as little as 10 minutes.

Features

- Victorian Terrace House
- Four Bedrooms
- Two Bathrooms
- Excellent Transport Links
- Telegraph Hill Conservation Area
- Over 2500 Sq Ft



Musgrove Road, SE14



Musgrove Road, London, SE14

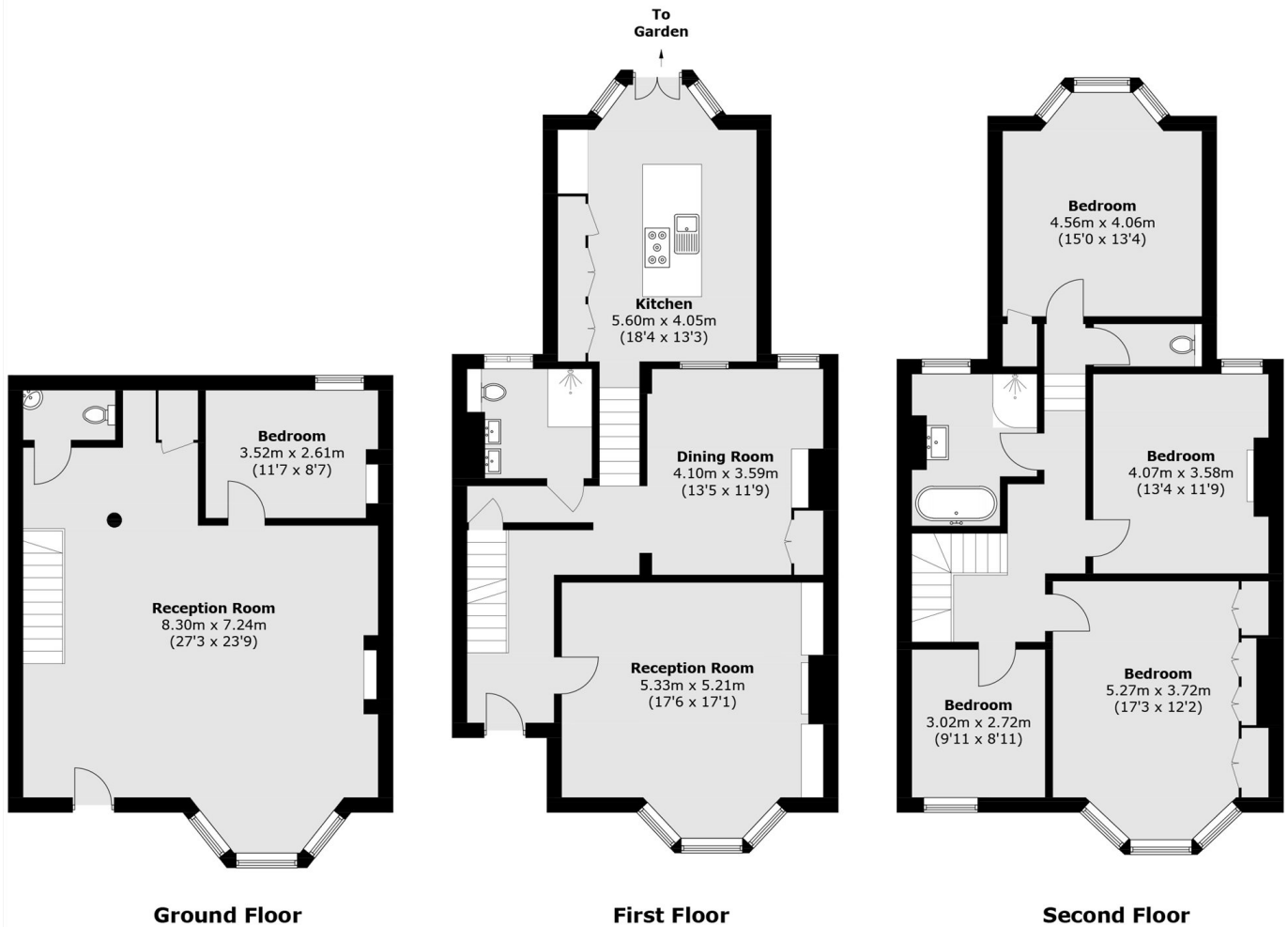

Total area (approx.): 232.6 sq. m (2,504.7 sq. ft)