



Cross Keys Estates

Opening doors to your future



28 Seaton Place
Plymouth, PL2 1PS
Guide Price £160,000 Freehold



28 Seaton Place, Plymouth, PL2 1PS

Guide Price £160,000 Freehold

**** Guide Price 160,000- £180,000 ****

Cross Keys Estates is pleased to present this charming period mid-terrace house located on Seaton Place in the desirable area of Stoke. This delightful property offers a wonderful blend of character and modern living, making it an ideal home for families or those seeking a spacious residence.

The house boasts three ample-sized bedrooms, providing plenty of room for relaxation and rest. The large modern fitted kitchen is perfect for culinary enthusiasts, offering a bright and inviting space to prepare meals. The property features two spacious reception rooms, including a dining room and a sitting room with a lovely bay fronted window, allowing natural light to flood the space and create a warm atmosphere.

- Period Mid Terrace Property
- Large Modern Fitted Kitchen
- Highly Popular Residential Area
- Private Rear Courtyard Garden
- Convenient No Onward Chain
- Three Ample Sized Bedrooms
- Two Spacious Reception Rooms
- Close To Local Amenities, Stoke Village
- Bright And Airy Family Bathroom
- Early Viewing Advised, EPC=D57



Cross Keys Estates

As one of Plymouth's leading QUALIFIED estate agents for over two decades, we are proud to have been offering our multi award winning customer service since day one. If you are currently on the market or you are thinking of putting your property on the market, why not give us a call, you will not be disappointed. 98% of our clients recommend us to their friends and family and our results, when it comes to sales, are unrivalled.

Plymouth

Plymouth, Britain's Ocean City, is one of Europe's most vibrant waterfront cities. Located in one of the most beautiful locations imaginable, Plymouth is sandwiched between the incredible South West coastline and the wild beauty of Dartmoor National Park. Plymouth is 37 miles south-west of Exeter and 190 miles west-south-west of London, between the mouths of the rivers Plym to the east and Tamar to the west where they join Plymouth Sound to form the boundary with Cornwall, it is also home to one of the most natural harbours in the world. To the North of Plymouth is Dartmoor National Park, extending to over 300 square miles, which provides excellent recreational facilities.

The city is home to more than 260,000 people, making it the 30th most populated city in the United Kingdom and the second-largest city in the South West, after Bristol and has a full range of shopping, educational and sporting facilities. There is mainline train service to London (Paddington) and to Penzance in West Cornwall.

There's everything that you would expect to find in a cool, cultural city, with great shopping, arts and entertainment. But there's also hundreds of years of history to uncover, from Sir Francis Drake and the Spanish Armada to the Mayflower sailing in 1620, to a city rebuilt following the Blitz during World War II. With easy access to Exeter and its International Airport and a mainline train station giving direct access to London and a ferry port offering sea crossings to both France and Spain.

Plymouth is governed locally by Plymouth City Council and is represented nationally by three MPs. Plymouth's economy remains strongly influenced by shipbuilding and seafaring including ferry links to Brittany and Spain, but has tended toward a university economy since the early 2000's. It has the largest operational naval base in Western Europe – HMNB Devonport.

Stoke

The property is situated literally just a stone's throw away from the ever popular Stoke Village where a number of local amenities can be found. Stoke is well known for having an abundance of Victorian, Georgian and Edwardian properties within a conservation area. The area boasts easy access into Plymouth City Centre, which is only a short drive away and many local bus services run through the area giving access to all areas across Plymouth. Some of the amenities provided includes a co-operative store, pharmacy, cafe's, charity shops, public houses and much more. Primary schools in the area include Stoke Damerel Primary School and Stuart Road Primary School, whilst secondary schooling within the area includes Devonport High School for Boys and Stoke Damerel Community College. Plymouth College of Further Education is located on the southern fringes of the area, which is yet another added benefit along with being within close proximity to Devonport Dockyard and the Torpoint Ferry giving access in Cornwall. Located approximately 1 mile from Plymouth centre means that residents of stoke have easy access to Plymouth ferry port and within 3 miles of the A38. Plymouth Albion Rugby Football Club is located within a mile to the south west of Stoke with Plymouth Argyle Football Club located within a mile to the north east. There are a number of large recreational areas including the Block House Park, Victoria Park at Mill Bridge and Devonport Park within the area as well as the Ecological Park located south of Milehouse Road.

More Property Information

The family bathroom is bright and airy, designed to provide comfort and convenience. Additionally, the private rear courtyard garden offers a peaceful outdoor retreat, perfect for enjoying a morning coffee or hosting summer gatherings.

Situated close to local amenities and the vibrant Stoke Village, this property is ideally located for those who appreciate the convenience of nearby shops, cafes, and recreational facilities. With the added benefit of no onward chain, this home is ready for you to move in and make it your own.

In summary, this period mid-terrace house on Seaton Place presents an excellent opportunity for anyone looking to settle in a popular residential area. With its spacious rooms, modern features, and charming character, it is a property not to be missed.

Hallway

Sitting Room

11'3" x 11'5" (3.42m x 3.47m)

Kitchen

17'11" x 8'0" (5.45m x 2.44m)

Dining Room

11'2" x 9'4" (3.41m x 2.84m)

Bathroom

Landing

Primary Bedroom

11'7" x 9'3" (3.53m x 2.82m)

Bedroom 2

10'10" x 9'3" (3.30m x 2.82m)

Bedroom 3

6'7" x 5'4" (2.00m x 1.63m)

Courtyard Garden

Cross Keys Estates Lettings Department

Cross Keys Estates also offer a professional, ARLA accredited Lettings and Management Service. If you are considering renting your property in order to purchase, are looking at buy to let or would like a free review of your current portfolio then please call our director Jack who is a fully qualified and award-winning letting agent on 01752 500018

Financial Services

Cross Keys Estates are proud to work in partnership with Peter Nixon Financial Services, our whole of market mortgage specialists. With over 18 years industry experience, they are able to source the very best deal to meet their customers circumstances. Offering professional and friendly advice on residential and investment mortgages. Please get in touch to arrange a free, no obligation appointment to see how they can help you. Tel. 01752 255905, Email. sarah.millman@pn-fs.co.uk



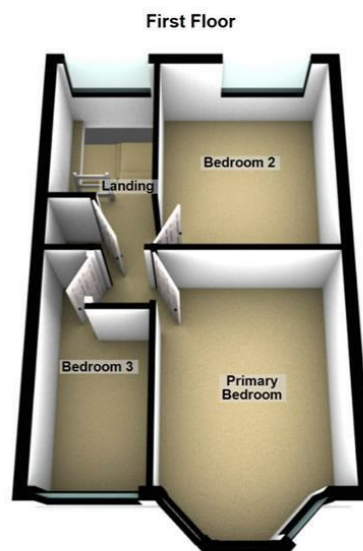
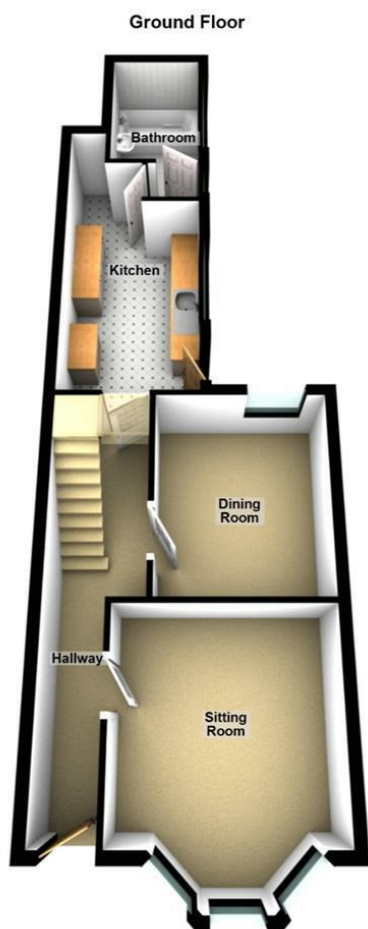

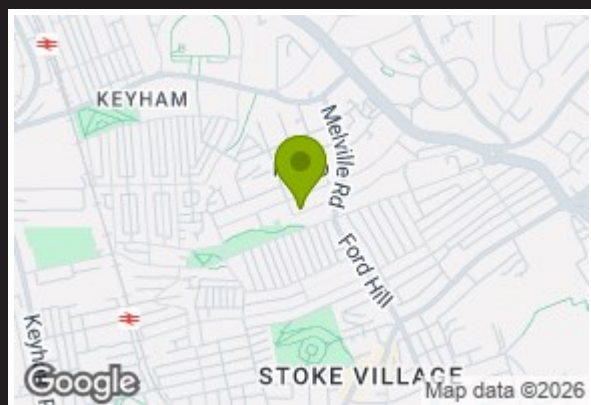

Cross Keys Estates
 Residential Sales & Lettings



Energy Efficiency Rating		
	Current	Potential
Very energy efficient - lower running costs		
(92 plus) A	57	86
(81-91) B		
(69-80) C		
(55-68) D		
(39-54) E		
(21-38) F		
(1-20) G		
Not energy efficient - higher running costs		
England & Wales		EU Directive 2002/91/EC 

Environmental Impact (CO ₂) Rating		
	Current	Potential
Very environmentally friendly - lower CO ₂ emissions		
(92 plus) A		
(81-91) B		
(69-80) C		
(55-68) D		
(39-54) E		
(21-38) F		
(1-20) G		
Not environmentally friendly - higher CO ₂ emissions		
England & Wales		EU Directive 2002/91/EC 

VIEWINGS AND NEGOTIATIONS Strictly through the vendors agents, Cross Keys Estates MONEY LAUNDERING REGULATION 2003 AND PROCEEDS OF CRIME ACT 2002 Cross Keys Estates are fully committed to complying with The Money Laundering Regulations that have been introduced by the government. These regulations apply to everyone buying or selling a property, including companies, businesses and individuals within the United Kingdom or abroad. Should you either purchase or sell a property through this estate agents we will ask for information from you regarding your identity and proof of residence. We would ask for you to co-operate fully to ensure there is no delay in the sales/purchase process. IMPORTANT: we would like to inform prospective purchasers that these sales particulars have been prepared as a general guide only. A detailed survey has not been carried out, nor the services, appliances and fittings tested. Room sizes should not be relied upon for furnishing purposes and are approximate. If floor plans are included, they are for guidance only and illustration purposes only and may not be to scale. If there are any important matters likely to affect your decision to buy, please contact us before viewing the property.



Council Tax Band B

Cross Keys Estates
 Opening doors to your future

Sales, Cross Keys House 51-53 Devonport Road,,
 Stoke, Plymouth, Devon, PL3 4DL
 Tel: 01752 500018 | sales@crosskeysestates.net
 www.crosskeysestates.net