



Regal Court, Warminster

£50,000



Key Features

- End of Chain
- Over 55 Only
- Ground Floor
- Convenient location
- Residents Lounge & Laundry Room
- 24-Hour Careline Facilities
- EPC rating C
-



This retirement home is offered for sale in Warminster and is available exclusively to the over 55's.

The property comprises an open-plan reception room, one double bedroom, a kitchen with built-in pantries, and a bathroom.

The home needs some renovation, presenting an opportunity for a buyer to update and personalise the accommodation to their own requirements. The property has an EPC rating of C and falls within Council Tax Band A.

Situated in Warminster, the home benefits from access to local amenities, including the town centre shops, cafes and essential services. Nearby parks and walking routes provide opportunities for gentle exercise and recreation, with pleasant green spaces and paths within easy reach.

Warminster railway station offers connections to Salisbury, Bath, Bristol and Cardiff, with journey times to Bath typically around 35-40 minutes and to Salisbury around 20-25 minutes. Bus services operate through the town, linking surrounding villages and nearby centres.

The combination of a central Warminster location, retirement-specific setting for over 55's, and the scope for renovation makes this property suitable for those seeking to create a tailored home later in life, while remaining close to local facilities and public transport.

Approx Gross Internal Area
37 sq m / 401 sq ft

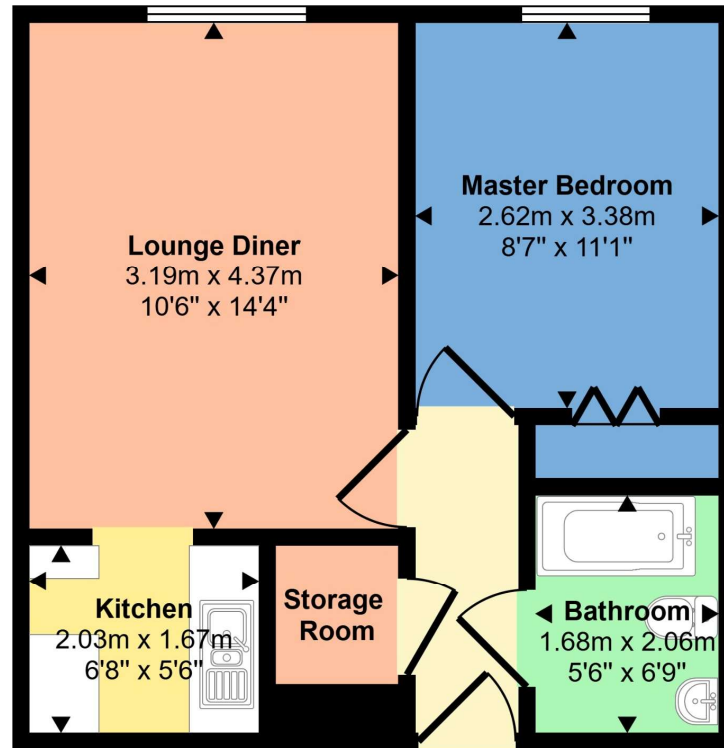

Floorplan

This floorplan is only for illustrative purposes and is not to scale. Measurements of rooms, doors, windows, and any items are approximate and no responsibility is taken for any error, omission or mis-statement. Icons of items such as bathroom suites are representations only and may not look like the real items. Made with Made Snappy 360.

