

Ickenham Road

Ruislip • Middlesex • HA4 7BA
PCM: £1,600 PCM



coopers
est 1986

Set on the fourth floor, this luxury apartment has everything needed to move straight into and appreciate. The Thomas More Building is set a stone's throw away from the high street shops in Ruislip and is within easy reach to the train station and other local amenities. It is immaculately presented throughout and benefits from two bedrooms, one bathroom, a kitchen and a spacious lounge/diner.

Fourth floor apartment- lift access

Two bedrooms

Dishwasher

Convenient location

Walking distance to Ruislip Station

Family bathroom

Allocated parking

Amenities, shops, restaurants nearby

Unfurnished

Available Date

5th February 2026

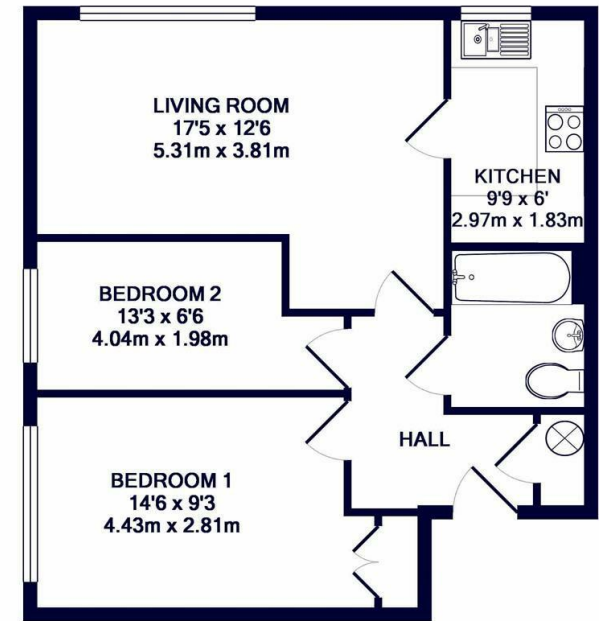

TOTAL APPROX. FLOOR AREA 556 SQ.FT. (51.7 SQ.M.)

Whilst every attempt has been made to ensure the accuracy of the floor plan contained here, measurements of doors, windows, rooms and any other items are approximate and no responsibility is taken for any error, omission, or mis-statement. This plan is for illustrative purposes only and should be used as such by any prospective purchaser. The services, systems and appliances shown have not been tested and no guarantee as to their operability or efficiency can be given
Made with Metropix ©2018

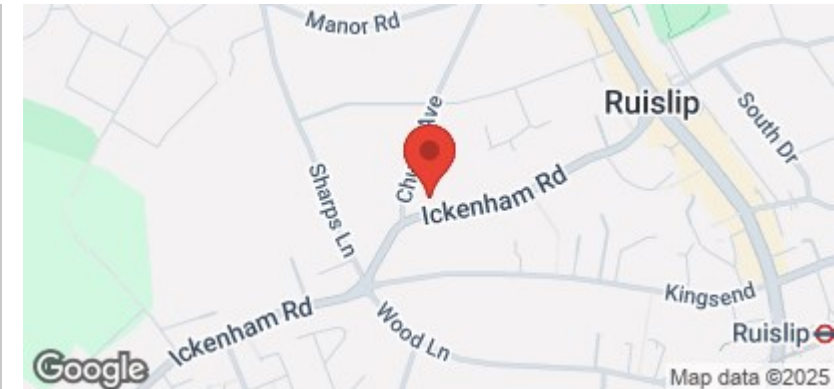

coopers
est 1986

01895 625 625

**126-128 High Street, Ruislip,
Middlesex, HA4 8LL**

rl@coopersresidential.co.uk

CoopersResidential.co.uk

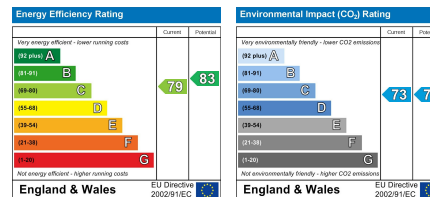

Important Notice: These particulars, whilst believed to be accurate are set out as a general outline only for guidance and do not constitute any part of an offer or contract. Intending purchasers should not rely on them as statements or representation of fact, but must satisfy themselves by inspection or otherwise has the authority to make or give any representation or warranty in respect of the property.