



APARTMENT 13 MASTER WILLIAMS PLACE FOLKESTONE, CT20 1FF

£1,195 PER MONTH

Nestled in the heart of Folkestone, this exquisite new build apartment at Master William's Place presents a unique opportunity for modern living. Completed in 2025, this stylish residence spans an impressive 705 square feet, offering a spacious and thoughtfully designed layout that is perfect for individuals, couples, or small families.

Upon entering, you are greeted by a welcoming open-plan living room and kitchen, which creates a warm and inviting atmosphere for both relaxation and entertaining. The kitchen is equipped with integrated appliances and features elegant German cabinetry with solid stone worktops, ensuring a blend of functionality and sophistication.

The apartment comprises two comfortable bedrooms, providing ample space for rest and privacy. The bathroom is tastefully designed, offering a serene retreat for daily routines. One of the key highlights of this property is its high energy efficiency, which not only contributes to a sustainable lifestyle but also results in lower running costs, making it an economical choice for prospective

**WEST END
ESTATES**

LETTINGS AND PROPERTY MANAGEMENT

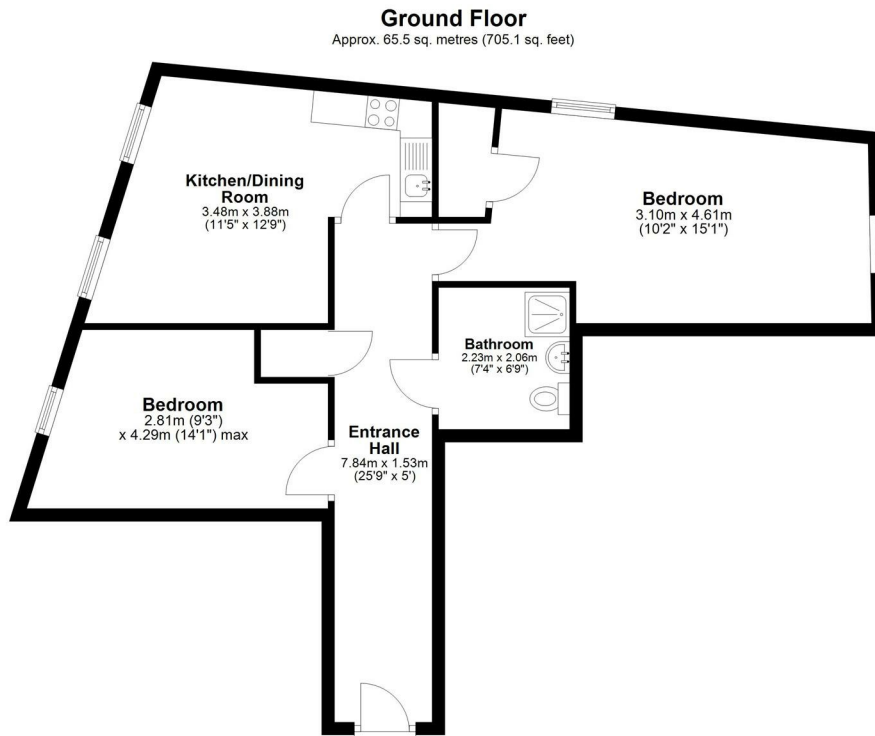

Total area: approx. 65.5 sq. metres (705.1 sq. feet)

Whilst every attempt has been made to ensure the accuracy of the floorplan contained here, measurements of doors, windows, rooms and any other items are approximate and no responsibility is taken for any error, omission or mis-statement. This plan is for illustrative purposes only and should be used as such by any prospective purchaser. The services, systems and appliances shown have not been tested and no guarantee as to their operability or efficiency can be given.
Plan produced using PlanUp.



Energy Efficiency Rating		Current	Potential
Very energy efficient - lower running costs			
(92 plus) A			
(81-91) B		82	
(69-80) C			
(55-68) D			
(39-54) E			
(21-38) F			
(1-20) G			
Not energy efficient - higher running costs			
England & Wales		EU Directive 2002/91/EC	

EPC Rating: B Council Tax Band: B

Agents Note: Whilst every care has been taken to prepare these particulars, they are for guidance purposes only. All measurements are approximate and are for general guidance purposes only and whilst every care has been taken to ensure their accuracy, they should not be relied upon and potential buyers/tenants are advised to recheck the measurements

West End Estates Folkestone
7 Sapper Row
Folkestone
Kent
CT20 3WT

01303 478777
office@westend-estates.co.uk

**WEST END
ESTATES**
LETTINGS AND PROPERTY MANAGEMENT