



## Greencroft Gardens, NW6

**TO LET - £1,750 Per Month**

Set within a grand Victorian conversion on a premier tree-lined street, is this bright one bedroom Third Floor Flat, situated in the prestigious South Hampstead Conservation Area.

The bright property offers a spacious reception room, a separate fully equipped kitchen and a double bedroom, enhanced by a large skylight, which is serviced by a three piece bathroom.

Ideally located for easy commuting, the flat is a short walk from both Finchley Road (Jubilee & Metropolitan - Zone 2) and West Hampstead (Jubilee, Overground, & Thameslink) stations. Residents enjoy immediate access to the artisan shops and cafes of West End Lane, alongside the retail and dining.



- Bright 1 bedroom third floor flat
- Fully equipped separate kitchen
- Excellent transport links
- Council: Camden (C)
- Deposit: £2,076
- Viewing is highly recommended



020 8450 9377

[rentals@cameronsstiff.co.uk](mailto:rentals@cameronsstiff.co.uk)

[cameronsstiff.co.uk](http://cameronsstiff.co.uk)

## Greencroft Gardens, NW6

Approximate Area = 34.5 sq m / 371 sq ft

For Identification only - Not to Scale

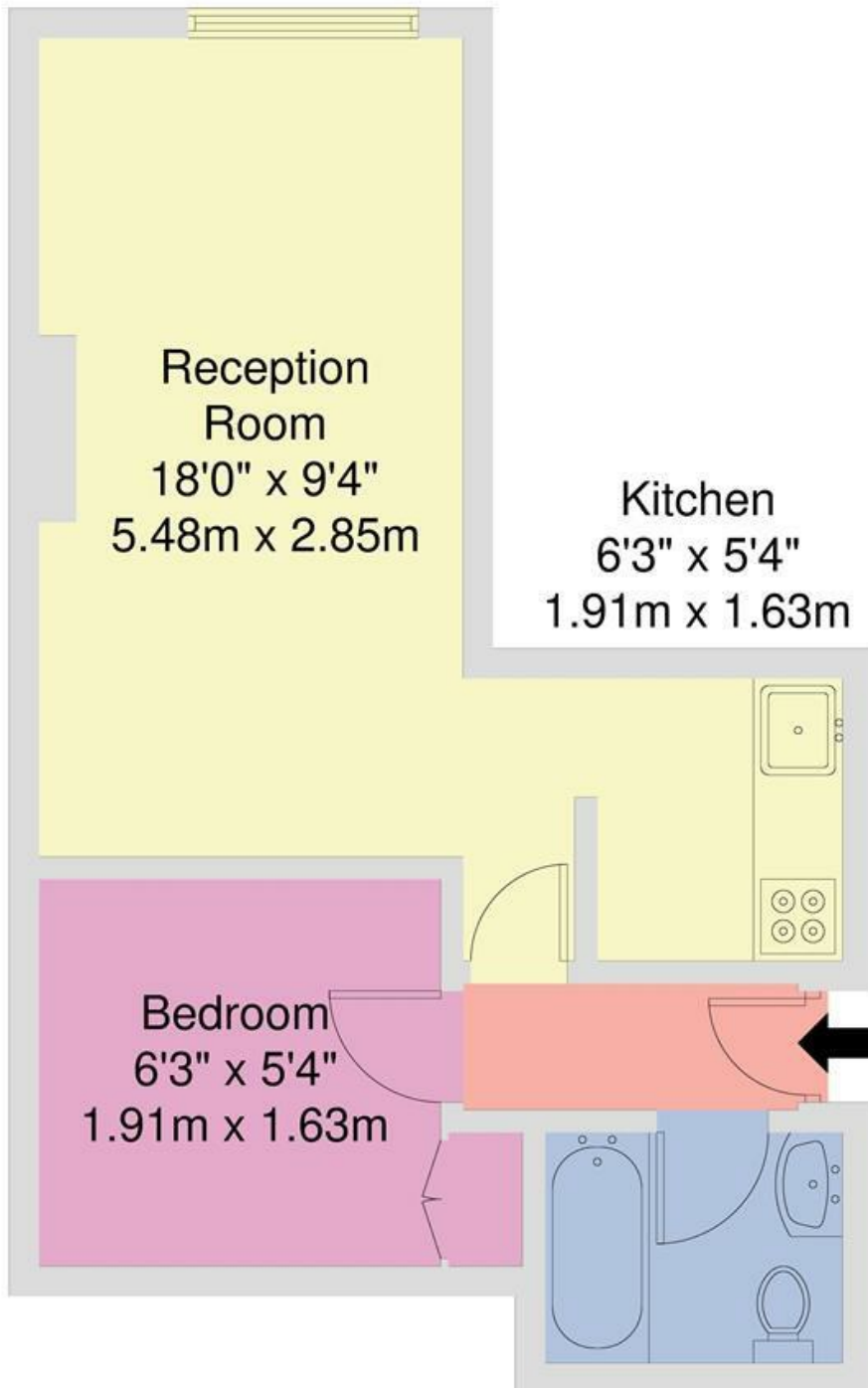

### THIRD FLOOR

Disclaimer: Floorplan produced in accordance with RICS guidelines. While we do not doubt the floorplan accuracy and completeness, you or your advisors should conduct a careful, independent investigation of the property in respect of monetary valuation. Produced for Camerons Stiff & Co.

EPC: D

Ref: 19716608

