



NEXT LEVEL
PROPE

94 Fleetwood Close, March
March



£285,000

94 Fleetwood Close

March

Extended two-bedroom home in the popular Cavalry Park development, featuring a modern kitchen, vaulted dining room, garage, driveway and a private, landscaped rear garden.
Council Tax band: B

Tenure: Freehold

- Extended two-bedroom home
- Popular Cavalry Park development
- Convenient access to the town centre via nearby pedestrian and cycle route
- Modern high-gloss kitchen with integrated appliances
- Spacious lounge with feature bay window and café-style shutters
- Versatile vaulted dining room extension with French doors to the garden
- Stylish shower room with Aqualisa digital shower
- Driveway parking for two vehicles and garage
- Private, split-level rear garden that is not overlooked
- Attractive LVT flooring throughout much of the property



**NEXT LEVEL
PROPERTY**

AGENTS THAT CARE



**NEXT LEVEL
PROPERTY**



Hallway

A welcoming entrance hall finished with attractive LVT flooring, creating a practical yet stylish first impression. The space features a useful open storage area, ideal for coats and shoes, along with a separate airing cupboard providing additional household storage. Doors lead through to the lounge, kitchen, shower room and all bedrooms, offering a well-planned and convenient layout throughout the home.

Lounge

A bright and inviting reception room featuring a continuation of the attractive LVT flooring from the hallway. A striking bay window with fitted café-style shutters and a UPVC window to the front elevation fills the room with natural light while adding character and privacy. A large open archway creates a seamless flow through to the separate dining room, making this an ideal space for both everyday living and entertaining.

Dining Room

Positioned off the lounge and with easy access to the kitchen, this versatile space is ideal for modern family living. Featuring attractive LVT flooring, a vaulted ceiling and UPVC French doors opening onto the garden, the room feels bright, airy and connected to the outside space. Fitted café-style shutters add both character and privacy. There is ample space for a dining table and chairs, making it perfect for entertaining, while the flexible layout also lends itself well to use as a home office, playroom or additional reception area.



Kitchen

Beautifully appointed, the kitchen is fitted with a contemporary range of high-gloss wall, base and drawer units, complemented by stylish quartz work surfaces and a stainless steel inset one-and-a-half bowl sink. A comprehensive range of integrated appliances includes twin ovens, an induction hob with extractor hood over, dishwasher, washing machine and fridge freezer, creating a sleek and practical space ready for modern living. A UPVC window to the rear elevation provides natural light, while the tiled floor offers durability and ease of maintenance. Thoughtfully designed with both functionality and style in mind, this is a kitchen perfectly suited to everyday use and entertaining alike.

Bedroom 1

A well-proportioned double bedroom enjoying a peaceful outlook over the rear garden through a UPVC window. The room features attractive wood panelling to one wall, adding warmth and character, while the continuation of the stylish LVT flooring enhances the modern feel. A comfortable and relaxing retreat, perfectly suited to everyday living.

Bedroom 2

A bright and spacious double bedroom benefiting from dual-aspect UPVC windows to the front and side elevations, allowing plenty of natural light to flood the room. Attractive wall panelling to one wall adds character and creates a stylish focal point, while fitted shutters provide privacy and excellent light control. The room is finished with attractive LVT flooring, creating a modern and low-maintenance space ideal for family members or guests.



Shower Room

Stylishly appointed, the shower room features a walk-in shower cubicle fitted with an Aqualisa digital shower, complete with convenient on/off controls positioned at the entrance to the room for ease of use. A contemporary combination vanity unit incorporates a concealed-cistern WC and wash hand basin, providing practical storage while maintaining a sleek, uncluttered finish. Complemented by a tiled floor, half-tiled walls and a heated towel rail, the room is both functional and inviting. A UPVC window to the rear elevation allows natural light and ventilation to complete this well-designed space.

Front Garden

To the front, the property enjoys a smart and low-maintenance garden, predominantly laid to block paving and enclosed by attractive wrought iron railings. A matching pedestrian gate provides access to the front entrance, creating an appealing first impression. A driveway to the side of the property provides ample off-road parking for two vehicles and leads to the garage, offering additional parking, storage or workshop potential.

Rear Garden

The rear garden has been thoughtfully landscaped to create an attractive split-level outdoor space, ideal for both relaxing and entertaining. A combination of paved patio areas and a well-maintained lawn provides plenty of room to enjoy the garden throughout the day, while a variety of established trees and planting add colour, interest and a sense of maturity. Fully enclosed by timber fencing, the garden offers a good degree of privacy and benefits from not being overlooked, creating a peaceful and secluded setting.





Approx Gross Internal Area
70 sq m / 754 sq ft

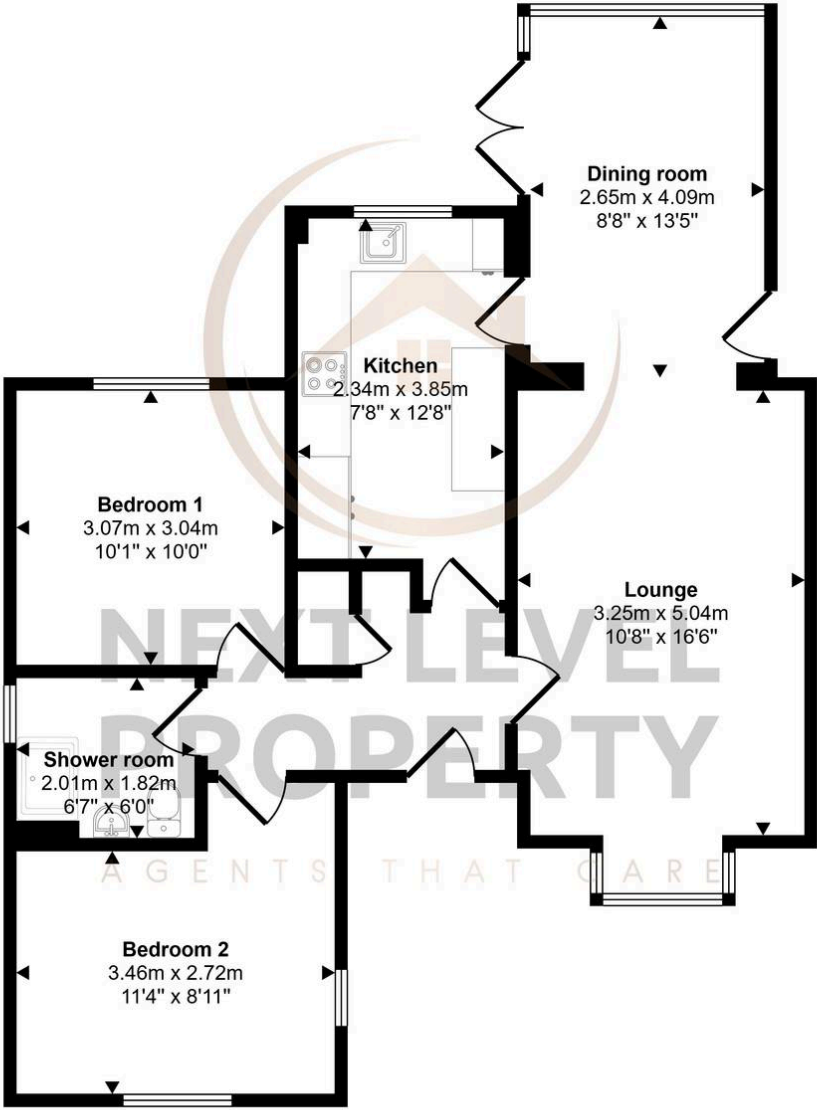

Floorplan

This floorplan is only for illustrative purposes and is not to scale. Measurements of rooms, doors, windows, and any items are approximate and no responsibility is taken for any error, omission or mis-statement. Icons of items such as bathroom suites are representations only and may not look like the real items. Made with Made Snappy 360.





Next Level Property

8 Juniper Close, Doddington - PE15 0WQ

01354 776180

info@next-level-property.co.uk

next-level-property.co.uk



**NEXT LEVEL
PROPERTY**

AGENTS THAT CARE