



68 BAKERS LANE COVENTRY, CV5 8PR

£145,000
LEASEHOLD

James Whalley is proud to present this well-presented ground floor two-bedroom apartment, ideally situated in a sought-after location and offered to the market with the added benefit of no onward chain.

Upon entering, you are welcomed by an entrance hallway leading to two generously sized bedrooms, a modern family bathroom, a spacious lounge, and a stylish refitted kitchen finished to a high standard.

Located on the ground floor, the apartment benefits from easy access and also offers an allocated off-road parking space, along with access to well-maintained communal gardens.

suave

GROUND FLOOR
505 sq.ft. (47.0 sq.m.) approx.

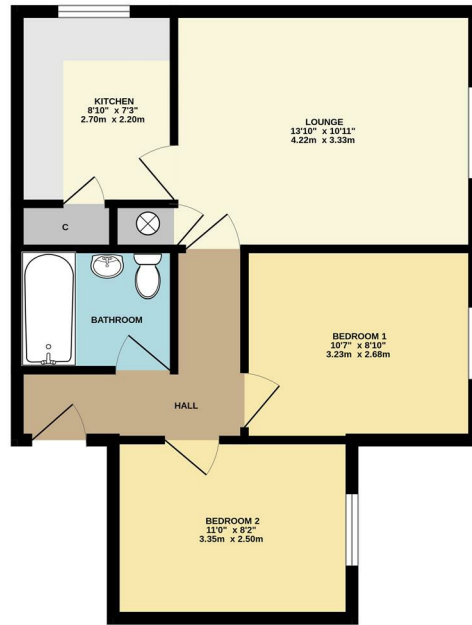

TOTAL FLOOR AREA: 505 sq.ft. (47.0 sq.m.) approx.
While every attempt has been made to ensure the accuracy of the floorplan contained herein, measurements of doors, windows, rooms and any other items are approximate and no responsibility is taken for any error, omission or misstatement. This plan is for illustrative purposes only and should be used as such by any prospective purchaser. The services, systems and appliances shown have not been tested and no guarantee as to their operability or efficiency can be given.
Made with MetreXr 10/2025



Energy Efficiency Rating		Current	Potential
Very energy efficient - lower running costs			
(92 plus) A			
(81-91) B			
(69-80) C			
(55-68) D		61	76
(39-54) E			
(21-38) F			
(1-20) G			
Not energy efficient - higher running costs			
England & Wales		EU Directive 2002/91/EC	

EPC Rating: D Council Tax Band: B

Agents Note: Whilst every care has been taken to prepare these particulars, they are for guidance purposes only. All measurements are approximate and are for general guidance purposes only and whilst every care has been taken to ensure their accuracy, they should not be relied upon and potential buyers/tenants are advised to recheck the measurements

Suave
6a Westhill Road
Coventry
CV6 2AA

02475 105 222
info@suaveestateagents.com

suave