

TO LET

8A Scotland Street, Ellesmere, Shropshire, SY12 0EG

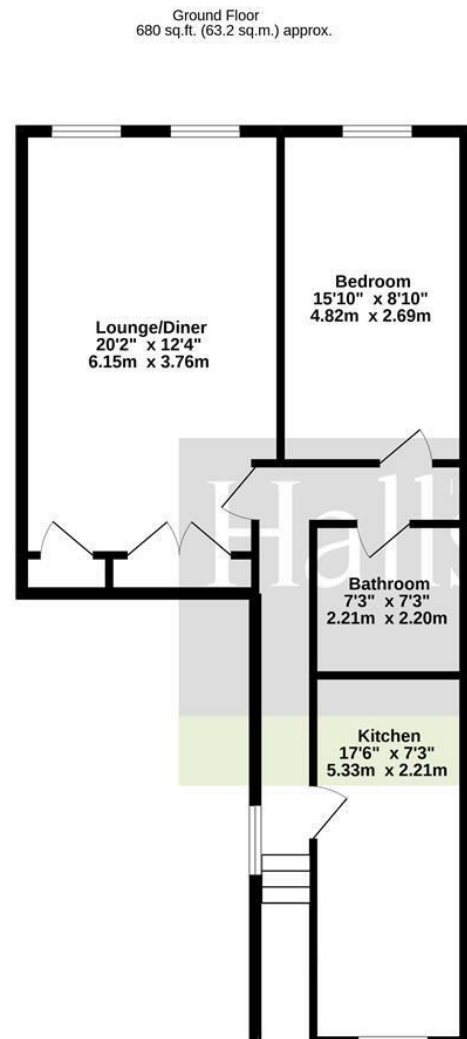
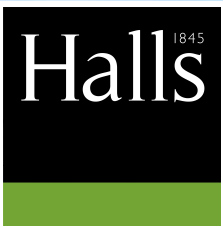

TO LET

£650 Per Calendar Month

8A Scotland Street, Ellesmere, Shropshire, SY12 0EG

A well presented, one bedroom apartment conveniently situated within the heart of the sought after, North Shropshire town of Ellesmere.

**Property to sell?** We would be delighted to provide you with a free no obligation market assessment of your existing property. Please contact your local Halls office to make an appointment. **Mortgage/financial advice.** We are able to recommend a completely independent financial advisor,

who is authorised and regulated by the FCA. Details can be provided upon request. **Do you require a surveyor?** We are able to recommend a completely independent chartered surveyor. Details can be provided upon request.

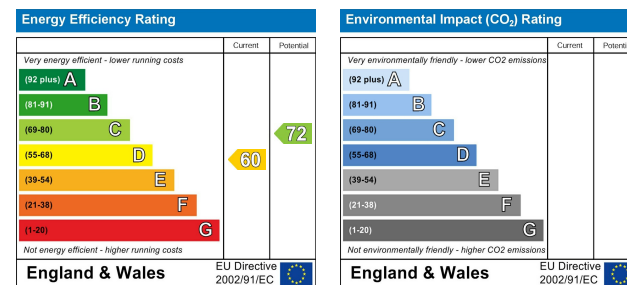

01691 622602

**Ellesmere Lettings**  
1-3 Cross Street, Ellesmere, Shropshire, SY12 0AW  
E: ellesmerelettings@hallsgb.com



IMPORTANT NOTICE. Halls Holdings Ltd and any joint agents for themselves, and for the Vendor of the property whose Agents they are, give notice that: (i) These particulars are produced in good faith, are set out as a general guide only and do not constitute any part of a contract (ii) No person in the employment of or any agent of or consultant to Halls Holdings has any authority to make or give any representation or warranty whatsoever in relation to this property (iii) Measurements, areas and distances are approximate, Floor plans and photographs are for guidance purposes only (photographs are taken with a wide angled / zoom lenses) and dimensions shapes and precise locations may differ (iv) It must not be assumed that the property has all the required planning or building regulation consents. Halls Holdings, Bowmen Way, Shrewsbury, Shropshire SY4 3DR. Registered in England 06597073.

- One Bedroomed Flat
- Town Centre Location
- Close To Amenities
- Well Presented
- Deceptively Spacious
- Available Long Term

**DESCRIPTION**

Situated within the heart of Ellesmere and benefitting from close proximity to all local amenities, including a supermarket, restaurants, and a range of independent shops, whilst also being well located for access to the larger towns of Oswestry, Shrewsbury, and Wrexham.

The property is well presented throughout and comprises a modern kitchen, bathroom, spacious lounge, and double bedroom, as well as ample storage.

**KITCHEN**

7'3" x 17'6" (2.21 x 5.33)

**LIVING/DINING ROOM**

12'4" x 20'2" (3.76 x 6.15)

**BATHROOM**

8'10" x 15'10" (2.69 x 4.83)

**BEDROOM**

7'9" x 6'2" (2.36 x 1.89)

**HOLDING DEPOSIT**

A security deposit equal to five weeks' rent will be due to be held by the DPS.

**SERVICES**

We understand that the property has the benefit of mains water, electricity and drainage.

**LOCAL AUTHORITY**

Shropshire Council, Shirehall, Abbey Foregate, Shrewsbury, Shropshire, SY2 6ND

**COUNCIL TAX**

The property is in Band ' A ' on the Shropshire Council Register.

**CONDITIONS**

The property will be offered on an APT with longer term tenants preferred.

**VIEWING**

By appointment through Halls, The Square, Ellesmere, Shropshire. Tel:(01691) 622602.

