



Jenkinson realestates

Grosvenor Mansions | Queen Street
Deal
Asking Price £170,000

Leasehold

57 SQ. Metres (613.54 SQ. Feet)

Council Tax: A

EPC Rating = C

First Floor Apartment

Offering One Double Bedroom

Open Plan Living Accommodation

Heart of Deal Town Centre

Utility Room and Separate Bathroom

No Onward Chain Complications

Jenkinson Estates are pleased to bring to the market this first floor apartment in the period building of Grosvenor Mansions, located in the town centre location of Queen Street, Deal. Accessed via an impressive communal entrance, this apartment comes to the market with no onward chain complications and really must be seen to be appreciated. The accommodation offers a spacious open plan sitting / dining and kitchen area, complete with a feature curved bay window, the kitchen is well appointed and is complimented with a separate utility room. The property continues to impress with the double bedroom and modern family bathroom, complete with a three piece suite, with a shower over the bath. A truly impressive apartment in the town centre that must be viewed to be appreciated. All viewings are strictly by appointment via the Sole Agent Jenkinson Estates.



Vendor advises, as of, 06/2026;

Share Of Freehold

999 Years Remaining on Lease

Maintenance - Approx. £540p/a

No Ground Rent



Jenkinson
Residential Sales & Lettings

BRITISH PROPERTY AWARDS 2025
GOLD WINNER
FOR ESTATE AGENT IN
DEAL

BRITISH PROPERTY AWARDS
2025
★★★★★
GOLD WINNER
ESTATE AGENT IN DEAL

Dawn Hughes
DAWN HUGHES
HEAD JUDGE
BRITISH PROPERTY AWARDS

Robert Melean
ROBERT MELEAN
DIRECTOR
BRITISH PROPERTY AWARDS

FIRST FLOOR

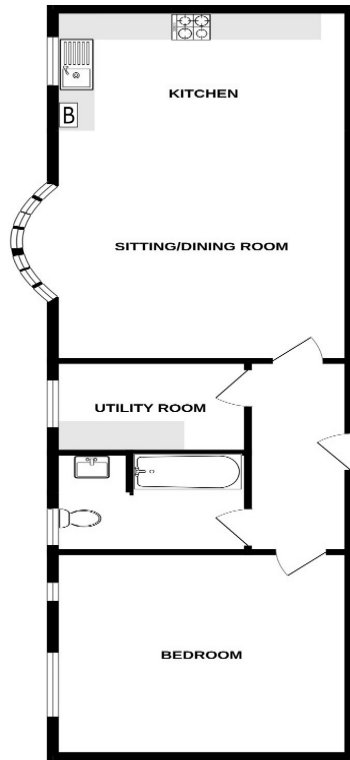

Whilst every attempt has been made to ensure the accuracy of the floorplan contained here, measurements of doors, windows, rooms and any other items are approximate and no responsibility is taken for any errors, omission or mis-statement. This plan is for illustrative purposes only and should be used as such by any prospective purchaser. The services, systems and appliances shown have not been tested and no guarantee as to their operability or efficiency can be given.
Made with Metropix ©2026

Jenkinson Estates

4 West Street, Deal, Kent, CT14 6AE

01304 373 984

info@jenkinsonestates.co.uk

www.jenkinsonestates.co.uk

Important Notice - These particulars have been prepared in good faith and they are not intended to constitute part of an offer or contract. We have not performed a structural survey on this property and the services, appliances and specific fittings have not been tested. All photographs, measurements, floor plans and distances referred to are given as a guide and should not be relied upon.

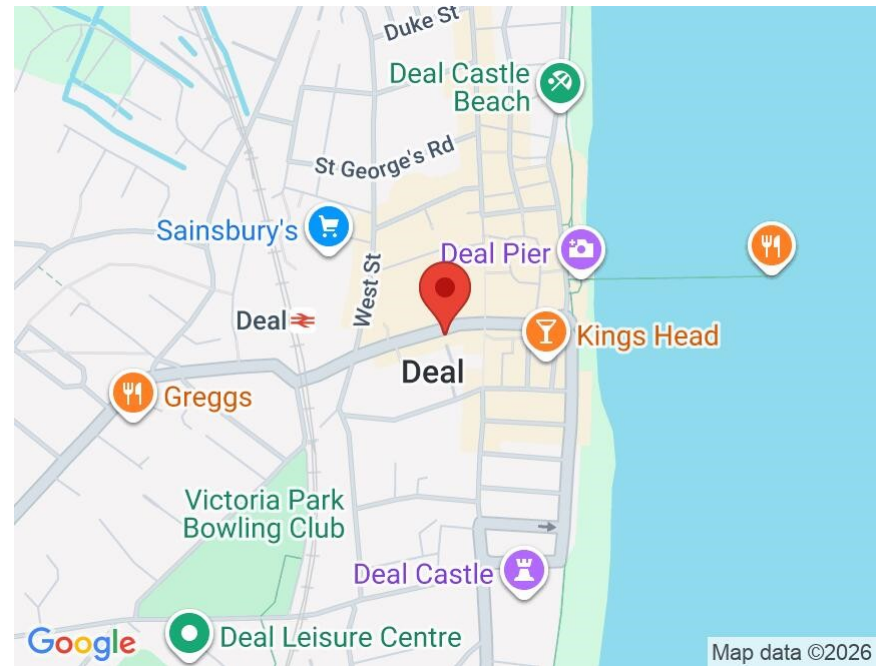

Accommodation

Entrance Via;
Communal Hallway

First Floor Landing

Apartment 3

Sitting / Dining / Kitchen

19'5" x 18'6" (5.92m x 5.64m)

Utility Room

9'6" x 3'6" (2.90m x 1.07m)

Bedroom

15'0" x 10'9" (4.57m x 3.28m)

Bathroom

11'2" x 9'4" (3.40m x 2.84m)

