

*To arrange a viewing contact us  
today on 01268 777400*



ASPIRE



## First Avenue, Canvey Island £350,000

Aspire presents this beautifully finished three-bedroom end-of-terrace home, offered in excellent move-in condition. The current owners have already carried out much of the work a property of this age and style might require, allowing buyers to enjoy the space immediately. Please note: as this is a non-standard construction, the property is suitable for cash buyers only.

Set on a generous corner plot, the home enjoys impressive outside space, a beautifully maintained garden and the benefit of sun throughout the day. The detached garage and multiple parking options—both within the garden and to the rear—add superb practicality.

3.25m x 2.30m ( 10'7" x 7'6" )

Family Bathroom

2.71m x 1.36m ( 8'10" x 4'5" )

Inside, the ground floor offers a welcoming and spacious entrance hall, a convenient W/C, and a modern open-plan layout. The lounge flows into the dining area, which in turn opens to a stylish kitchen spanning the back of the home. Bi-folding doors lead directly to the garden, creating an ideal setting for family living and entertaining.

Upstairs, you'll find three well-proportioned bedrooms and a contemporary family bathroom.

Located in an ideal family area with excellent local amenities within easy reach, the property is also just a short distance from Benfleet Train Station, offering direct links to London.

A wonderful opportunity for those seeking space, convenience, and beautifully presented accommodation.

Entrance Porch

1.59m x 1.18m ( 5'2" x 3'10" )

Downstairs W/C

1.44m x 1.20m max ( 4'8" x 3'11" max )

Hallway

3.30m x 2.77m ( 10'9" x 9'1" )

Lounge / Diner / Kitchen

6.48m > 2.38m x 6.36m > 3.18m ( 21'3" > 7'9" x 20'1" > 10'4" )

Bedroom One

4.19m x 3.25m > 2.63m ( 13'8" x 10'7" > 8'7" )

Bedroom Two

3.18m x 3.11m ( 10'5" x 10'2" )

Bedroom Three



Floor 0 Building 1

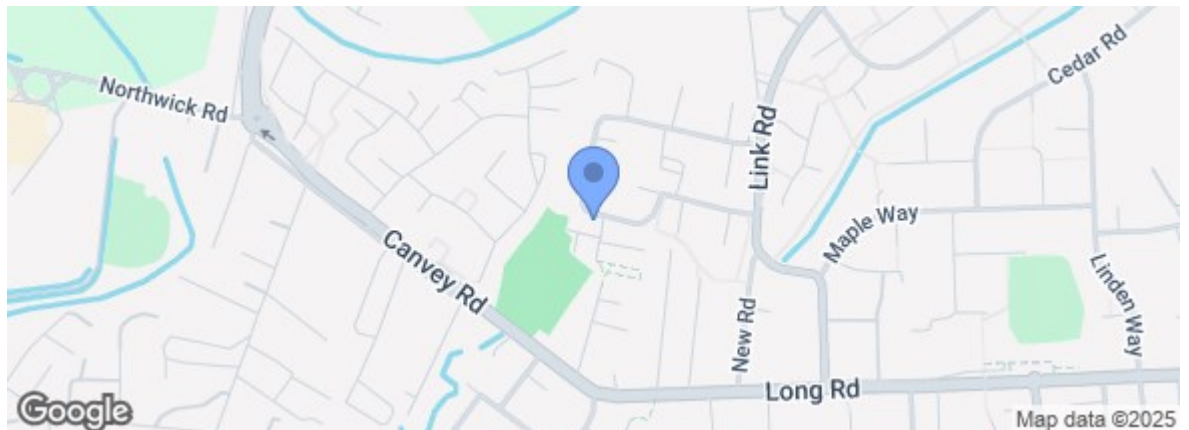
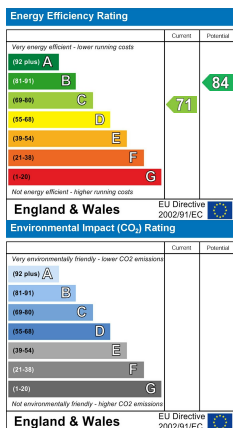
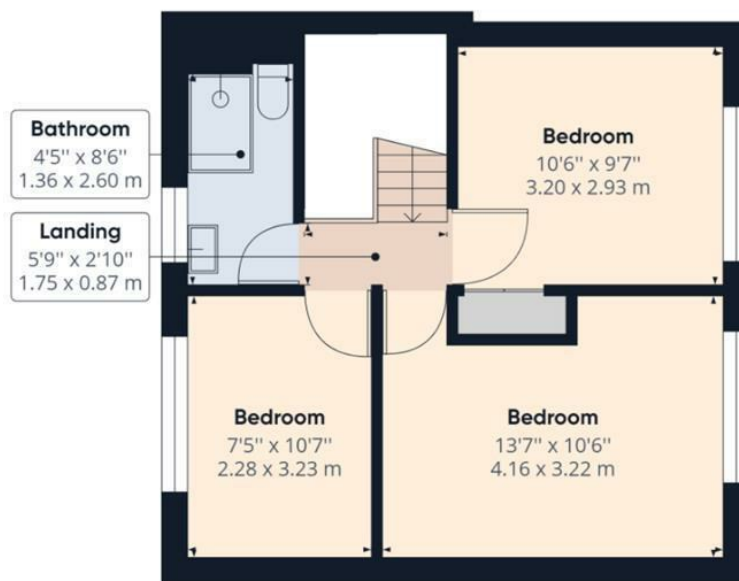

Under the Property Misdescriptions Act 1991 we make every effort to ensure our sales details are accurate but they are a general outline and do not constitute any part of an offer or contract. Any services, equipment and fittings have not been tested and no warranty can be given as to their condition. We strongly recommend that all the information provided be verified by your advisors and in particular, measurements required for a specific purpose such as fitted furniture or carpets. Please tell us if you have any problems and members of our branches will help either over the phone or in person. A copy of our complaints procedure is available on request. The details are issued on the strict understanding that any negotiations in respect of the property named herein are conducted through Aspire Estate Agents.