

## Roman Lane, Southwater

Guide Price £385,000

3 1 1



A spacious Three Bedroom Home located in the Popular Village of Southwater, boasting a 27ft Open Plan Living Area, two allocated parking spaces, West Facing Rear Garde and No Onward Chain.

Tenure: Freehold  
Council Tax: Band D  
EPC Rating: Current C - Potential B

## Key Features

- Watch Our Video Tour
- Three Bedroom Family Home
- 27ft Open Plan Living Area
- Downstairs WC
- Close to Popular Schools
- No Onward Chain
- Two Allocated Parking Spaces
- Popular Village Location
- West Facing Rear Garden
- Modern Kitchen

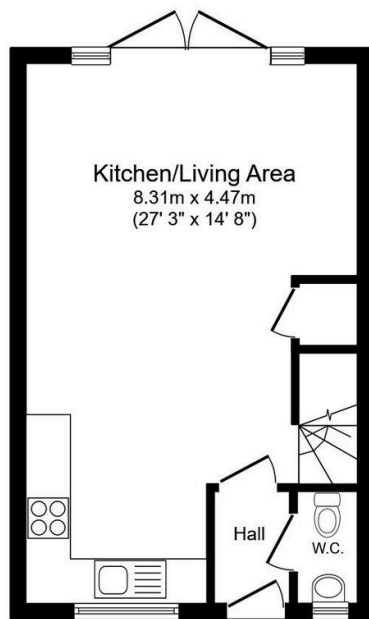

**Ground Floor**  
Floor area 32.5 sq.m. (350 sq.ft.)

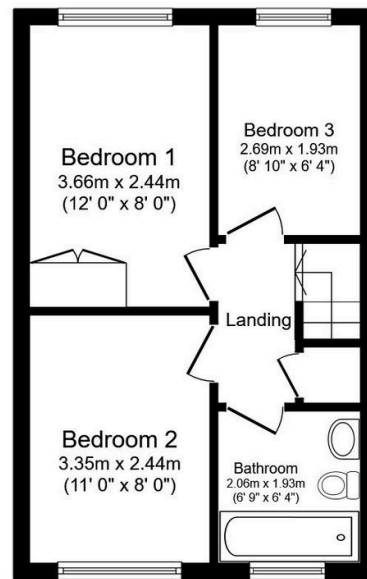

**First Floor**  
Floor area 32.5 sq.m. (349 sq.ft.)

Total floor area: 65.0 sq.m. (700 sq.ft.)

This floor plan is for illustrative purposes only. It is not drawn to scale. Any measurements, floor areas (including any total floor area), openings and orientations are approximate. No details are guaranteed, they cannot be relied upon for any purpose and do not form any part of any agreement. No liability is taken for any error, omission or misstatement. A party must rely upon its own inspection(s). Powered by [www.Propertybox.io](http://www.Propertybox.io)