



Blackmoorfoot Road, Huddersfield, HD4
Huddersfield

Blackmoor Foot Road
Offers in the Region of
£105,000



Bedrooms: 2 | Bathrooms: 1 | Receptions: 1

Attention first time buyers/investors we are pleased to present to the open market this deceptively spacious two double bedroom front facing end-terrace property. Located in the popular residential location of Crosland Moor, but with only a short drive to Huddersfield Town Centre. The property has a large bathroom and a cellar, which has been turned into a useful utility room. Benefitting from gas central heating and double glazing throughout.

The property briefly comprises of: Ground floor: an entrance vestibule, a living room, and a cellar head kitchen. To the lower ground floor there is a cellar which has been turned into a useful utility with ample storage space and two free standing spaces for appliances, one with plumbing for a washing machine. To the first floor there is a spacious double bedroom and a large house bathroom. To the second floor is a large double bedroom with splendid views over Huddersfield.

The the exterior are steps leading up to the property and an enclosed yard with steps leading down to the cellar.

Groundfloor:

Entrance Vestibule

Access to the property via a PVCu front door into the vestibule. Access to the living room and stairs rise to the first floor accommodation.

Living Room

A carpeted living room with a gas fire on a marble hearth with wood surround making an ideal focal point. Built in cupboards and draws provide extra storage space. PVCu window to front aspect.

Cellar Head Kitchen

This kitchen has vinyl flooring, matching wall and base units, laminate worksurfaces and tiled splashbacks. Integrated appliances comprise of an electric oven, a gas hob, an extractor and a 1.5 ceramic sink and drainer. There is one free standing space for an appliance. Steps lead down to the cellar/utility



Bedrooms: 2 | Bathrooms: 1 | Receptions: 1

First Floor

Landing

Carpeted stairs rise to the first floor landing. Access to one double bedroom and house bathroom.

Bedroom One

A spacious double bedroom with fitted wardrobes and drawers. A walk in cupboard provides further storage. PVCu window to front elevation.



Bedrooms: 2 | Bathrooms: 1 | Receptions: 1

Cellar/Utility

Stairs lead down from the kitchen to this useful cellar/utility. Comprising of: matching wall and base units, laminate worksurfaces, tiled splashbacks and a stainless steel sink and drainer. There are two free standing spaces for appliances, one with plumbing for a washing machine. Two walk in cold rooms provide extra storage and a wooden door leads out to the front yard.

First Floor

House Bathroom

A large house bathroom with vinyl flooring. Comprising of: a WC, a wash basin, a bath and a corner electric shower with glass sliding doors. Benefitting from two storage cupboards, a mirror, glass shelving and a PVCu privacy window to front elevation.



Bedrooms: 2 | Bathrooms: 1 | Receptions: 1

Second Floor:

Carpeted stairs rise to the second spacious double bedroom with a PVCu window providing extensive views and a Velux window providing plenty of natural light.

Exterior

To the front there are steps leading up to the property and an enclosed yard. Steps lead down to the cellar.

Property Reference - CR1528



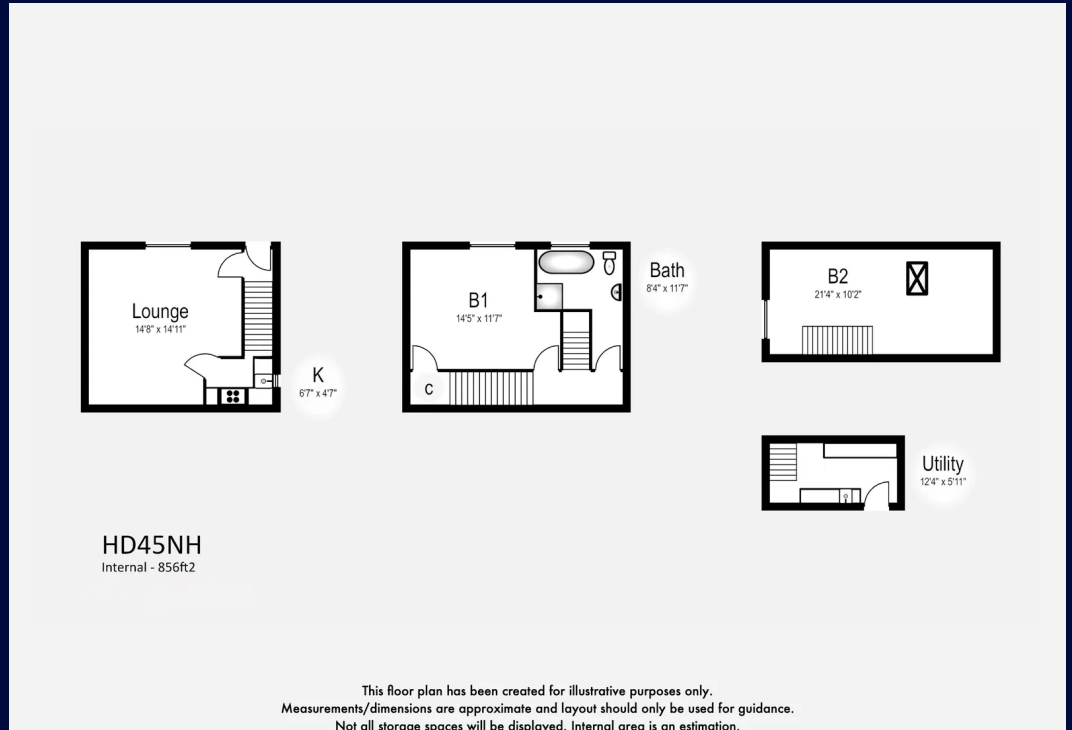



Claire Ramsbottom

01484 817299

claire.ramsbottom@exp.uk.com

<https://claireramsbottom.exp.uk.com>