



Brompton Close, TW4

£549,950

We are delighted to bring to the market this recently refurbished, immaculately presented three-bedroom house, situated in a quiet cul-de-sac with access to local amenities, schools, and transport links. The ground floor accommodation offers a large through reception/dining room, a separate kitchen, a downstairs WC, and a fantastic rear extension used as a sitting room, with patio doors leading to a beautiful rear garden. Upstairs features two double bedrooms, both with built-in wardrobes, a third bedroom, and a good-sized family bathroom. Further benefits include a private garage, electric heating, and double glazing throughout the property.

Brompton Close is conveniently situated on a quiet residential road, moments from The Orchard Primary School and close to Heathland School. The property is also located within the priority area for Tiffin Boys' Grammar School and the designated area for Tiffin Girls' Grammar School. Hounslow High Street, local parks, and transport links are also located nearby, as well as offering easy access to the neighbouring areas of Twickenham, Whitton, and Isleworth.

Features

- Freehold House
- Three Bedrooms
- Family Bathroom & Guest WC
- Rear Extended
- Immaculate Condition
- Garage

Brompton Close, Hounslow, TW4

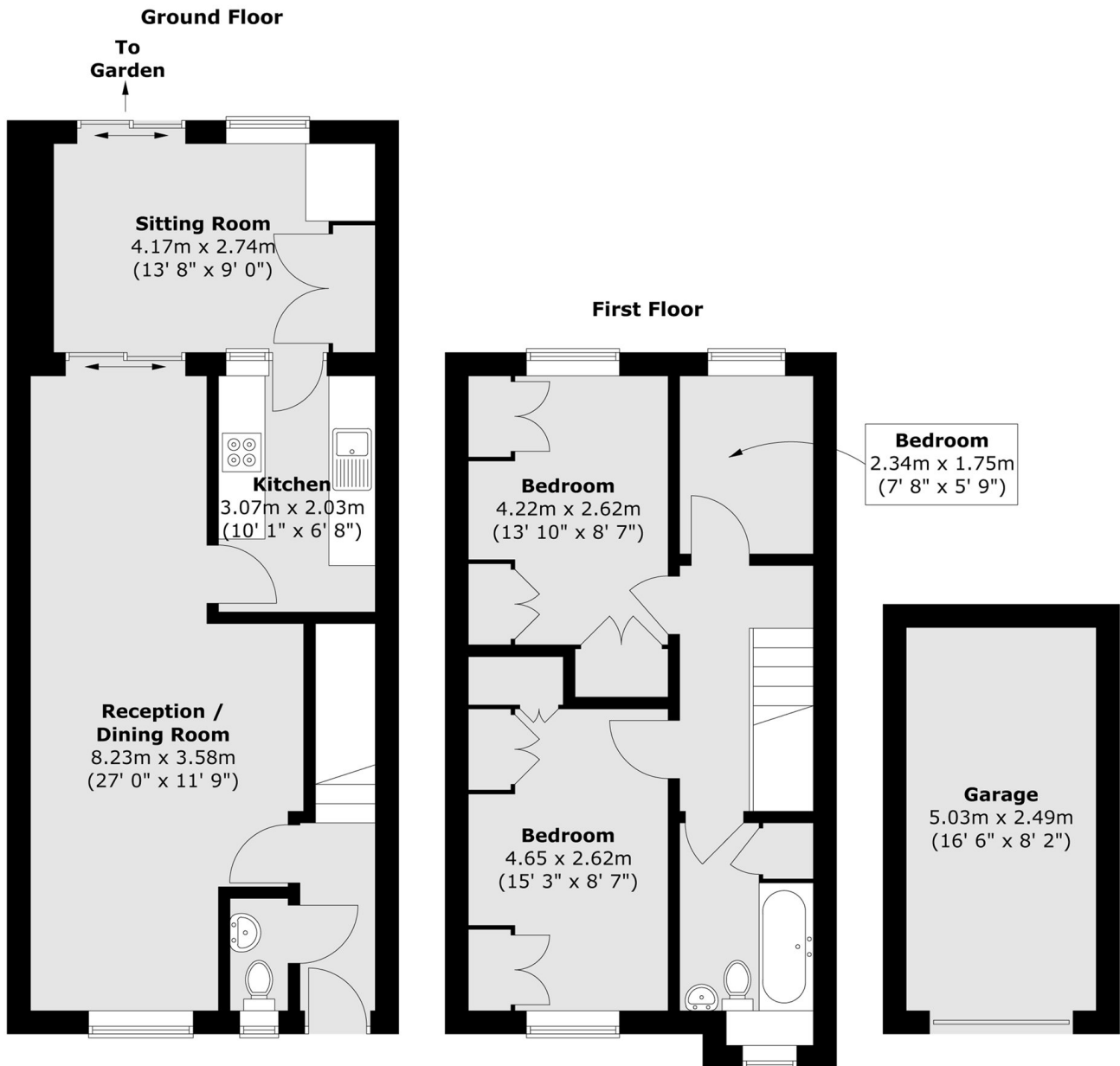

Total area (approx.) : 89.2 sq. m (960 sq. ft)
Total garage area (approx.) : 12.5 sq. m (135 sq. ft)