



Flat 26, The Hollies Maxwell Road, Beaconsfield

Guide Price £325,000

Ashington Page

A superbly presented and completely modernised open plan apartment in central Beaconsfield. This two bedroom warden assisted first floor apartment (with stair lift) is located in a popular development for over 55's and overlooks the attractive communal garden. All the facilities of Beaconsfield New Town are within a short level walk.

Tenure: Leasehold

Council Tax: South Bucks E

Lease: 125 years from 1988

Service Charge: £504.62 pcm

EPC: C

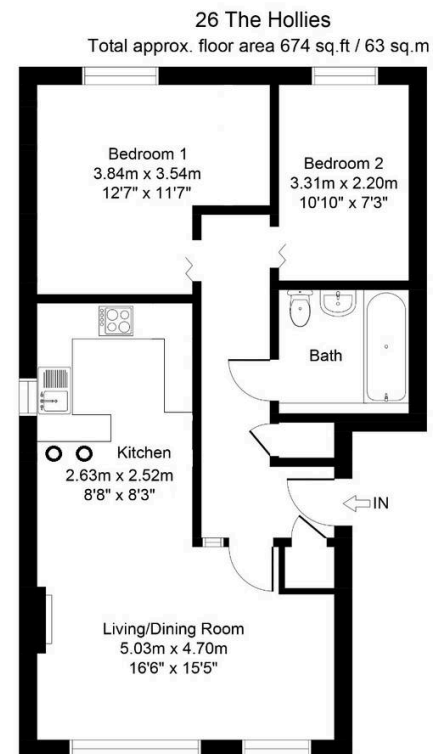

All measurements of walls, doors, windows and fitting and appliances, including their size and location, are shown as standard sizes and therefore cannot be regarded as a representation by the seller.

These particulars are for guidance only. They are prepared and issued in good faith and are intended to give a fair summary of the property. Any description should not be relied on as a statement or representation of fact or that the property, or its services, are in good condition. The photographs show only certain parts of the property at the time they were taken. Any areas, measurements or distance given are approximate only. Any reference to alterations to, or use of, any part of the property is not a statement that any necessary planning, building regulations or other consent has been obtained. These matters must be verified by an intending purchaser. All statements contained in these particulars in relation to the property are made without responsibility of Ashington Page or its clients. Neither Ashington Page (nor any joint agents) nor any of their employees has any authority to make or give any representation or warranty whatsoever in relation to the property



01494 680018
info@ashingtonpage.co.uk
www.AshingtonPage.co.uk

