



Braemar Avenue, Wood Green, N22

£1,750 PCM

2 bedrooms, 1 bathroom, 1 living area, and a dining area (D).

Floor Plan

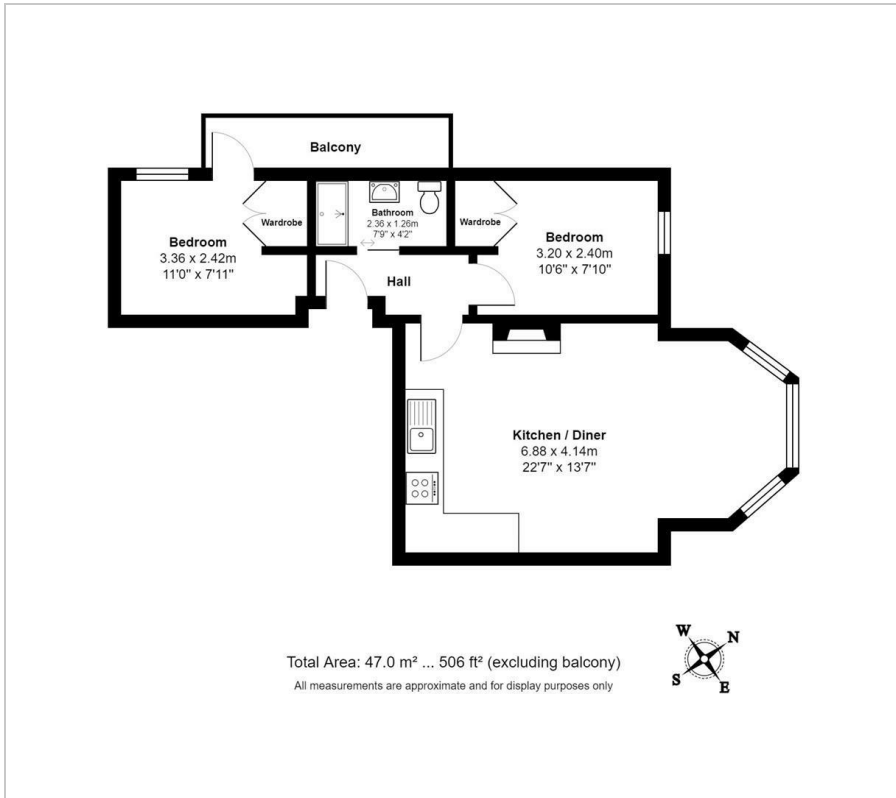

Area Map

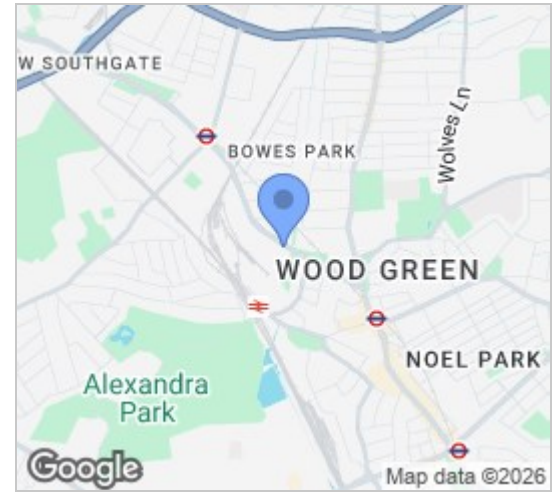

Energy Efficiency Graph

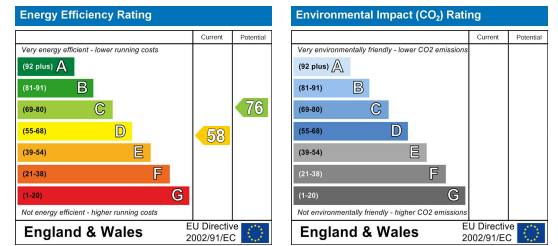

Viewing

Please contact our Homelink Lettings & Estates Office on 0208 882 2112 if you wish to arrange a viewing appointment for this property or require further information.

- Two Bedroom Flat
- Communal Garden
- Fitted Wardrobes
- Set on First Floor
- Fully Fitted Kitchen
- Unfurnished



Homelink are pleased to welcome this lovely two bedroom flat located just off Bounds Green Road between both Wood Green & Bounds Green underground Stations.

The property boasts a spacious lounge/kitchen area, perfect for entertaining guests or simply relaxing after a long day. Both bedrooms have fitted wardrobes, separate tiled shower room with wood flooring, gas central heating and double glazing throughout.

Conveniently situated close to Bounds Green station, commuting to work or exploring the city couldn't be easier. Additionally, the property provides access to a communal garden, allowing residents to enjoy some outdoor space without having to travel far.

Don't miss out on the chance to make this lovely flat your new home. Contact us today to arrange a viewing and envision yourself living in this wonderful property on Braemar Avenue.

Haringey C/Tax Band - A
2026/27 C/Tax - £1,542.52



These particulars, whilst believed to be accurate are set out as a general outline only for guidance and do not constitute any part of an offer or contract. Intending purchasers should not rely on them as statements of representation of fact, but must satisfy themselves by inspection or otherwise as to their accuracy. No person in this firm's employment has the authority to make or give any representation or warranty in respect of the property.

Homelink Lettings and Estates
62 Chase Side, London N14 5PA
0208 882 2112 homelink.co.uk

