



Burghley Road, NW5

£300,000

A ground floor studio flat in a Victorian conversion with a private entrance, a reception room that gets an abundance of natural light, a separate kitchen and a private patio. The property is offered chain free.

Burghley Road is a quiet tree-lined street located close to numerous schools, Hampstead Heath, the shops, cafés and restaurants on Fortess Road and both Tufnell Park and Kentish Town stations.

Features

- Studio Apartment
- Separate Kitchen
- Private Patio
- Period Conversion.
- Good Transport Links
- Chain Free

Burghley Road, London, NW5

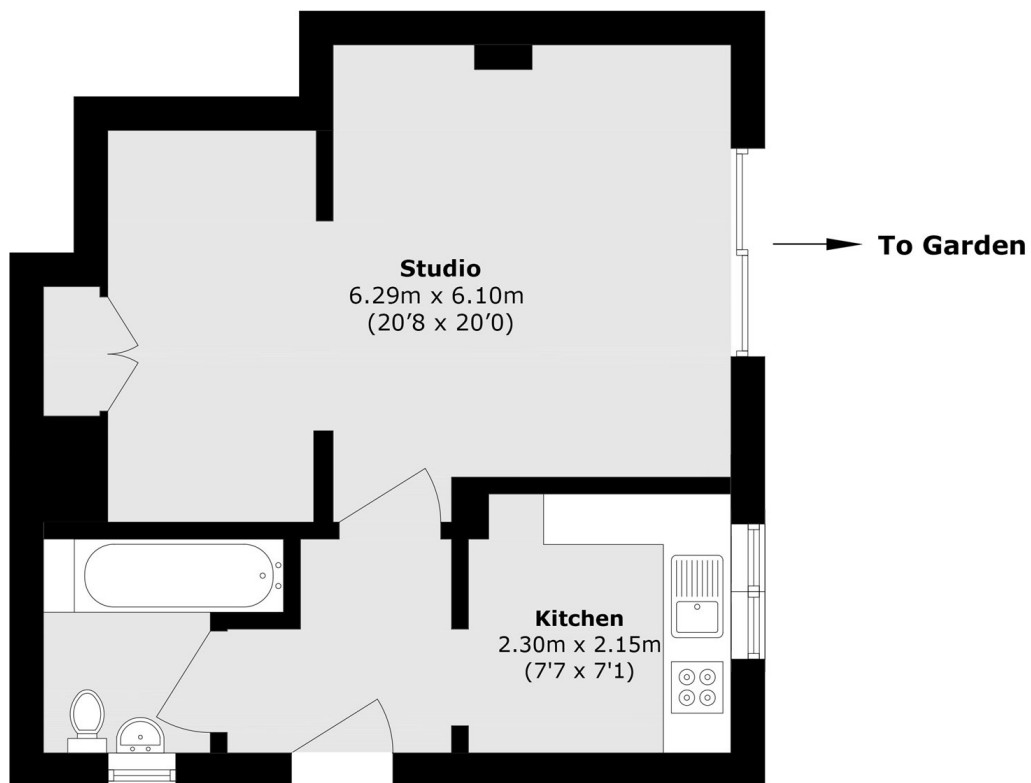

Total area (approx.): 35.0 sq. m (376.7 sq. ft)