



111

Westgate | | Southwell | NG25 0LS

£349,950



Jonathan Fitzpatrick  
VILLAGE & COUNTRY HOMES

# 111

Westgate |  
Southwell | NG25 0LS

£349,950

Occupying a generous plot within easy reach of Southwell's excellent amenities, this attractive 2 double bedroom Victorian semi-detached home blends period character with exciting potential. Offered with no onward chain, the property presents an ideal opportunity for first-time buyers, downsizers or investors seeking a home they can personalise and add value to over time. The accommodation includes two well-proportioned and elegant reception rooms, kitchen (that could be opened into the dining room, subject to usual consents and survey) utility area, sizeable first floor landing, two double bedrooms, an en-suite shower room and a spacious family bathroom. Outside, the property benefits from driveway parking, a useful brick outbuilding with w/c and a surprisingly generous south facing rear garden with patio and lawned areas. With its appealing Victorian façade, practical layout and sought-after location, this is a home offering both immediate comfort and future potential. Our clients are open to sensible offers from buyers in strong, proceedable positions.

- Distinctive and spacious 2 double bedroom Victorian semi detached house
- Large south facing rear garden with outbuilding
- Off road parking
- Kitchen and utility room
- No onward chain
- Two elegant reception rooms with fireplaces
- En suite shower room and family bathroom
- Prime location close to Holy Trinity infant school and many local amenities



## 111 Westgate, Southwell, NG25 0LS

Approximate Gross Internal Area  
1098 sq ft - 102 sq m

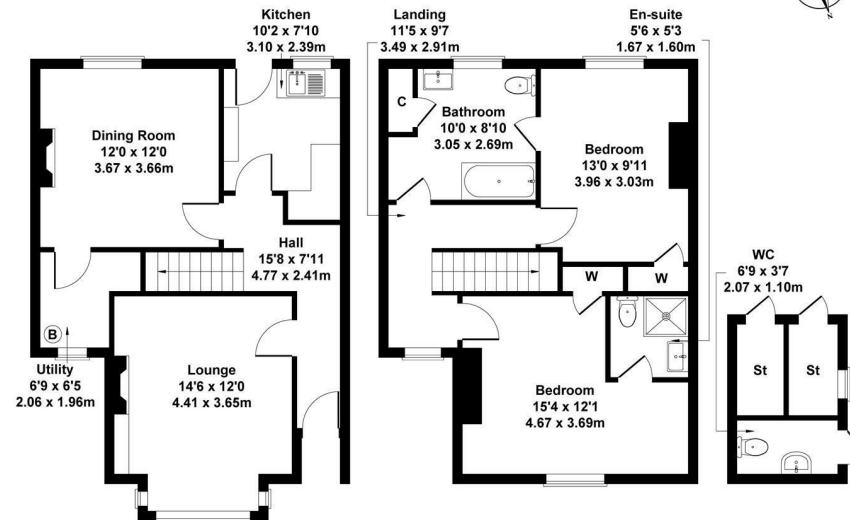

Not to Scale. Produced by The Plan Portal 2026  
For Illustrative Purposes Only.

Energy Efficiency Rating		Current	Potential
Very energy efficient - lower running costs			
(92 plus) A			
(81-91) B			
(69-80) C			78
(55-68) D	61		
(39-54) E			
(21-38) F			
(1-20) G			
Not energy efficient - higher running costs			
England & Wales		EU Directive 2002/91/EC	

64 Main Street  
Farnsfield  
Newark  
NG22 8EF  
01623 392676  
mail@jfea.co.uk  
www.jfea.co.uk