

SIGNATURE

NORTH EAST

OFFICIALLY RATED THE NO.1 ESTATE AGENT IN THE NORTH EAST





📍 Chollerford Avenue, Whitley Bay NE25 8QE

Chollerford Avenue, Whitley Bay NE25 8QE

Asking Price
£370,000

Signature North East are delighted to welcome to the market this well-presented three-bedroom, semi-detached property, ideally located in a prime position in Whitley Bay. This sought-after area is known for its strong community feel, excellent local amenities, and access to the stunning coastline. With a selection of highly regarded schools, shops, cafes, and transport links all within easy reach, this home is perfectly suited to families and professionals alike.

Upon entering the property, you are welcomed into a spacious living room filled with natural light, thanks to a large bay window. The room offers ample space for your chosen furnishings and flows seamlessly into the dining area, creating a fantastic open-plan living space. Both rooms feature attractive exposed brick fireplaces, adding warmth and character. Adjacent to the dining area is a bright conservatory that overlooks the rear garden and offers sliding doors for direct access. The kitchen/diner is generous in size, with plenty of wall and base units and expansive countertop space. The home also benefits from a kitchen extension, a front porch, and internal access to a single garage via the kitchen.

The first floor hosts three well-proportioned bedrooms, each capable of accommodating a double bed along with additional furnishings, offering flexible space for families or those needing a home office or guest room. Completing this level is the family bathroom, featuring a bath, hand basin and W.C.

Externally, the property enjoys a rear garden laid to lawn with a sizeable patio area, ideal for outdoor dining or relaxing in the warmer months. To the front, there is a private driveway with space for two vehicles, in addition to available on-street parking.



PLEASE NOTE THAT THE VENDOR HAS CERTIFIED THE PROPERTY INFORMATION AND IMAGES.

PROPERTY FLOORPLAN

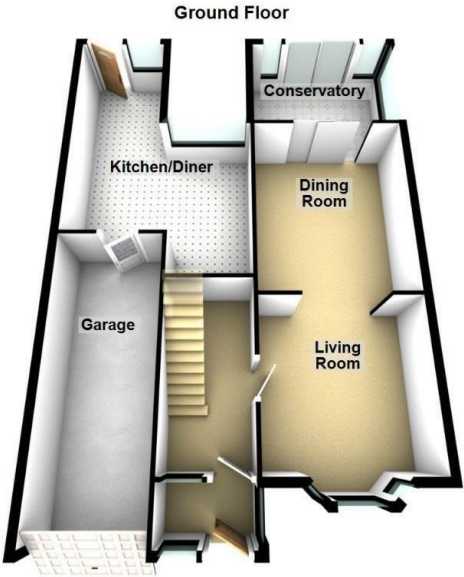

Total area: approx. 133.3 sq. metres (1435.2 sq. feet)

Measurements:

Living Room
12'2" x 11'11"

Dining Room
14'7" x 11'11"

Kitchen/Diner
14'7" x 18'10"

Conservatory
8'1" x 11'11"

Bedroom One
12'4" x 10'0"

Bedroom Two
12'4" x 8'8"

Bedroom Three
9'0" x 7'2"

Bathroom
8'4" x 7'1"

Energy Efficiency Rating		
	Current	Potential
Very energy efficient - lower running costs		
(92 plus) A		
(81-91) B		
(69-80) C	70	77
(55-68) D		
(39-54) E		
(21-38) F		
(1-20) G		
Not energy efficient - higher running costs		
England & Wales		
EU Directive 2002/91/EC		





More 5 Star Customer Reviews than any other Agent based in the North East on allAgents.co.uk



SALES

LETTINGS

FINANCE

LAW

WE COVER THE WHOLE OF THE NORTH EAST

Whitley Bay
0191 251 3344

Cramlington
01670 897 213

Tynemouth
0191 296 6689

Morpeth
01670 513 966

Ponteland
01661 820 082

Wallsend
0191 432 4151

Alnwick
01665 511 800

Heaton
0191 432 4275

Forest Hall
0191 266 9966

Other locations
0191 640 3523

Newcastle
0191 640 2284

Durham
0191 303 8252

Gosforth
0191 640 3523

Sunderland
0191 543 6390

Whickham
0191 432 5102

Gateshead
0191 432 4294

Jesmond
0191 281 1037

Killingworth
0191 640 3602

Ryton
0191 413 9845

Head Office &
Lettings
0191 253 4815

*Highest recommended 5-star reviews than any other Estate Agent based in the North East on allAgents.co.uk - The UK's Largest Customer Review Website for the Property Industry & Awarded Best Estate Agency 2018 & 2019 - North East England by SME News